

LIBEN GROUP CORPORATION

Yangwan Industrial Area, Qiaoxia Town,
325106, Wenzhou, Zhejiang, China

Tel: +86 577 6696 8222

Fax: +86 577 6697 7778

E-mail: info@libenplay.com

www.libentrampoline.com



Liben 

Indoor Amusement Parks

- Indoor Trampoline Parks
- Indoor Ropes Course
- Indoor Playgrounds
- Ninja Course



Please note: All the designs and photos in this catalog are copyrighted by Liben. All copyrights reserved. No reproduction by any means is allowed without acknowledgment.



Our brand-----立本Liben

Liben, our enterprise title, which means "Concerning to the fundamentals" in English, is from The Analects of Confucius, who said "A noble man can always concerns himself with the fundamentals, which will lead him the way (Tao) to success." We firmly believe that in this time of globalization and floods of different ideas, our essential is to "concern to the fundamentals". It is the greatest "Tao" to build our own dreams into the national development and human civilization!

LIBEN GROUP CORPORATION

Play, and the wisdom of play!



COMPANY PROFILE

Liben Group Corporation is located in Qiaoxia town of Wenzhou City, which is well known as "The Capital of Playground Equipment in China". As a private joint-stock enterprise, with total investment of 50 Million USD, we have dedicated to the research, development, manufacture, sales and service of Amusement Park and Playground Equipment since 2011.

Our main products are as following: Indoor Trampoline Park and Indoor Playground series; Outdoor Playground, Swing, Seesaw, Rocking Horse and Climbing Wall series; Outdoor Fitness Equipment and Leisure Chair Series. Our products are widely used in shopping malls, hotels, luxury residential areas, parks, playgrounds, kindergartens, etc. Our products are well received by domestic and foreign customers.

We were the first who have applied the advanced technologies and the automatic machines, such as automatic cutting machines, CNC turret punching technology, welding robots in the production procedure. We have got ISO14001, ISO18000, ISO9001 Certificates, and GS certificate from TUV company of Germany. In 2013, we were recognized and awarded many honorable titles, such as "The Leading Company of Playground & Toys Industry Area in China", "The Key Cultural Enterprise in Zhejiang Province", and "A Caring Enterprise" by Chinese Government.

"Make People Healthy and Happy"---we'll never forget our everlasting enterprise mission. As the pathfinder of China Amusement Toy Industry's integration, transformation and upgrading, Liben Group Corporation is looking forward to the long, firm and win-win cooperation with you.

OUR ADVANTAGES

Top quality, as a result of professionalization!

In the production procedure, we've applied the most advanced automatic production line and ABB robot welding technology co-developed with Beijing Machinery Automation Research Institute, which makes us more professional and guarantees high quality.

Good price, as a result of direct selling!

Our direct selling is our way of marketing. We are going to set up our worldwide sales network, so our clients can get the best price directly from our factory.

High Technology, as a result of innovation!

To encourage innovation, we make constant investment and effort on R&D, integration of our industry, and innovated service system. And our long-term cooperation with key Universities and Institutes in China also ensure our constant innovation and advanced technology.



Advanced Production Line



Key Management Team



R&D, Production and Sales Team



Overseas Sales Team



Domestic Sales Team



R&D Team



Production Team



Chairman

1993-2011

Chairman of Yonglang Group Corporation

2011-now

Chairman of Liben Group Corporation

2005-2015

President of Wenzhou Toy Association for two consecutive terms

Vice president of China Toy, Infant and Child Products Association

The representative of 12th National People's Congress of Wenzhou City

The representative of 15th National People's Congress of Younjia County

Member of the 8th Yongjia County CPPCC

Mission
Make People Healthy and Happy!

Customers Visited



2015 Hongkong IAAPA



2015 RAAPA



116th Canton Fair



117th Canton Fair



2014 Shanghai Toy Show



2014 Wenzhou Toy Show

2015 EAS / FSB



More....



Team Culture



Certificates Of Honor



Categories

Part 1 Advice for Investments 01-07

Part 2 Our Customer's Indoor Projects 08-20

Part 3 Games in Indoor Projects 21-31

Part 4 Production Procedure and Technology 32-41

Part 5 Materials and Parts 42-48

Part 6 Comparisons 49-58

Part 7 Standards and Certificates 59-69

Part 8 FAQs 70-75

Part 9 The Related Accessories 76-84

Part 10 A collection of Trampoline Parks 85-86

Media's Attention



Advice for Investments

Part 1 Profit Analysis

•Income Category

•Ticket Sales

•Ticket sales is an important contribution to profit, and it is a part of income of temporary reservation or purchase.

•Membership Card Income

•Take some domestic gymnasiums and large-scale amusement places as references, with the aim to attract regular customers. It is the most important part of income source overseas.

•Ancillary Products Income

•In an indoor park, you can sell some toys, snacks, coffee and desserts to bring some additional income.

•Course Activity Income

•In the indoor amusement park, you can develop a series of programs to attract more players to participate, like Yoga class, dodgeball game and so on.

•Theme Training Camp Income

•For the indoor amusement park, you can cooperate with various institutions to develop a series of activities, such as local preschool and so on.

•Other Business Income

•In an indoor trampoline park, you can sell trampoline socks and hand wristbands.

Profit Analysis Table of Indoor Play Center

Item	Description	Sum	Explanation(Take a 100sqm site for example)
A one-time upfront investment	Equipment and installation cost	\$11,000	Purchase and Installation of Equipment
	Decoration cost	\$2,000	Decoration
	Upfront Investment	\$13,000	All equipment are well installed and running
Annual Total Expenditure	Annual rent	\$8,400	Assume rent is \$7/sqm/month
	Annual wages	\$14,400	Assume 100sqm/2 staffs, \$350/staff/month
	Annual taxes	\$6,000	Different policy in different countries
	Annual utility bills	\$3,000	Assume \$250/month
	Office supplies cost	\$1,200	Cleaning supplies • Office supplies,etc
	Advertising and Marketing	\$5,000	Online marketing , Advertising , etc
	Annual Total Expenditur	\$38,000	
Annual Total Profit	Regular Tickets Sales	\$7,200	Assume 200 persons/week from Monday to Friday, 300 persons/week on weekends. \$6 for each person.
	Membership Card Income	\$3,600	Assume developing 60 members/month, \$60 for first charge, \$60/20 times
	Product Sale Income	\$500	Peripheral products sales
	Others	\$4,000	Food, activities,etc
	Annual Sales Revenue	\$183,600	Monthly sale \$18100
	Annual Total Profit	\$145,600	Annual Total Profit=Annual Sales Revenue(\$217200)-Annual Total Expenditur(\$2700)
Return on Investment	ROI(1st year)	\$132,600	ROI(1st year)=Annual Sales Revenue(\$217200)-Annual Total Expenditur(\$2700)-upfront investment(\$13000)



Part 2 Marketing Strategy

Marketing Strategy

•Advertisement Marketing

•You can post ads in newspapers and magazines with charge ,or you can choose leaflets by yourself ,and deliver them to people in community , park , kindergarten and amusement park.

•Experiential Marketing

•Free coupons and trial playing experience are good methods.

•Internet Marketing

•Facebook and Twitter are good choices.

•VIP Card Marketing

•Membership card promotion is the best way to attract parents to bring their children to indoor amusement park.

•Activity Marketing

•Holiday promotion, all kinds of activities like Friday Super Sessions ,all kinds of parties and Team Building.

•Cooperative Marketing

•Cooperate with the agencies like local TV show and some universities.

Sales Marketing

•Kindergarten

•Kindergarten is a promising market, parents would like to take their kids to the indoor amusement park.

•Exploit all the playground resources at your regional area

•The regional agent of Liben has the right to distribute playground in the regional area. Many amusement playground and children playground owners are retail investors ,who don't have the fixed product resources. So they can make use of the strategy advantage from Liben to exploit other market resources.

•Communities and Schools

•There are many kids in communities and schools, which can be the source of aimed customers

•Open the playground in bookshops,children's shops and other business places



Part 3 How to build an amusement park

Starting your own indoor playground or trampoline park can be a time consuming process which requires a lot of determination from the entrepreneur. On the way to the opening you might get the feeling that you will not reach the opening day. If you create personal goals and goals for the business before starting the process it will help you to stay motivated.

Not only the process from the start to opening can be a heavy and time consuming process. Important to realize is that owning an indoor playground and trampoline park will not be a 40-hour day job. Most of the time playgrounds are open 7 days a week from 10.00 till 19.00 and Trampoline parks are often open during evenings as well. In the beginning a lot of hours will be handled by the owners themselves.

Next to the many hours you need to invest the project also requires a big commitment from you. In the end you're the face of the organization and the ambassador of your organization. Your enthusiasm needs to motivate your customers and employees to visit and work for you.

Are you ready to realize your dream? Then it's time for the next step!

-Orientation

•We recommend you to take a look at existing playgrounds and trampoline parks to see what commercial opportunities offered to you. Moreover, it's helpful to get a general idea of what a playground or trampoline park looks like according to your wishes. After visiting you can also consult with trade organizations to get facts & figures, references and other informations.

-Competitors

- We advise you to find the answers to the following questions:
 - How many indoor playgrounds and/or trampoline parks are there in your area?
 - How many children live in your area and what does this mean for your target market.
 - What are the experiences of your competitors?
 - What form of attractions do your competitors offer and what could make you unique in comparison to them?

•Location

- Liben can inform you about the requirements of your building and we can discuss together about specifics like accessibility, central location, parking space, environment requirements etc.
- Inspecting different buildings helps you make a good choice, think about appropriate space for your play structure or trampoline park. As for the play structure or trampoline park, you need to take internal infrastructure into account. Your visitors would like to rest, eat, drink there. Please remember, large space often means a bigger play structure and thus a larger investment.

•Research Phase

- There are some important questions below and you may take them into consideration.
- Which locations are suited and what are the requirements for the building?
- The costs to your own play structure?
- What does it mean to work in the recreation sector?
- Which network meetings are there?
- Which certificates/education do you need to open your own playground or trampoline park?
- What is your monthly budget?
- Is there space in your budget to hire staff?
- How do you make sure that your playground stays safe, clean and tidy?
- what attractions would you like to have in your playground?
- What requirements are there to open a catering facility in your playground and/or trampoline park?

•Business Plan

- It is important to create your business plan. Based on the previous research it's time to start your business plan. When you browse different websites, there are lots of websites which can support you with this process. A well written business plan is complete and concrete, but also short and concise.
- Elements of a business plan:
 - The purpose of your company.
 - Current situation of your (future) customers (what is their problem now?)
 - The solution to this problem.
 - Motivation story which explains the reasons of opening your own indoor playground and/or trampoline park.
 - Market research Competitors .
 - the product you' re offering.
 - what business model are you going to use?
 - Are you alone or with a team?
 - Financial situation

•Finances

•Your plans to open your own playground or trampoline park will not be carried out successfully without financing. When you have the possibility to finance the project on your own, the financing will be solved quite fast. Or you can contact and make agreement with other financing parties. Before walking into a bank or engaging into contract you should know how the financing will take place and what possibilities this give you. The bank will discuss which financing options are best for your situation.

•Design

•You' ve come to the stage where your relationship with Liben is getting tighter every day. After you choosing your location we can start designing your play structure. When you' re building a new location or when you' re renovating we can think about the layout together. After we' ve received the drawings of your building and a budget indication, our design department can start designing your playground and/or trampoline park. We will take all your requirements into consideration and we will try to design everything according to your wishes. After several feedback moments we can create your final design and price.

•Ordering & Installing

•You agreed with the final design and you ordered your playground and/or trampoline park. Our production staff will start producing your playground and everything will be prepared to install your playground. Meanwhile, you can the time to order different things like chairs, tables and catering equipment.

•After finalizing the production, your playground will be transported to your site and after delivery our installation team will start the installation of your project if you need. The installation will take some time, this might take days to a couple of weeks, depending on the size of the project.

•Staff

•The opening of the playground is getting closer every day and it all depends on your budget if you' re going to hire staff. When you' re hiring people, make sure that your employees determine the first impression your visitors get. Make sure your staff is well educated and that they are familiar with all the norms and values. Make sure that there is a uniform appearance so your visitors will recognize your staff straight away.

•If you don' t want to be at the playground all the time, you can think about hiring an office manager that will support you with giving your employees the right directions and make sure everything is in order.

2. Management Rules for Trampoline Parks

Safety Rules

1. Always follow the instructions of the staff.
2. Do not jump on the trampoline if you are not wearing your shoes.
3. Do not jump on the trampoline if you are not wearing your shoes.
4. Do not jump on the trampoline if you are not wearing your shoes.
5. Do not jump on the trampoline if you are not wearing your shoes.
6. Do not jump on the trampoline if you are not wearing your shoes.
7. Do not jump on the trampoline if you are not wearing your shoes.
8. Do not jump on the trampoline if you are not wearing your shoes.
9. Do not jump on the trampoline if you are not wearing your shoes.
10. Do not jump on the trampoline if you are not wearing your shoes.

General Rules

1. All new users must first receive a safety briefing.
2. All participants must follow the rules of the park.
3. Participants must wear appropriate clothing and footwear.
4. Participants must not use equipment in a way that is not intended.
5. Participants must not use equipment in a way that is not intended.
6. Participants must not use equipment in a way that is not intended.
7. Participants must not use equipment in a way that is not intended.
8. Participants must not use equipment in a way that is not intended.
9. Participants must not use equipment in a way that is not intended.
10. Participants must not use equipment in a way that is not intended.

The Park Rules

1. Flight Deck: The flight deck is only for use by those who are qualified to use it.
2. Flight Deck: The flight deck is only for use by those who are qualified to use it.
3. Flight Deck: The flight deck is only for use by those who are qualified to use it.
4. Flight Deck: The flight deck is only for use by those who are qualified to use it.
5. Flight Deck: The flight deck is only for use by those who are qualified to use it.
6. Flight Deck: The flight deck is only for use by those who are qualified to use it.
7. Flight Deck: The flight deck is only for use by those who are qualified to use it.
8. Flight Deck: The flight deck is only for use by those who are qualified to use it.
9. Flight Deck: The flight deck is only for use by those who are qualified to use it.
10. Flight Deck: The flight deck is only for use by those who are qualified to use it.

Free Jump Safety Rules

1. Do not jump on the trampoline if you are not wearing your shoes.
2. Do not jump on the trampoline if you are not wearing your shoes.
3. Do not jump on the trampoline if you are not wearing your shoes.
4. Do not jump on the trampoline if you are not wearing your shoes.
5. Do not jump on the trampoline if you are not wearing your shoes.
6. Do not jump on the trampoline if you are not wearing your shoes.
7. Do not jump on the trampoline if you are not wearing your shoes.
8. Do not jump on the trampoline if you are not wearing your shoes.
9. Do not jump on the trampoline if you are not wearing your shoes.
10. Do not jump on the trampoline if you are not wearing your shoes.

Slam Dunk Safety Rules

1. Do not jump on the trampoline if you are not wearing your shoes.
2. Do not jump on the trampoline if you are not wearing your shoes.
3. Do not jump on the trampoline if you are not wearing your shoes.
4. Do not jump on the trampoline if you are not wearing your shoes.
5. Do not jump on the trampoline if you are not wearing your shoes.
6. Do not jump on the trampoline if you are not wearing your shoes.
7. Do not jump on the trampoline if you are not wearing your shoes.
8. Do not jump on the trampoline if you are not wearing your shoes.
9. Do not jump on the trampoline if you are not wearing your shoes.
10. Do not jump on the trampoline if you are not wearing your shoes.

The Soft Wall Safety Rules

1. Do not jump on the trampoline if you are not wearing your shoes.
2. Do not jump on the trampoline if you are not wearing your shoes.
3. Do not jump on the trampoline if you are not wearing your shoes.
4. Do not jump on the trampoline if you are not wearing your shoes.
5. Do not jump on the trampoline if you are not wearing your shoes.
6. Do not jump on the trampoline if you are not wearing your shoes.
7. Do not jump on the trampoline if you are not wearing your shoes.
8. Do not jump on the trampoline if you are not wearing your shoes.
9. Do not jump on the trampoline if you are not wearing your shoes.
10. Do not jump on the trampoline if you are not wearing your shoes.

Olympic Trampoline Safety Rules

1. Do not jump on the trampoline if you are not wearing your shoes.
2. Do not jump on the trampoline if you are not wearing your shoes.
3. Do not jump on the trampoline if you are not wearing your shoes.
4. Do not jump on the trampoline if you are not wearing your shoes.
5. Do not jump on the trampoline if you are not wearing your shoes.
6. Do not jump on the trampoline if you are not wearing your shoes.
7. Do not jump on the trampoline if you are not wearing your shoes.
8. Do not jump on the trampoline if you are not wearing your shoes.
9. Do not jump on the trampoline if you are not wearing your shoes.
10. Do not jump on the trampoline if you are not wearing your shoes.

Foam Pits Safety Rules

1. Do not jump on the trampoline if you are not wearing your shoes.
2. Do not jump on the trampoline if you are not wearing your shoes.
3. Do not jump on the trampoline if you are not wearing your shoes.
4. Do not jump on the trampoline if you are not wearing your shoes.
5. Do not jump on the trampoline if you are not wearing your shoes.
6. Do not jump on the trampoline if you are not wearing your shoes.
7. Do not jump on the trampoline if you are not wearing your shoes.
8. Do not jump on the trampoline if you are not wearing your shoes.
9. Do not jump on the trampoline if you are not wearing your shoes.
10. Do not jump on the trampoline if you are not wearing your shoes.

Airbag Safety Rules

1. Do not jump on the trampoline if you are not wearing your shoes.
2. Do not jump on the trampoline if you are not wearing your shoes.
3. Do not jump on the trampoline if you are not wearing your shoes.
4. Do not jump on the trampoline if you are not wearing your shoes.
5. Do not jump on the trampoline if you are not wearing your shoes.
6. Do not jump on the trampoline if you are not wearing your shoes.
7. Do not jump on the trampoline if you are not wearing your shoes.
8. Do not jump on the trampoline if you are not wearing your shoes.
9. Do not jump on the trampoline if you are not wearing your shoes.
10. Do not jump on the trampoline if you are not wearing your shoes.

Dodgeball Play Rules

1. Start the game with an even number of players and balls per team.
2. There is a maximum of 6 or 8 players per team.
3. A team with a game when they are all of the opposing players out.
4. The referee will be final.
5. You are for free.
6. You are for free.
7. You are for free.
8. You are for free.
9. You are for free.
10. You are for free.

Dodgeball Safety Rules

1. You can only throw the ball.
2. You can only throw the ball.
3. You can only throw the ball.
4. You can only throw the ball.
5. You can only throw the ball.
6. You can only throw the ball.
7. You can only throw the ball.
8. You can only throw the ball.
9. You can only throw the ball.
10. You can only throw the ball.

Part 2 Our Customers' Indoor Projects



TURKEY



Scan to see the video

Northern Cyprus, Turkey
(2015)
Size: 46.3*12.4*3m
Area: 574.12 sqm
Age: 3-12



MALAYSIA



Scan to see the video

Johor, Malaysia
(2015)
Size: 40.7*21.7*5m
Area: 883.19 sqm
Age: 5-50



SOUTH AFRICA



Cape Town, South Africa
(2015)
Size:42*16*5.2m
Area:672 sqm
Age:3-12



LITHUANIA

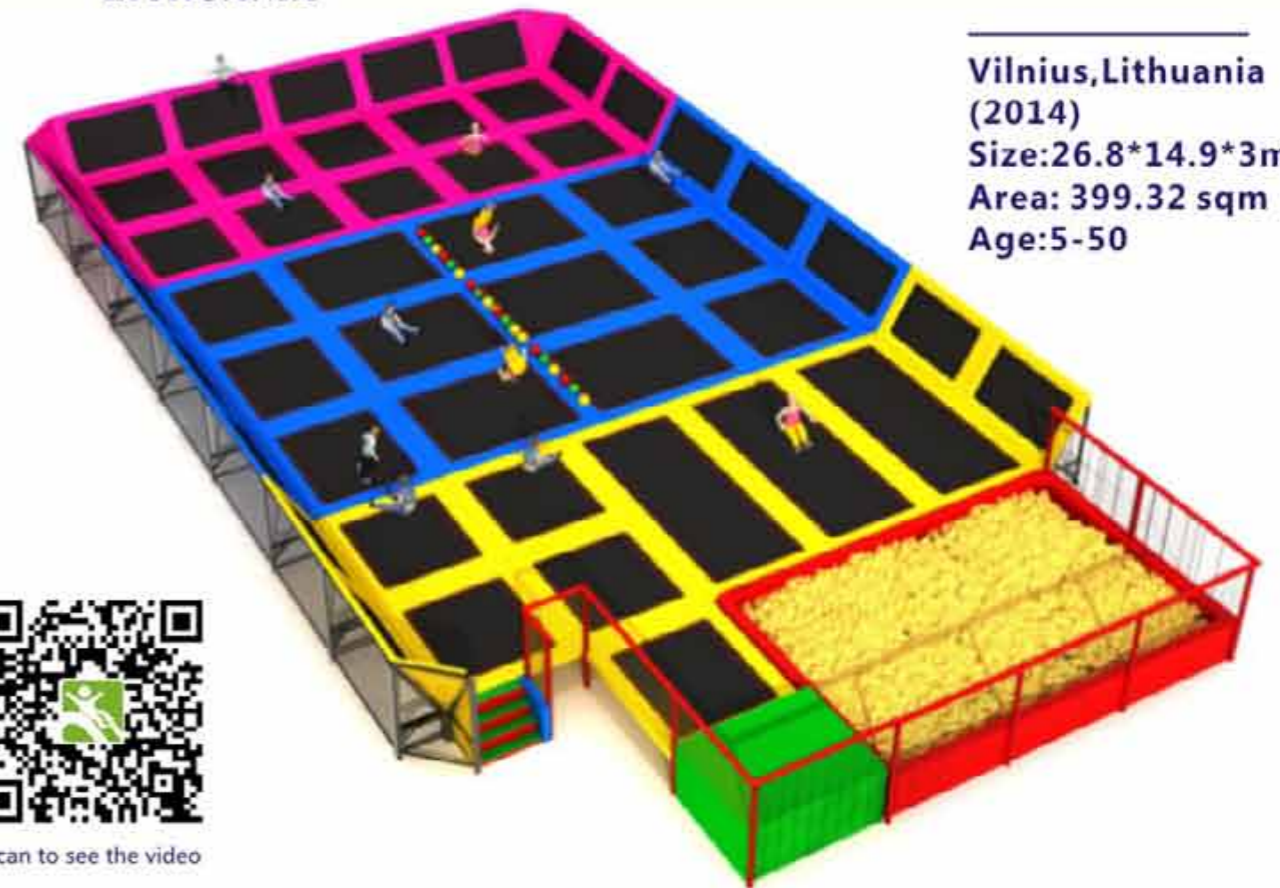

Vilnius, Lithuania
(2014)
Size:26.8*14.9*3m
Area: 399.32 sqm
Age:5-50



Scan to see the video



SWEDEN



Ornskoldsvik, Sweden
(2013)
Size:34.7*23.6*7m
Area:818.92 sqm
Age:3-12



CHINA

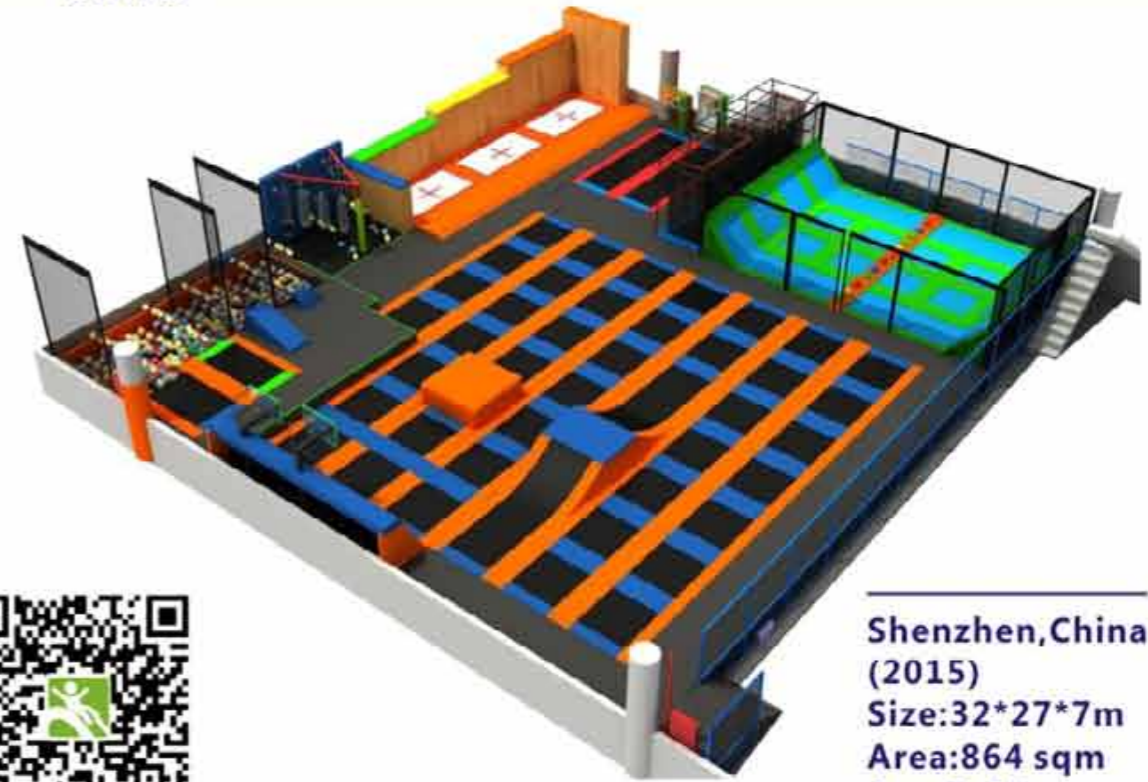

Shenzhen, China
(2015)
Size:32*27*7m
Area:864 sqm
Age:5-50



Scan to see the video



AUSTRALIA

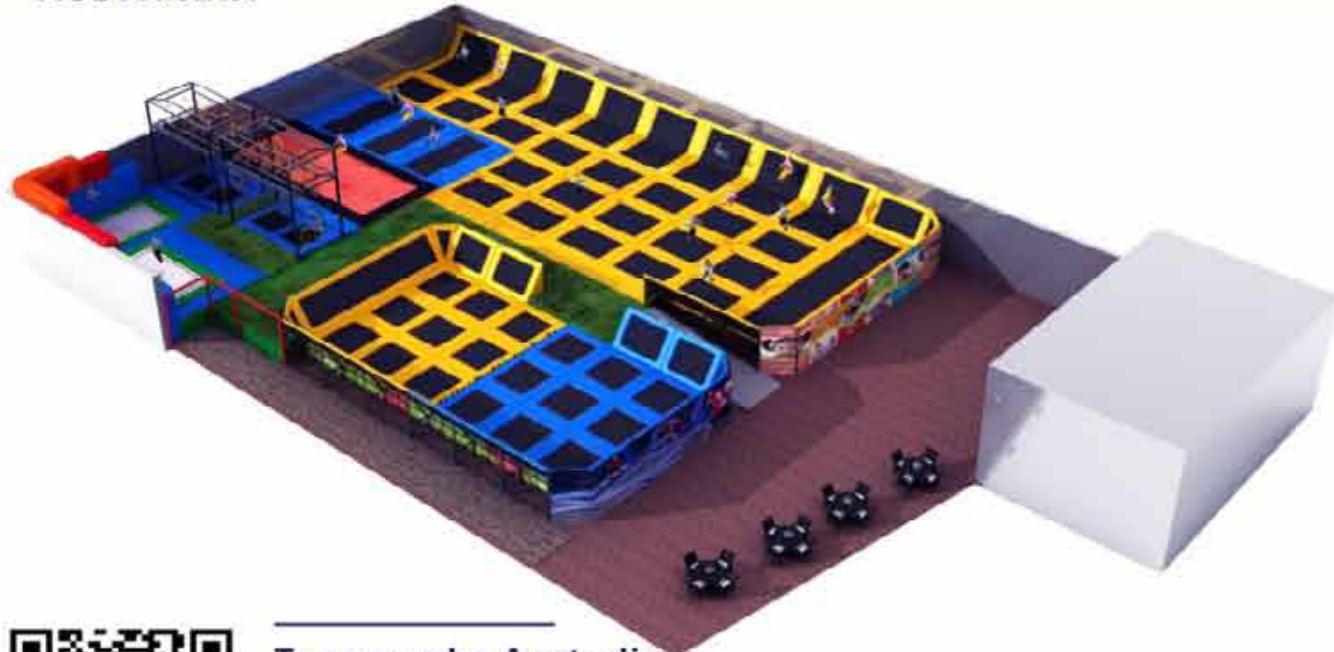

Toowoomba, Australia
(2014)
Size:29*25*4.5m
Area:725sqm
Age:5-50

Scan to see the video



FUZHOU

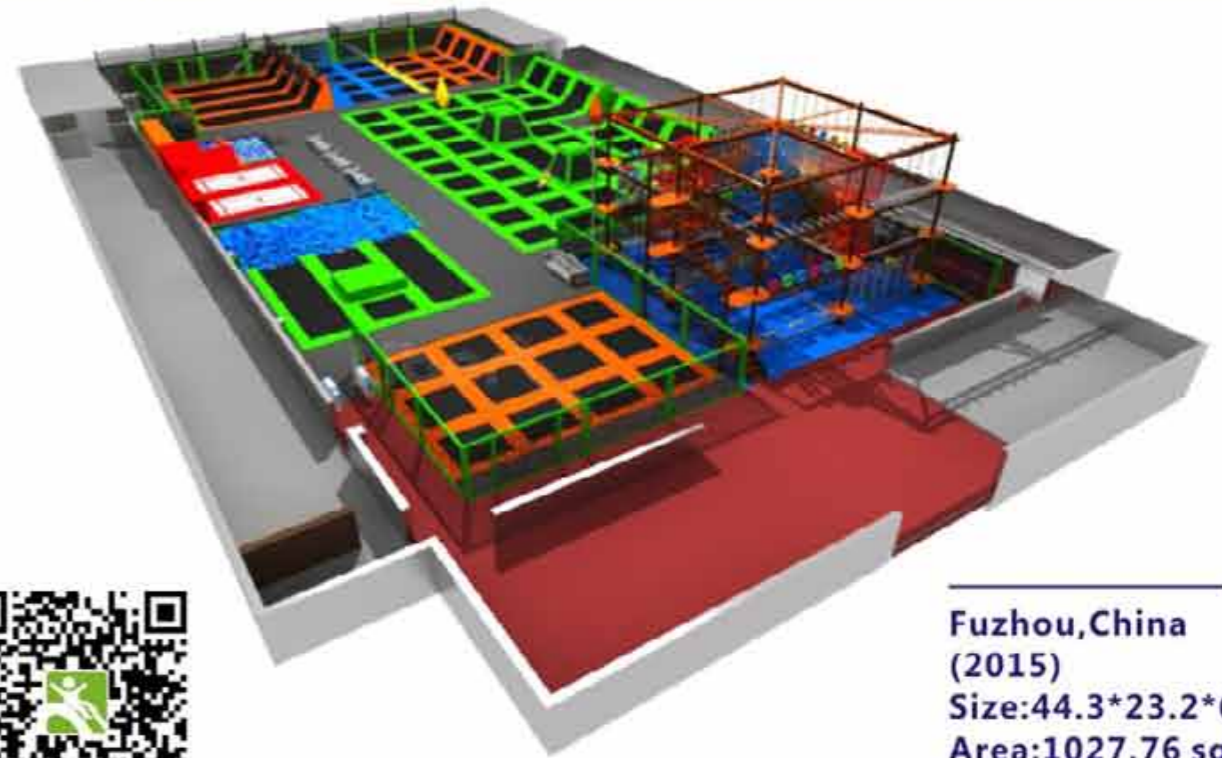

Fuzhou, China
(2015)
Size:44.3*23.2*6m
Area:1027.76 sqm
Age:5-50

Scan to see the video



MEXICO

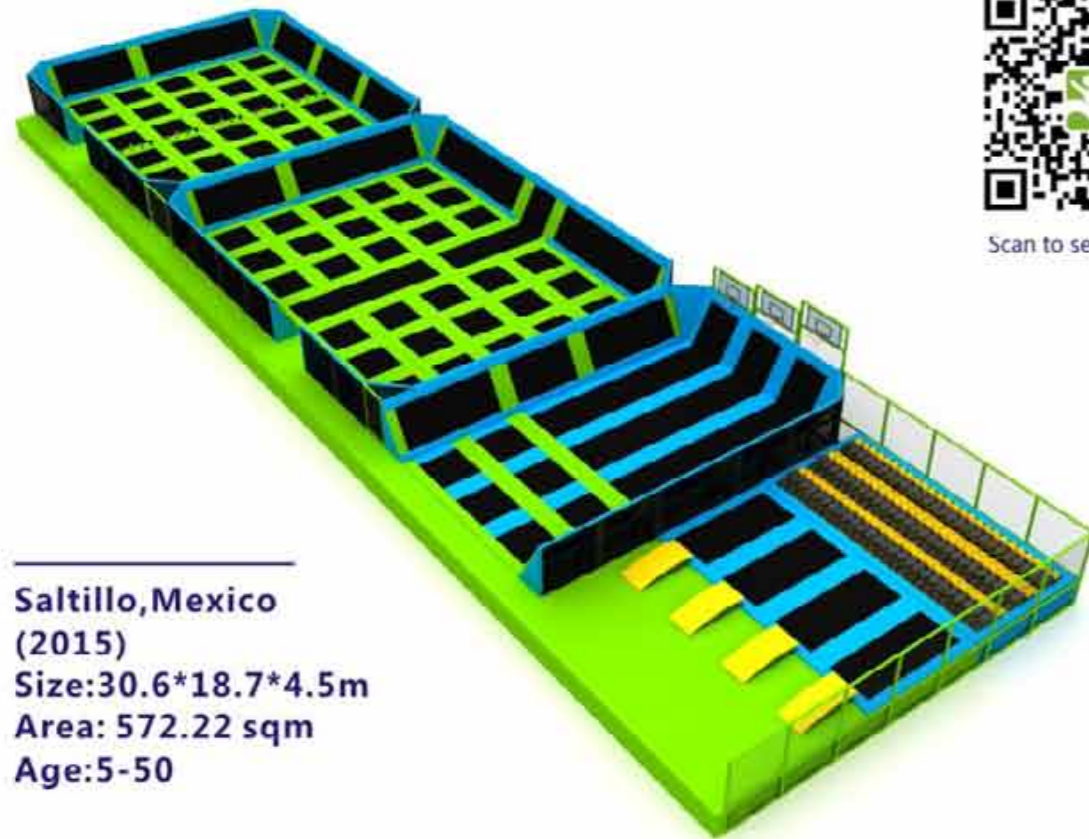

Scan to see the video

**Saltillo, Mexico
(2015)**
Size: 30.6*18.7*4.5m
Area: 572.22 sqm
Age: 5-50

**Queretaro, Mexico
(2015)**
Size: 58.75*14.15*5m
Area: 831.3 sqm
Age: 5-50

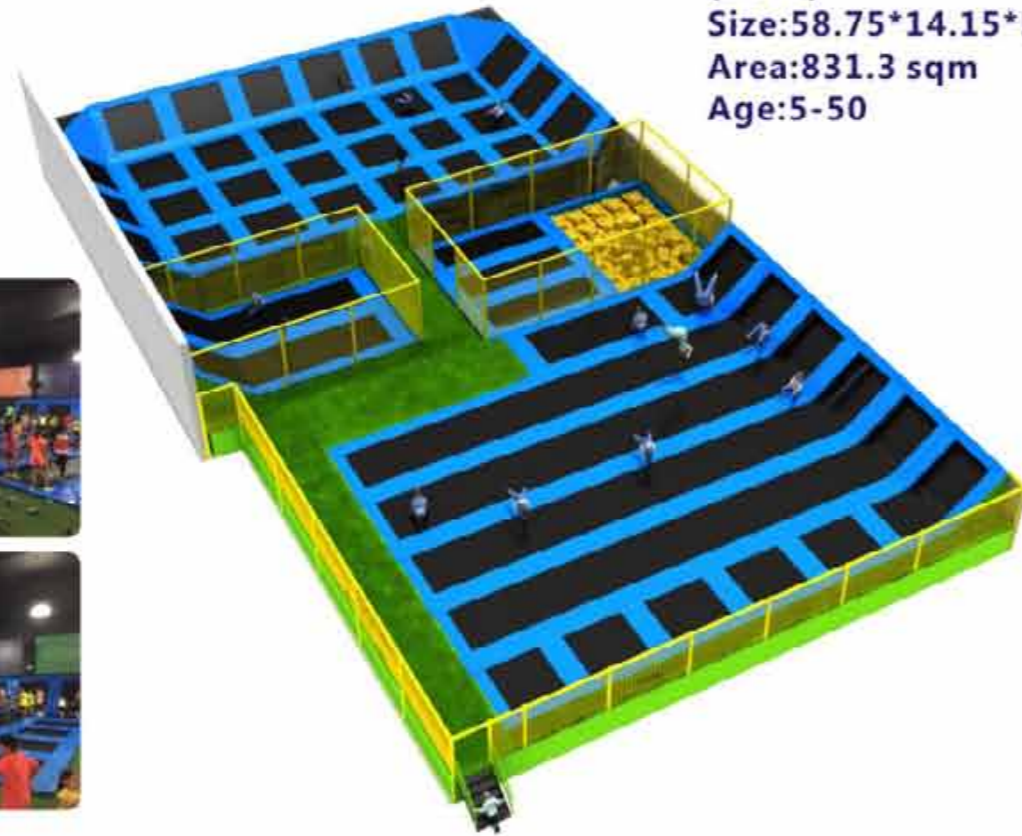

CHILE



**San Antonio, Chile
(2015)**
Size: 12.95*11.2*3m
Area: 145 sqm
Age: 5-50



SINGAPORE

**Singapore
(2015)**
Size: 20*9*2.7m
Area: 180 sqm
Age: 5-50



Scan to see the video





Scan to see the video



**Kedainiai, Lithuania
(2014)**
Size: 10*5*2.8m/5*5*2.6m
Area: 50sqm/25sqm
Age: 3-12



Part 3 Games in Indoor Projects

Games in Trampoline Parks





Free Jump Area

In Free Jump Area, we could provide various trampoline aerobics fitness lesson for people who need to shape body, lose weight, and get relaxed after stressed work. The expert study shows that five minutes jump in trampoline consuming the same calories as people thirty sports in treadmill, so it undoubtedly the best choice for those who want to shape body and lose weight, and also the data shows that jump ten minutes in trampoline consuming same calories as jogging for half an hours, so long-term trampoline sports is good for body's metabolism and reduce the risk of fat.

1



Dodgeball Area

Two teams line up against each other on a field of trampolines with angled trampoline walls to face off with foam balls. The rules are simple: if you hit an opponent with a ball they are out. There can only be one winner! Have fun with the "Air Attack" and the "Bounce, Twist, and Dodge".

2



Spider tower

Spider tower is a recreational game inside indoor playgrounds and indoor trampoline parks, which exercises children's strength. Kids struggle through the elastic threads and reach the top of the tower and then get to the bottom via the exciting typhoon slide after playing the punching bags.

3



Soft Trampoline Wall

Soft Trampoline Walls are typically used together with professional trampoline. You fall down freely from the wall which is four or five meters high, with your back landing on the middle of the trampoline, then rebound in the air, and stand firmly after completing a series of rotational movements; giving another kick on the wall, you land on the trampoline safely and get ready to begin the next cycle of movements. Under the protection of the soft wall and the jumping mat, you could enjoy the fun of defying gravity.

4



Professional trampoline

Professional trampoline, also known as gymnastics trampoline, Olympic trampoline for National Gymnastic Athletes, has better jumping ability. You could achieve a variety of aerial tricks here which are more difficult, as it provides a higher space to play.

5



Foam pit

Jumping, turning over in the air and then falling into the foam pit pool is a cool expression for trampoline athletic people. In addition, there is a rock-climbing area nearby the foam pit pool, it makes people fully enjoy the excitement & simulation from the air to fall into foam pits. At the same time, for some vigorous exercise experts, they can see the valiant & heroic image by instant replay video.

6



Cageball

Trampoline Park New Game: Cageball
Function: Cageball is a place for participants in a one-on-one contest on an enclosed trampoline. It is helpful for building balance, hand-eye coordination, body health and game strategy. And also it satisfies lively nature of children and helps for their emotional stability.

7



Slam Dunk Area

Have you imaged to dunk as a NBA super star? Trampoline slam dunk area will make your dream come true! You can do even more than that! With the help of bouncing force on the trampoline mat, you can easily make the slam dunking. Dunking skills not included! You are just a NBA Super Star!

8



Air bag

Come and experience what it is like to fly through the air and land on a cushion of air. That is what the Big Bag offers. Whether you are an experienced athlete practicing your aerial moves or a first timer trying out a somersault, the Big Bag offers you the ultimate soft landing.

9



Climbing wall area

trampoline climbing wall can build our body softness, coordination and body strength, and the wall is enough to hold a man and climb as they want, the most important is that can cultivate our attention to the things when we keep our eyes on the body when we move and climb, you can enjoy the interested climbing on this area, as you only lying down on the soft foam pit even you fell down from the wall, we will design a separate area for the climbing wall and foam pit, as it is dangerous if we design it near the trampoline mat when the children jump into the foam pit from the mat.

10



Pyramid

Pyramid, with four trapezoid trampoline mats. Players can do various actions by it, like flip, rotation and so on. If the play area is large and the inclined trampolines are far apart, pyramids are just like the inclined trampolines for players flip between them, do many cool actions.



Jumping Box

With the jumping box's speed and elasticity, user can make their whole body fly into the air for 4-5 seconds, and then fall down on the jumping mat or into the foam pit. The jumping box can help user to jump higher and farther, it make the whole action on the jumping mat more smooth, perfect and cool, increase user's experience degrees.

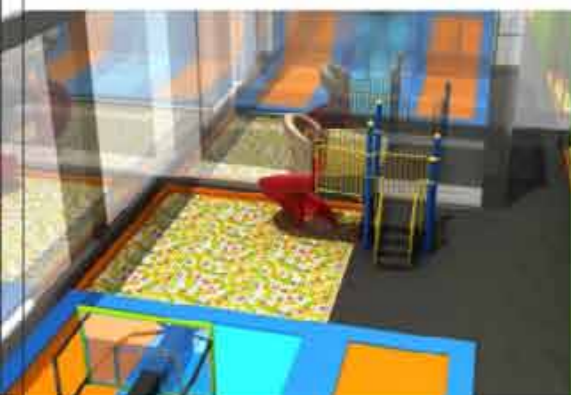

Playground Slide

Playground slide combined with colorful ball pool, a interesting kids area in trampoline park.



Skywalk

Skywalk is one of the most attractive adventure in trampoline parks, which provides you great challenging and thrilling experience high up in the air. A number of different tasks above the trampoline park will not only enable you to challenge yourselves with a lot of fun but also it will be a great workout for you and your friends. You will definitely desire to do it again and again.



Ninja Course

The concept is from American Ninja Warrior which has become an entire sport. Ninja Courses are designed to incorporate running, jumping, vaulting, climbing, and balance to create a fun adventure while providing an amazing workout. Obstacle races are the latest trend hitting the fitness industry and our courses offer individuals a way to prepare for these types of events.

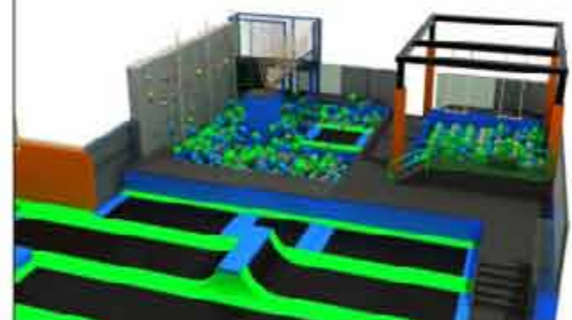

Customize Your Own Foampit

Foampit area can be customized according to customer's idea, as you think it, we will make it after testing, customized foampit makes your trampoline park more competitive.



Bumper Ball

There are two types of bumper balls. One for kids and one for adults. And there is a number of ways to play with it. You can play alone or with many other people. You can roll over on the ground, or collide with each other. It is a flexible and entertaining product that helps you build your body.

NINJA COURSE

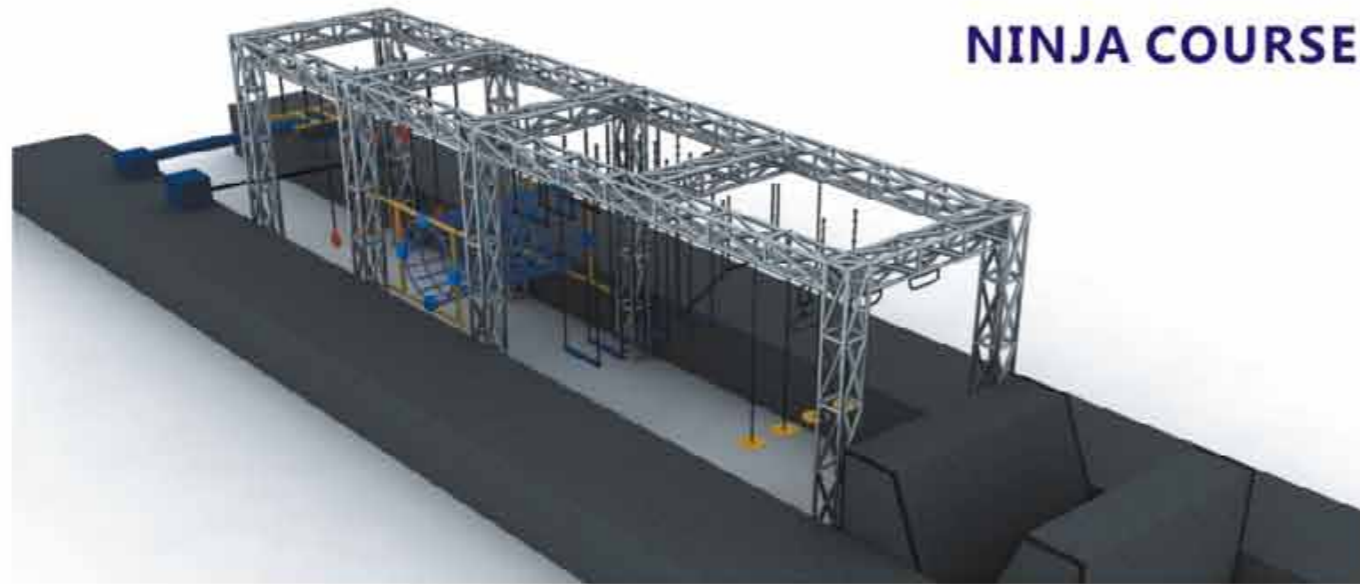

cargo net

Coordination/hand



Floating Bridges(feet)

lower body



floating doors

core strength



sea of swings

Coordination/hand



Floating Bridges(hand)

upper body/hand



ring slider

upper body/hand



sea of rings feet

lower body



sea of rings hand

upper body/hand

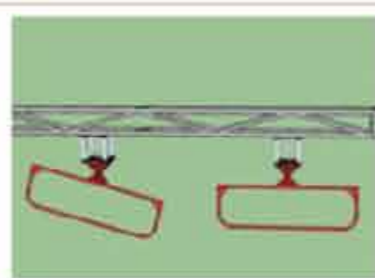

Tilting frame

upper body/hand



Tilting ladder

upper body/hand



angled steps

Coordination/hand



salmon ladder

upper body/hand/core strength

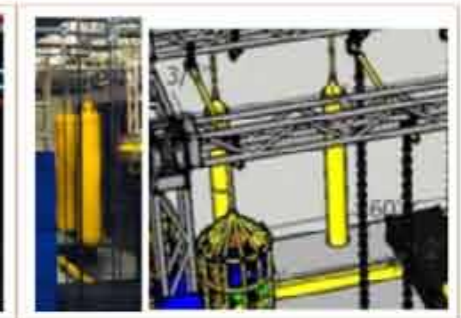

balance beam with punching bag

Coordination/hand



monkey bar

upper body/hand



spider wall

Coordination/core strength

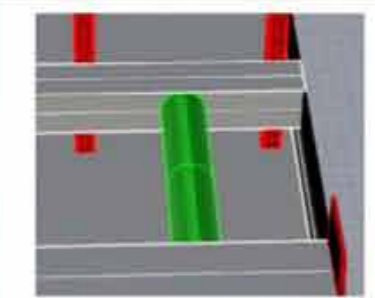

rotating bridge

Coordination

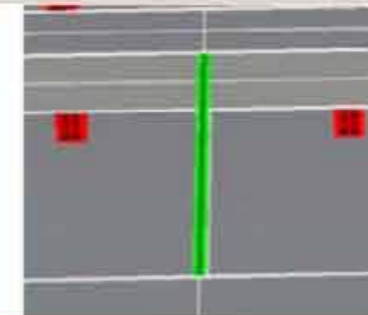

slack line

Coordination



TriLevel Warped Wall

speed/Coordination/hand



Devil Steps

upper body/hand



cargo tube ne

Coordination



suspended ladder

upper body/hand



Quintuple Steps

speed/Coordination

Games in Indoor Playground Equipment



1. Main Area



2. Electric Equipment Area



3. Sand Pit Area



4. Challenge Game Area



5. Role Play Area



6. Trampoline Area



7. CS Area



8. Colorful Mesh Pot



9. Handcraft & DIY Area



10. Family Fun Area



11. Interaction Game Area



12. Bumper Cars

Games in Indoor Ropes Course

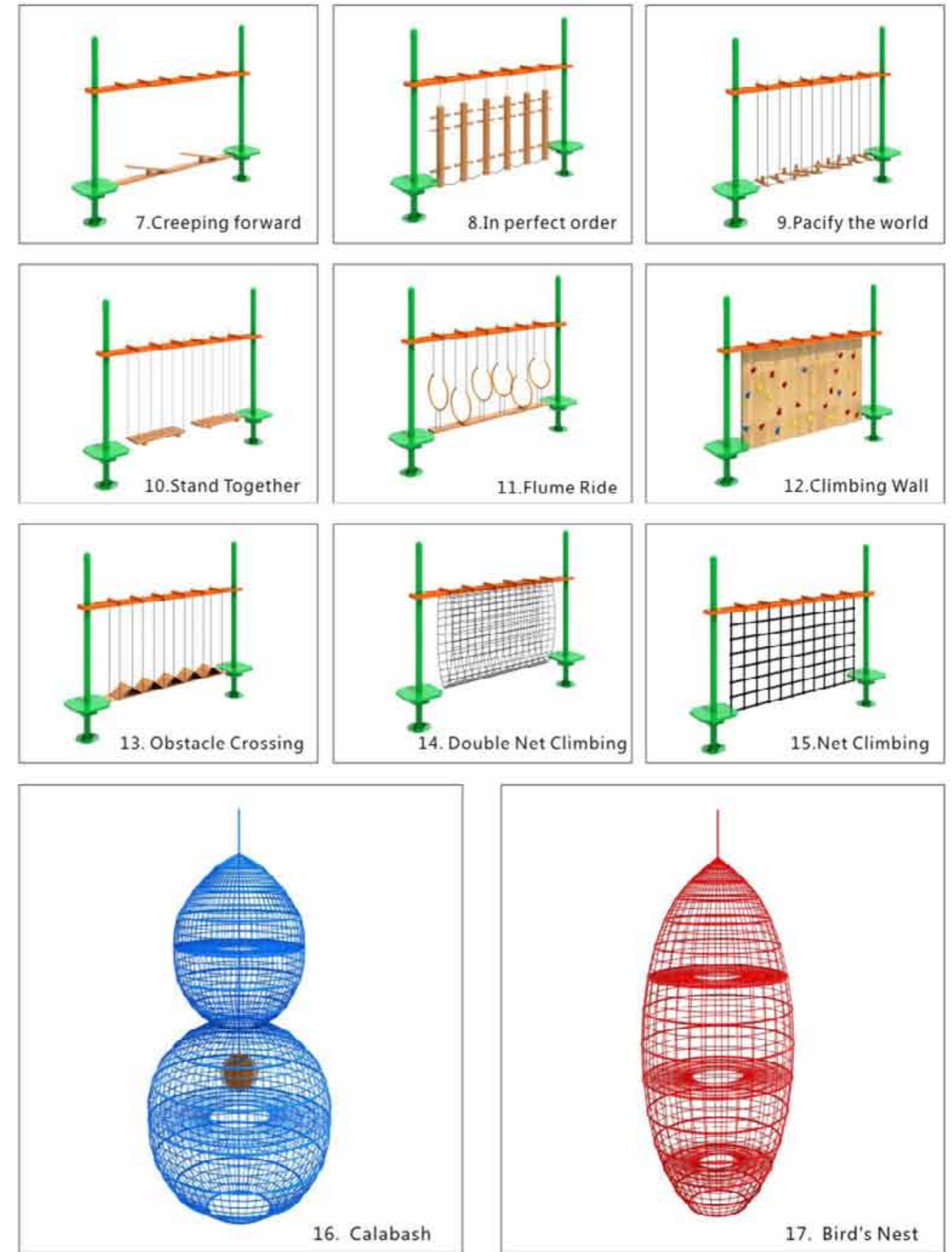
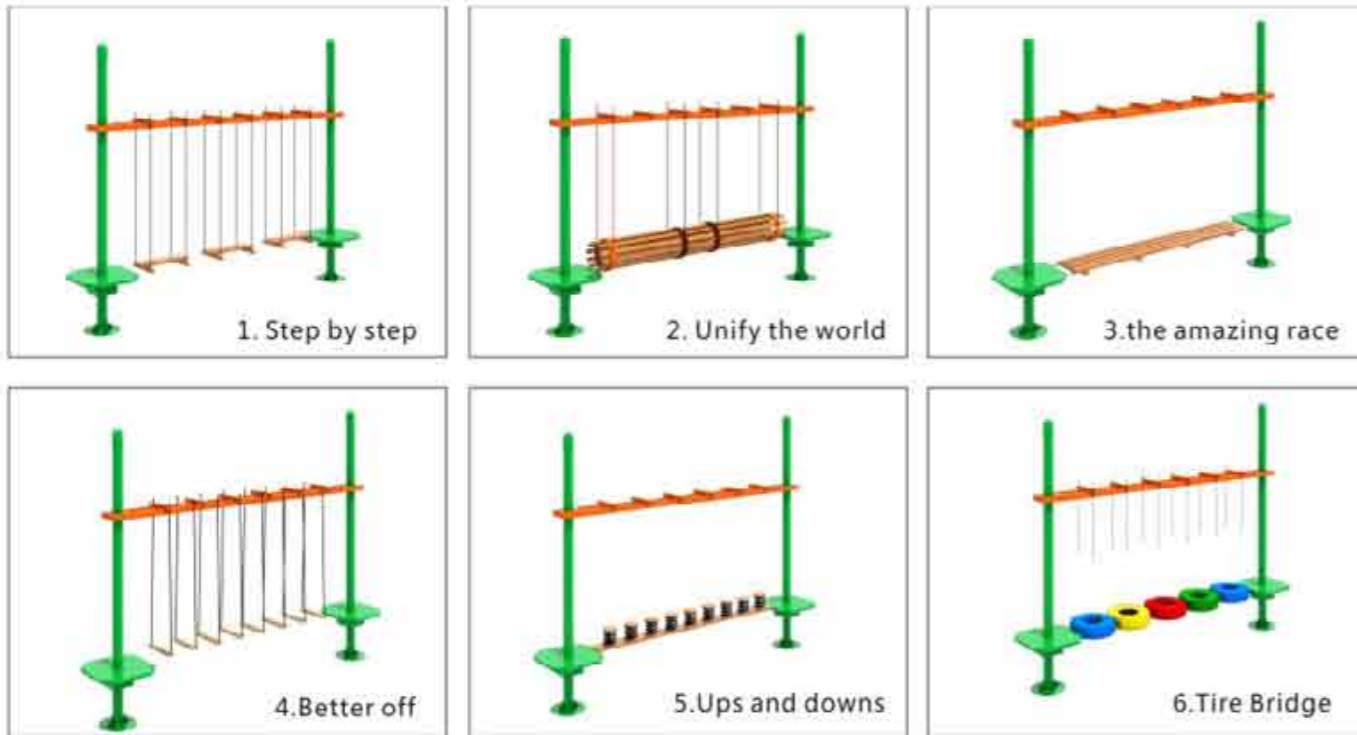

Part 4 Production Procedure and Technology

Trampoline production process

Metal Parts



Soft paddings



Soft wall



Trampoline mat



Accessories standard workshop and pre-installation



Fiberglass slide production process

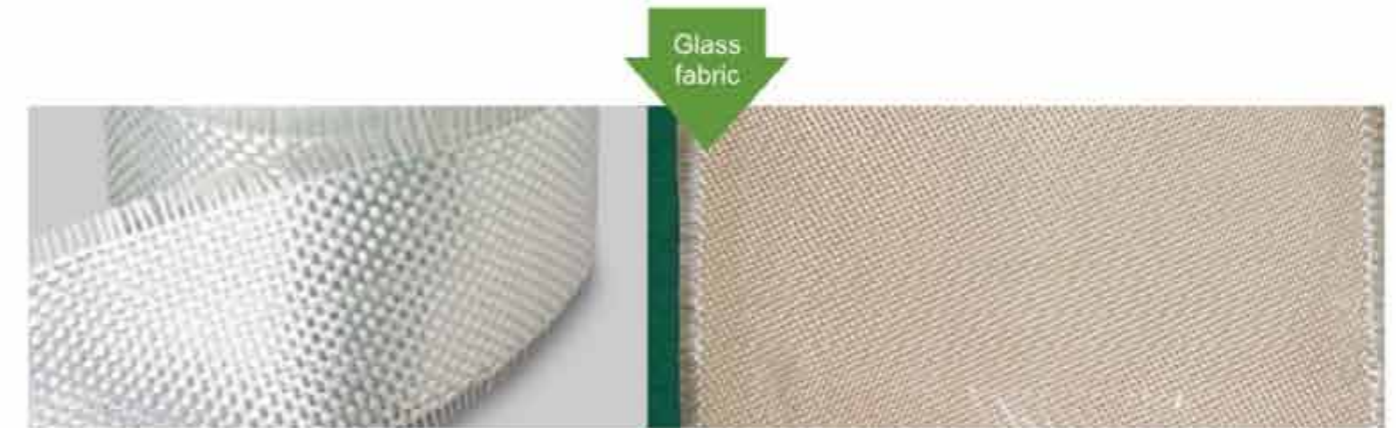

Production process of Indoor Ropes Course from Liben Steel Sheet Parts



1. Punching



2. Bending



3. Polishing



4. Ready for color powder coating

Plastic Parts



Raw material



Color powder blending



1. Pouring into mould



2. Fastening mould



3. Loading into Oven



4. Demoulding



5. Deburring



6. QC&Storage

Wooden Parts



Raw material: Rose wood



Material Ready



Rope Parts



Terylene or nylon



Diamond mesh type



Honeycomb mesh type



Square mesh type

Globose mesh type

Part 5 Materials and Parts

Trampoline Parks

Metal Parts

Material: Steel pipes



Jumping Beds

Standard jumping bed:

- 1). Made of PP
- 2). 1760*1760mm
(length is changable)



Gymnastic jumping bed:

- 1). Made of Poly-amide
yarns
- 2). 4260*2130mm



Soft Padding



Foam Blocks

Foam blocks: 150*150*150mm, made from PU



Indoor Playground Equipment

Pipes

- 1) Material: Galvanized pipe
- 2) Thickness: 1.5mm



Basketball Hoop

- 1. Size: 1.8*1.05*0.05m
- 2. Material: Superior tempered glass



Safety Net

Net Material: PET



Soft Play

PVC thickness: 0.45mm



Plywood

Thickness: 1.8cm, 1.00cm



Spring

Spring for Standard jumping bed



EPE & Sponge

EPE: 2-4cm thick for different games;
Sponge: 2mm thick, density: 35



Gymnastic jumping bed



Plastic Parts & Fiberglass Parts



PVC Foam Pipes & PP ties



Safety Netting



PP ribbon

Catchers

Steel Catchers



Indoor Ropes Course

Steel-framed Structure

Upright Posts:
Galvanised Steel Pipes,
Ø140mm, thickness 4mm;



Pipe Bottom Plate

Plastic pipe plates are used to protect the safety flooring and make the whole playground more stable.



Gliding Route Pipe:
Galvanised Stee Pipes,
thickness: 3.5mm;



Net Games:

Olyamide fibre, dia: 1cm
Weight bearing: 300KGS



Decks: steel sheet 80*80cm



Steel wire rope

Wooden Games

Pinus Sylvestris, thickness 4cm;
Weight bearing: 400KGS



Assistive Components



Part 6 Comparisons

Our Advantages

Quality: Our products are meeting and geared to international safety standards, which would reduce many potential issues to open an indoor play park.

Experience: We have assisted customers from over 39 countries to build their play centers, so that we have accumulated rich project experience and market information.

R&D: Up-to-date innovation and constant improvements with the aim to provide the best solution for each customer to run a successful business.

Service: We offer hearty one-stop service and guaranteed after-sales service. You could always get an answer or solution if any problem occurs.

1 Advantages of indoor trampoline

1.surface Treating:

Liben:

Steel pipes are sand blasted before heated powder coating treatment.

We use Dutch Akzo Nobel powder which has stronger adhesive force and is more durable.



Others:

They omit sandblasting process to reduce the costs and the sprayed paint would be easy to peel off after a period of time.



2. Spring Hooks:

Liben:

Our latest spring hooks are altered to shorter distances to meet different spring quantity needs so as to satisfy varied functions.

In case any spring hook breaks, the other hooks will stay firm and you could install the spring from the broken hook to the other one nearby.



Others:

Their hooks are 4mm-6mm thick with longer distances. You can not find any replacement spring hooks if one part is broken.



3.Weight Test

We have done the weight bearing test for the trampoline mat and springs.

During testing, we put 500kgs heavy stuff for 1 month on one 2.35m*2.35m mat.

The mat didn't tear apart or the springs deformation is within normal standard.



4.Soft Padding

Liben:

We are the first and the only Chinese trampoline manufacturer who use XPE as padding material.

3cm XPE is durable with soft and firm touch feeling when you land on it, which is not easy to loose shape and could be long lasting.

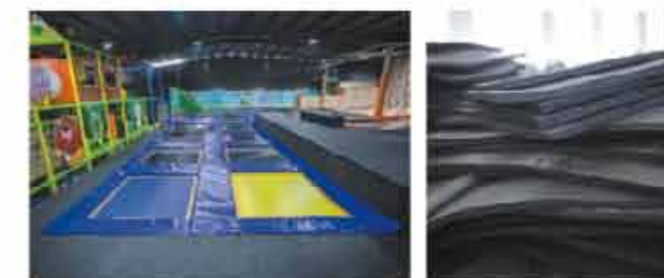

Others:

All the other suppliers in China use EPE or sponge as padding material.

EPE is very hard to land on and it's easy to get deformed and hard recover the shape. Sponge is too soft so the players could feel the steel frame of the trampoline when they jump on the paddings.



5. Structure

We do a lot of improvements on the frame structures.

Advantages: Simpler installation structures that help save costs and time than other suppliers



Stiffeners that connected to the main frame structures make the equipment hold stronger



6. Accessory for free

We will provide 3% extra accessories for free, including screws, trampoline mats, springs, etc.



2 Advantage of indoor playground

Liben:

Safe gap distance that prevents kids from getting stuck;
Thick EPE covers all the trim corners of wooden board;
Smooth wooden board with no burrs



Others:

Unsafe gap distance
Thin EPE cover the trim corners of wooden board;
Rough wooden board with burrs

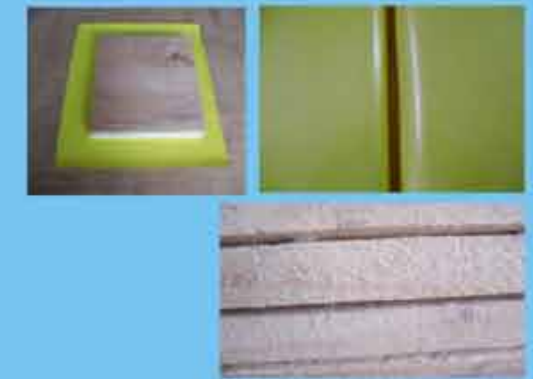

Liben:

Offering footplates that help the equipment steady;
All pipes cut into standard sizes



Others:

No footplates
Uncut pipes that make the installation complicated



Liben



Others



VS

VS

VS

VS

VS

3. Advantages of Indoor Ropes Course

Liben :
We use chestnut tree as the material of this wooden game. It is very hard and strong among all the wooden materials which could be break a steel sheet.



Liben:
We use metal chains to connect the two metal frames. It is firm enough to keep definite security.



Liben:
Our deck is made of steel sheets with heated color powder coating for which we could customize the color and pattern. Moreover, it is firmer and more durable than wooden platforms.



Others:
Most suppliers make platforms from woods. It is easier to be broken, and only able to be made in one color.



Liben:
Offering specific installation guides in the form of photos, videos and installation manuals;
Sending professional installation team to help if needed.



Others:
Unclear installation manuals with only few CAD drawings



Liben:
 We have rubber protector inside the rope ring to protect the safety string from friction and fracture. The 12mm thick string has been done weight bearing test with 1.4 tons items, proven to be strong enough.



Others:
 Most suppliers never make the gravity test. The bad quality and simple sealed safety strings are easier to break.



Liben:
 Our main slide girders are made of galvanized steel pipes which is color powder coated with heat. It is not easy to come off or lose varnish.



Others:
 Other suppliers' slide girders are made of aluminium which are not as strong as galvanized steel pipes. Also, they paint the surface instead of heat coating to reduce costs, so that the coating is easy to wear off during use. What's more, their welded parts are not fully covered with coating that are more likely to get rust.



Liben:
 We cut the main upright pipes and use 8cm diameter flange plates with stainless screws to connect the platforms. It is easy to transport and install, and the structure is very firm.



Others:
 They use single long posts to go across platforms. It may bring many troubles to transport and install.



Liben

Others



VS



VS



VS



Professionalism:

- *We can make designs according to customers' site size.
- *We will provide CAD drawings for installation, which will make installation easier.
- *We can send professional installation engineers for on-site installation all over the world.

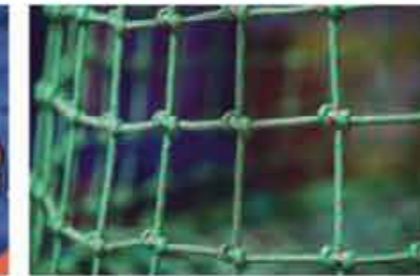
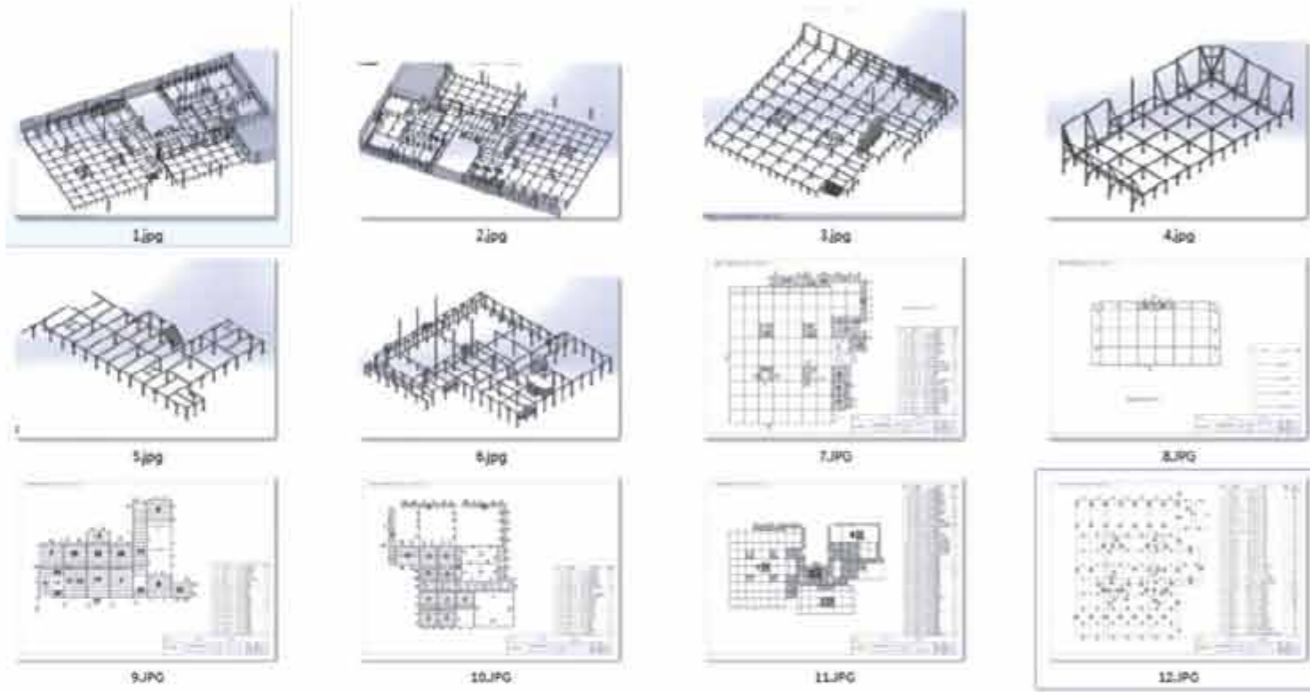

Part 7 Standards and Certificates

Certificates



PVC test report



PVC test report



PVC test report



ASTM test report



CE certificate



Spring test report



Galvanized steel pipe test report



Anti-fire foam cubes test report



Anti-fire foam cubes test report



Anti-fire foam cubes test report



Anti-fire foam cubes test report



Basketball board test report



Jumping mat test report



Jumping mat test report



Jumping mat test report



Jumping mat test report



Common foam cubes test report



Common foam cubes test report



Akzo color powder test report



Akzo color powder test report



Netting test report

Trampoline Standards

Factory Standard

一、SOFT PAD, SOFT WALL

Color of soft pad : Max 3 colors in one big trampoline and divided by area but not available if mixed.

NO.	Color Pic.	Color Name	Liben Item	(RAL No.) K7	Remark
1		Red	LBB001	RAL3020	
2		Yellow	LBB002	RAL1021	
3		Sky Blue	LBB003	RAL5005	
4		Apple Green	LBB004	RAL6018	
5		Orange	LBS008	RAL2000	

二、Trampoline Mat

Color: Black Only for normal trampoline mat and white only for Olympic trampoline

No.	Name	Color	Standard size for Trampoline Mat	Play area size	Frame size	Remark
1	Normal Trampoline	black	1760*1760	1690*1690	2350*2350	Length double 2350, for example: 2350*2-590=4110, non-standard size need application to design and produce.
2	Olympic trampoline	white	2130*4260	1920*4050	2970*5100	testing

Play Area Size(Fox example)

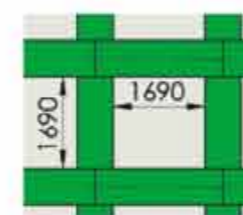

Frame Size (For example)

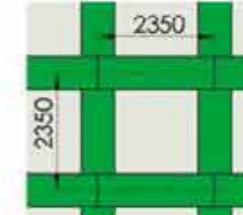

ASTM standard

Liben is on a mission to "Let children grow more healthily and happily" and further develop trampoline park. Happiness and health must depend on the safety equipment. We pay attention to every detail on safety.

We produce trampoline with US ASTM F1487(public playground equipment) ASTM F381(trampoline) standard and European standard EN1176 and have each indicator in production after repeated testing.

We strictly produce according to each quality indicator and have professional testing equipment to ensure all products to meet the standard.

We provide customers with comprehensive services and detailed security maintenance.

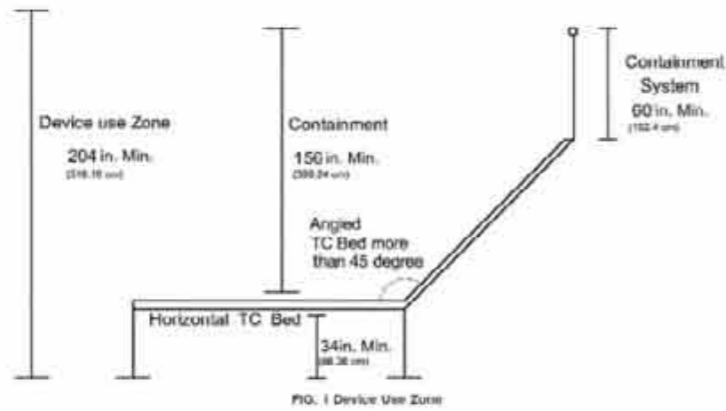

Device use zone shall comprise the area from the ground surface underneath the TC beds to 204 in. (518.16 cm) above the ground surface. The height of ground surface to TC bed will be at least 34 in. (86.36 cm). The perimeter containment system shall be a minimum of 156 in. (396.24 cm) vertical height from the horizontal trampoline frame. The minimum height of a containment wall above an angled TC trampoline frame with a slope of 45 degrees or more from the horizontal trampoline base frame shall be 60 in. (152.4 cm) vertical height.

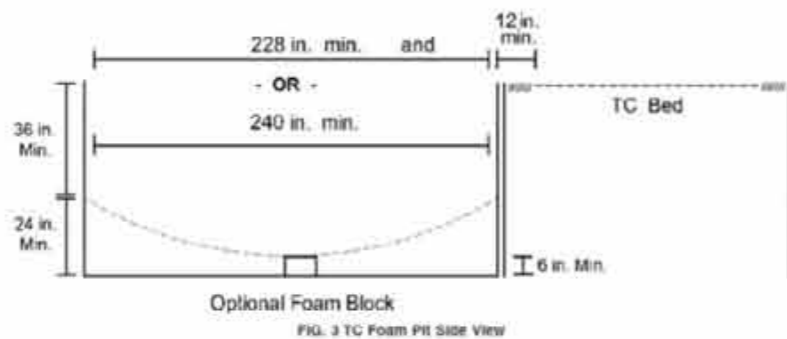

Length—At least 228 in. (579.12 cm) in length from the leading edge of the TC frame prior to the addition of impact attenuation material and 12 in. (30.48 cm) from the leading edge of the trampoline bed at rest, or at least 240 in. (609.6 cm) in length from the leading edge of the TC frame prior to the addition of impact attenuation material. **Depth**—At least 60 in. (152.4 cm) from the floor of the pit to the top of the TC frame prior to the addition of impact attenuation material. **TC Bed Mount**—The mounting device shall be positioned at least 24 in. (60.96 cm) above the TC foam pit floor and at least 36 in. (91.44 cm) below the top of the TC frame. **Bed Sag**—When the TC foam pit is filled with impact absorbing blocks and at rest, the TC bed incorporated into the design must be at least 6 in. (15.24 cm) above the foam pit floor at the lowest point.

Liben values
Teamwork

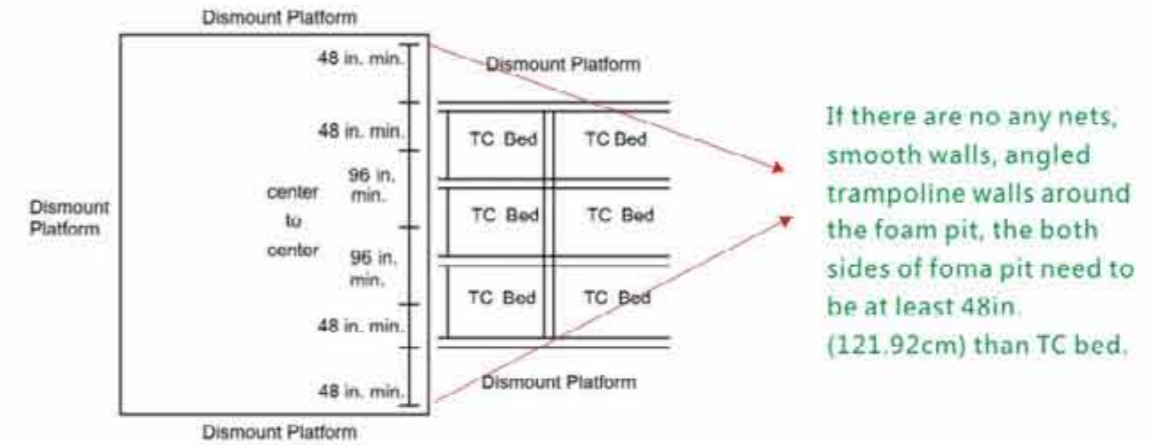

If there are no any nets, smooth walls, angled trampoline walls around the foam pit, the both sides of foma pit need to be at least 48in. (121.92cm) than TC bed.

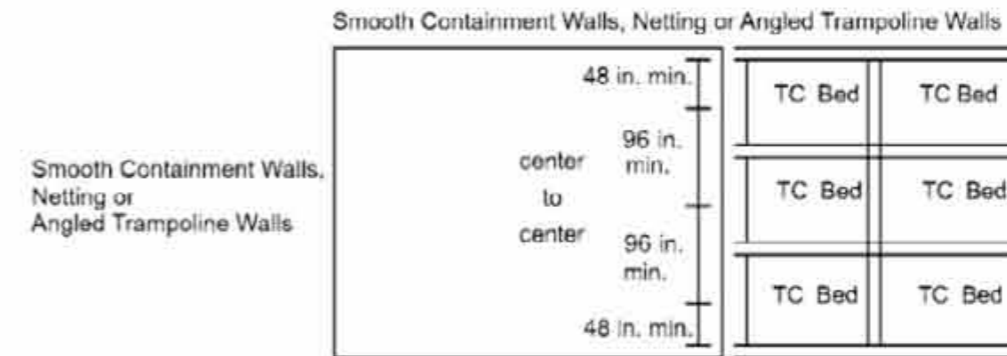
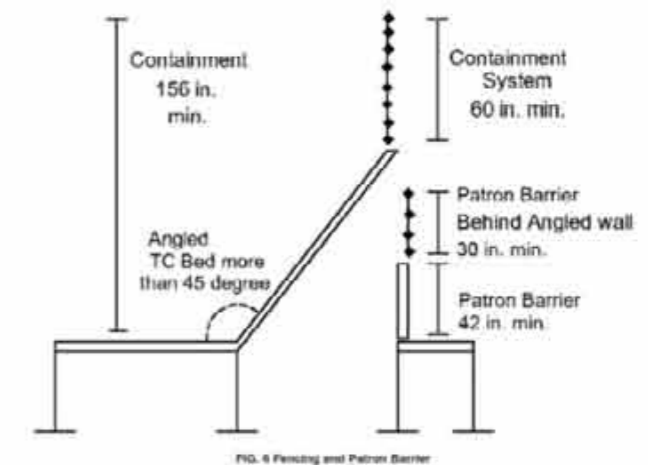

FIG. 5 Example TC Foam Pit Overview With Smooth Containment Walls, Netting or Angled Trampoline Walls

If the foam pit is surrounded by any smooth containment walls, netting or angled trampoline walls, the width of the foam pit will be same as the TC bed.

The perimeter containment system shall be a minimum of 156 in. (396.24 cm) vertical height from the horizontal trampoline frame. The minimum height of a containment wall above an angled TC trampoline frame with a slope of 45 degrees or more from the horizontal trampoline base frame shall be 60 in. (152.4 cm) vertical height. The height of vertical trampoline is or more than 42 in. (106.68cm), it need to set at least 30 in. (76.2cm) height patron barrier. The total height is at least 72 in. (182.88cm)



Certificates and Test Report

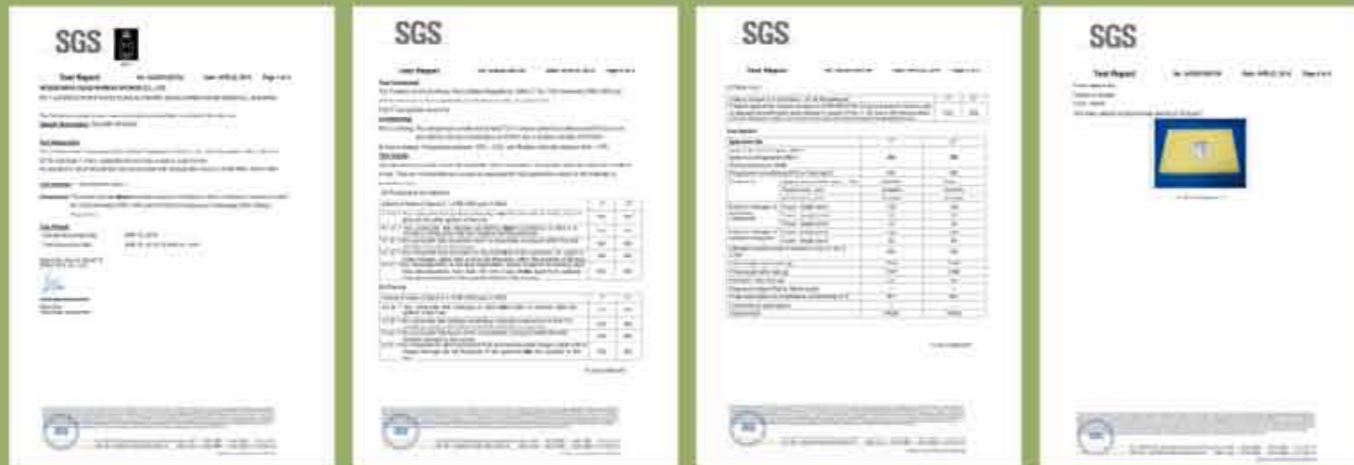

ASTM Standard

Liben is a professional manufacturer of indoor playground equipment in China. We are very committed to designing and manufacturing indoor playgrounds that comply with the International Safety Standards.

Liben indoor playgrounds are designed and manufactured in compliance with world's most comprehensive safety standards that are specifically developed for 'Soft Contained Play Equipment'. By complying with these standards, we can minimize the injury hazards in the indoor playground and to make sure that it will pass safety inspections in your country. Below are the standards that we follow:

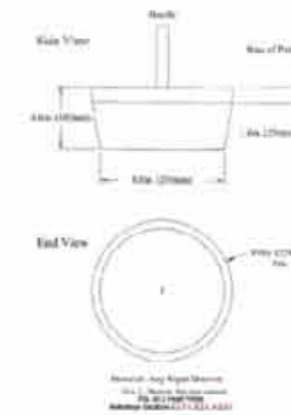

6.2.1 Accessible Openings - A completely bounded rigid opening is accessible when it is possible to insert the torso test probe into the opening to a depth of 4.0 in. (100mm) or more.

6.2.2 Nonrigid Completely Bounded Openings - A nonrigid opening such as may be found in but not limited to flexible torso probe will penetrate the opening to a depth of 4.0 in. (100mm) or more when tested in accordance with the test procedure outlined in 6.2.2.1 (See Figs. A1.1 and A1.2 for probe dimensions).

6.2.3 Angular Portions Openings - Angled formed by the surface of an opening (that is, adjacent surfaces or surfaces that intersect when projected with a distance between surfaces greater than 9.0 in. (230mm)) should be at least 55° unless one of the conditions defined in 6.2.3.1 exists.

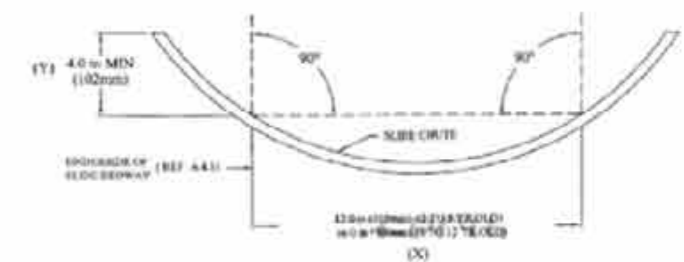

FIG. A1.20 Formula for Minimum Vertical Sidewall Height Reference Section 8.5.7

Straight Slides

- Flat open chutes should have slides at least 4 inches high extending along both sides of the chute for the entire length of the inclined sliding surface.
- Slides may have an open chute with a circular, semicircular or curved cross section provided that:
 - The vertical height of the slide is no less than 4 inches when measured at right angles to a horizontal line that is 8 inches long when the slide is intended for Toddlers, 12 inches long when the slide is intended for preschool-age-children, and 16 inches long when the slide intended for school-age-children; or
 - For any age group, the vertical height of the slides is no less than 4 inches minus two times the width of the slide chute divided by the radius of the slide chute curvature.



Note 1—If elevation is ≥ 48 in. (1220 mm) exit height shall be between 7 in. (180 mm) and 15 in. (380 mm). If elevation is ≥ 48 in. (1220 mm) exit height shall be 11 in. (280 mm) maximum. Reference Section 8.3.11.1.
 Note 2—Slide bedway length, for structural integrity purposes only, is denoted by the dashed line. Reference Section 10.4.2.2.
FIG. A1.21 Height of Slide Exit Region and Slide Bedway Length
 Reference Section 8.3.11.1

Chute Exit Region

All slides should have an exit region to help children maintain their balance and facilitate a smooth transition from sitting to standing when exiting. The chute exit region should:

- Have edges that are rounded or curved to prevent lacerations or other injuries that could result from impact with a sharp or straight edge.
- For toddlers the chute exit region should:**
 - Be between 7 and 10 inches long if any portion of the chute exceeds a 24° Slope.
 - Be no more than 6 inches above the protective surfacing.
 - Have a transition from the sliding portion to the exit region with a radius of curvature of at least 18 inches.
- For preschool and school-age the chute exit region should:
 - Be at least 11 inches long.
 - Be no more than 11 inches above the protective surfacing if the slide is no greater than 4 feet high.
 - Be at least 7 inches but no more than 15 inches above the protective surfacing if the slide is 4 feet high.

Certificates and Test Report



GB19272-2011

Liben is on a mission to "Let children grow more healthily and happily" and further develop trampoline park. Happiness and health must depend on the safety equipment. We pay attention to every detail of safety.

We produce ropes course with China standard GB19272-2011 and have each indicator in production after repeated testing.

We strictly produce according to each quality indicator and have professional testing equipment to ensure all products to meet the standard. We provide customers with comprehensive services and detailed security maintenance.

Basic Requirement

The equipment shall comply with the kinematics regularity of human body. And with characteristic of security, operability, comfort and flexibility.

General Rule for Material

All the material shall meet the requirements which are mentioned in rule 5.5.2 to rule 5.2.6 and also meet the requirement of service life.

Chart 1 Maximum Concentration Value of Hazardous Substances

Number	Item	Concentration Value	
1	Lead Content	$\leq 600\text{mg/kg}$	
2	Cadmium Content	$\leq 100\text{mg/kg}$	
3	Soluble Lead Content	$\leq 60\text{mg/kg}$	
4	Phthalate Content (Apply to surface coating only)	DEHP + DBP + BBP	$\leq 0.1\%$
		DINP + DIDP + DNOP	$\leq 0.1\%$
5	PAH Content (Apply to rubber & plastic only)	BaP	$< 1\text{mg/kg}$
		16 kinds of PAHs (Nap, AcPy, Acp, Flu, PA, Ant, FL, Pyr, BaA, CHR, BbF, BkF, BaP, IND, DBA, Bghip)	$< 10\text{mg/kg}$

Fire Resistance

The material shall be of fire resistance. According to the inspection in rule 6.2.1, the diameter of burnt plaque left in burnt plaque shall be no more than 50mm.

Wooden Material

The selection and disposition of the wooden material should:

--Connect firmly to the ground and the antiseptic treatment of parts where could effect the structure stability meet the test requirements in rule 6.2.2.1 which shall also imply with the requirements in C4A.

--Antiseptic treatment of other parts meet the test requirements in rule 6.2.2.2 which shall imply with the requirements in C3.

--The antiseptic treatment of metal parts which connect to wooden parts should not be affected by the antiseptic treatment of wooden parts.

Galvanized Steel posts

Diameter should be at least 110mm (our is 140mm).

Thickness should be at least 2.75mm (our is 3.5mm).



Protection for Shearing, Extruding, Jamming, Hooking and Twisting

There shall be no shearing, extruding, jamming, hooking and twisting structures in easily touch areas for human beings.

There shall not have any dangers occurred to the equipment because of material deformation within service life.

V-shaped structure which its opening is up and its angel is no more than 60° , it shall be tested according to rule 6.3.2.4.2 and comply with the requirements from rule 5.3.2.2 to rule 5.3.2.6.

Body Jamming

The vertical distance between the bottom of moving parts and the ground shall be at least 400mm as it might extrude the children.

There shall be no jamming under the following situations:

a). The portholes that children climb into should comply with the requirements in the following chart 2:

Sheet 2 Duct requirements

The unit is mm

Dip angle	Open at one end	Open at both ends		
	$\leq 5^\circ$ and up, only enter	$\leq 15^\circ$	$> 15^\circ$	
Minimum inner size	≥ 750	≥ 400	≥ 500	≥ 750
Length	≤ 2000	≤ 1000	≤ 2000	No
Other requirements	No	No	No	Collocate climbing structure accessories, like stair or handrail

b). Rigid suspension parts or suspension parts that its weight is more than 25kg (Fig 9) shall comply with following requirements:

- 1). The diameter of end face of slick on suspension parts shall be at least 50mm;
- 2). The scope of moving part (a in Fig 9) shall be no more than 200mm and not surpassing the boarder of the post; And within the whole scope, the distance (bin Fig 9) between the moving part to the post shall be at least 230mm.

3). There shall be a warning mark on the equipment that reminds the players that It might extrude them because of increased ground that leads to the distanc change from suspension part to ground.

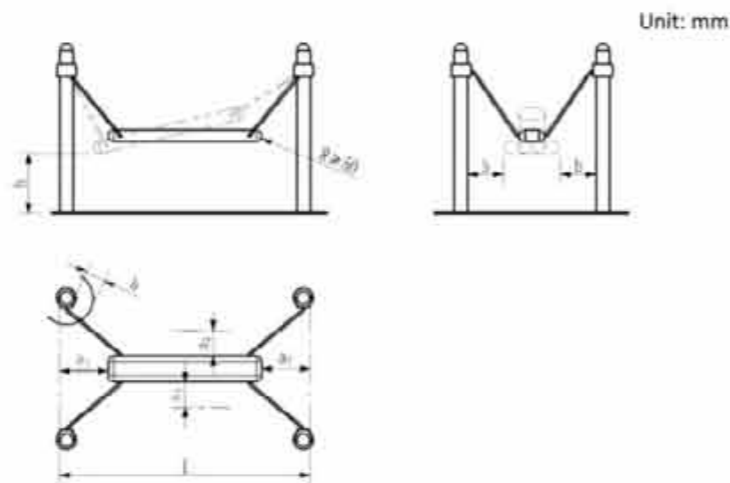

Feet Jamming and Legs Jamming

The gap of direction of main movement on the walking surface should be no more than 30mm (Fig 10).

Note : this does not apply to the surface where its inclination is more than 45°)

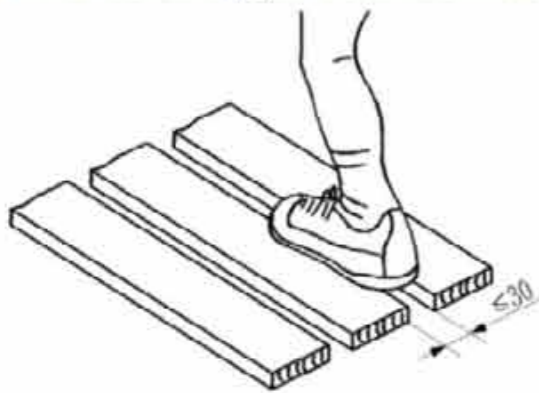

Gap of main movement direction

Cutting and Extruding and Jamming to Hands and Fingers

There shall be no V-shaped openings in easily touched areas. And the distance between moving parts and moving parts fixed parts shall be at least 60mm. Unless:

- a).Imperil the fingers only, gas shall be at least 30mm;
- b).Distance between moving parts and fixed parts stays unchanged in motion, it shall be less than 8mm.
- c). The shall be safety protection facilities and arresting device in active areas.

Part 8 FAQs

FAQ about Trampoline Parks

1.What service does Liben offer for creating trampoline park?

Liben is a factory but offers one-stop service. Apart from manufacturing trampoline equipment, we offer free 3D design, business plan advice, franchise opportunity, installation, aftersales, etc. as well.



2.What safety standard does your trampoline meet? Do you have any certificate for the materials you use?

Our trampolines are designed and manufactured to meet the guidelines of ASTM, and the materials used are certified.



3.Is there a weight limit to be on the trampoline?

The maximum bearing capacity for our trampoline is:
static bearing, 600kg/sqm;
dynamic bearing, 180kg/sqm/



4. Are there any age limits or restrictions for trampoline park?

Trampoline park is available and fun for all ages. Kids under 12 years should bring a parent or guardian for safety purpose.

5.What will my park cost to fit out? Or what cost should be included in my budget?

The cost of trampoline is based on the design, but we may offer an estimate for you. And you will then have additional costs for your ancillary areas (lockers, reception, café, toilets etc.), decoration such as wall art, marketing plan such advertising and any services you require (lighting, heating, air conditioning).



6. How much space do I require to operate a trampoline park?

We would recommend 6000 to 20,000 sq ft (600 to 2,000m²) or more to provide the optimal experience to your customers and financial payback to the operator.

Remember that trampoline activities will typically comprise between 55% to 70% of your total floor area with the rest being used for ancillary activities such as café, viewing, reception etc.

7. What ceiling height do I need in my trampoline park?

We recommend a minimum  clear height from the floor to the lowest roof obstruction of 5.2m.

8. Do you have sample plans you can send me?

Yes, we have a range of designs available for a range of building sizes from 1000sq ft to 20000sq ft that we would be pleased to send to you.

9. What should I provide if asking for custom design for my park?

We need you provide architectural plans of the building (cad drawing if possible). Also it would be highly appreciated if you could take pictures or shoot a video of the site. Our designer will then work out a design proposal based on your suggestions and our experience.



10. Is it easy to install the trampoline? Do you offer installation service outside China?

We will provide detailed and professional instruction manuals for you. And yes, we can send our installation engineer to work with your teams. The cost of installation service includes the daily salary of the engineer (\$110 per day), round-trip tickets, accommodation, etc.



11. How long does it take to build the park?

From receipt of your order and formal approval of a definitive layout to final installation will normally be 2-3 months. Generally the production time is about 25-30 days.

12. Do you provide any ancillary products for trampoline park, such as grip socks?

Yes, we can provide ancillary products like grip socks, Tyvek/silicone wristband, bubble soccer, locker, etc. (see page 3)

13. Do you provide free spare parts?

Yes, we will provide you with a small stock of spares - standard beds, springs, etc.

14. What is the warranty for your trampoline?

Frame: 2 years; Mat: 1 year; Safty Padding: 6 months. Spare parts such as springs and foam pits are not included in the warranty.



15. Can I see and try out your trampoline park?

Absolutely, we' ll advise the nearest Liben trampoline project to you. And we sincerely invite you to visit our showroom in Wenzhou, China. We have a demonstration set up that shows most of the elements we incorporate into a full system. You can look all over it, have a bounce and see the quality of our product first hand. (see page 3)

FAQ about Indoor Playground

1. How do I get started?

Simply call one of our sales staffs today. We'll make your job easier by helping determine the best equipment fit for your business or organization. We'll provide you with samples, pricing and great advice to help you get going.

2. How do I find a suitable building for my indoor play centre?

Send any potential buildings you consider through to us and we will advise on the appropriateness of the building. We will consider a range of factors including building dimensions and building height, car parking, local catchment, planning change of use potential.

3. How much will it cost to start an indoor play centre?

As a general guide, indoor play centres will cost broadly \$13,500 to set up a 100sqm (1076 sq ft) unit. We will help you to design the optimum layout for your building and will design your play equipment to suit your building characteristics, your play preference and your play budget.

4. What is the standard floor height? What is the limit for the zheight?

The standard floor height is 1.4m. We advise 5 floors the maximum and the minimum ceiling height not less than 2.5m.

5. What themes do you have for indoor play center?

We have Classic, Jungle, Ocean, Candy, Pirateship, Castle, etc. We could also offer custom theme according to your requirements.

6. What is the age range for indoor play center?

Generally the indoor play center is divided into Main Play Zone and Toddler Zone, considering the motor skills of different ages and the safety during play. The Main Play Zone is for 3-12 years old and Toddler Zone for 1-3 years old.

7. How long does it take to manufacture a playground?

Production schedules vary depending on the size and complexity of the equipment. However, a general rule of thumb is approximately 15-25 days from the contract date. We will work with you on a schedule that best meets your business needs and we'll guarantee the installation date.

8. Do you have detailed and professional installation manual?

Yes. The installation is an issue of common concern for building indoor play center, that's why our engineers and designers devote lots of time to improving the installation manual. Now together with installation video, the manual is detailed enough for our clients to install accordingly step by step. And our team is always ready to help solve any problem you encounter during the installation till it's completed successfully.

9. Does your equipment meet safety regulations?

Yes, we design and manufacture all of our equipment to meet North American ASTM standards (American Society of Testing and Measures) for Indoor Soft Playgrounds.



10. Do you offer installation service outside China?

We will provide detailed and professional instruction manuals for you. And yes, we can send our installation engineer to work with your teams. The cost of installation service includes the daily salary of the engineer (\$110 per day), round-trip tickets, accommodation, etc.



11. Is maintenance required?

Under normal use and conditions our playgrounds require only scheduled cleaning and inspections. After your equipment is installed, a maintenance manual that contains cleaning and maintenance instructions and schedules will also be provided.



12. Is an Liben Playground covered by Warranty?

Yes, we offers a full warranty on all of our Playgrounds and Installations.

FAQ about Indoor Ropes Course

1. Are there any age limits or restrictions for indoor ropes course?

Indoor ropes course is available for player above 6 years old. Kids under 12 years should be accompanied by an adult. Players with heart conditions, high blood press, asthma, etc should not be allowed to play.

2. What safety standard does your indoor ropes course meet?

Our indoor ropes courses are manufactured according to the guidelines of Chinese National Standard GB19272-2011.

3. How much space do I need to operate indoor ropes course?

We advise 430 to 2200 sq ft (40-200 sqm²), and 1000-1600 sq ft (100-150sqm²) would be optimal.

4. What ceiling height do I need for indoor ropes course?

We recommend a minimum  clear height from the floor to the lowest roof obstruction of 5.2m.

5.Do I need to pay for custom design?

No. We will provide custom design free of charge, based on the architectural drawing of your area and the programs you prefer.

6.Do you offer installation service?

Yes. We could send our installation engineer to work with your team. If you have professional personnel to install, we'll offer detailed installation manual for you.

7.Do I need to hire supervisors/trainers for the indoor ropes course during play?

Yes. You should hire supervisors/trainers according to your size of indoor ropes course. They should be well-trained to be aware of potential risks and have the ability to deal with emergency events.

8.Is maintenance required?

Yes, the indoor ropes course should be maintained regularly. We'll provide detailed maintenance guidance for you after order confirmed.

9.What is the warranty for indoor ropes course?

Main Frame: 5 years; Platform: 3 years; Track:3 years;
Low-stretch rope: 3 years (indoor), 2 years (outdoor);
Climbing Wall: 2 years; Falling protector: 3 months.

10.Do you provide safety equipment, eg. safety helmet?

Yes, we will provide a certain number of safety equipment according to your area size.

Part 9 The Related Accessories

Components for Indoor Playground Equipment

Foam Pipe

Model	Material	Unit (H*W*D) Size(mm)	USD Unit Price FOB Ningbo	Packing Volume (CBM)
LE.BG.001	foam,PVC	2500*15	\$3.20	0.1/25 pieces



Cable Tie

Model	Material	Unit (H*W*D) Size(mm)	USD Unit Price FOB Ningbo	Packing Volume (CBM)
LE.ZD.001	plastic	350*8	\$4.20	0.1/50 bags



Plastic Ball

Model	Material	Unit (H*W*D) Size(mm)	USD Unit Price FOB Ningbo	Packing Volume (CBM)
LE.HQ.001	plastic	Dia:80	\$0.05	0.15/ bag



Plastic Slide

Model	Material	Unit (H*W*D) Size(mm)	USD Unit Price FOB Ningbo	Packing Volume (CBM)
LE.HS.009	HDPE	L:2700	\$254.95	2
LE.HS.010	HDPE	L:2200	\$150.14	1



Indoor Electric Amusement

Model	Material	Unit (H*W*D) Size(mm)	USD Unit Price FOB Ningbo	Packing Volume (CBM)
LE.TD.009	Steel - framed structure,	2800**2800*2700	\$1584.00	3
LE.TD.003	Smooth PVC, good pearl cotton,	1900*900	\$1296.00	2
LE.TD.014	wood inside	2100*2100*300	\$1008.00	1.5



LE.TD.009



LE.TD.003



LE.TD.014

Components for Indoor Ropes Course

Wood

Model	Material	Unit (H*W*D) Size(mm)	USD Unit Price FOB Ningbo	Packing Volume (CBM)
LE.TZ.001	Pinus sylvestris	3200*180*50	\$191.00	0.15



Shoe Shelf

Model	Material	Unit (H*W*D) Size(mm)	USD Unit Price FOB Ningbo	Packing Volume (CBM)
5.LE.OT.267.03	Fireproof Board	1200*250*680	\$661	0.2



Counter

Model	Material	Unit (H*W*D) Size(mm)	USD Unit Price FOB Ningbo	Packing Volume (CBM)
LE.BZ.001	Density compression plate	1100*600*3800	\$471.84	2.5



LE.BZ.001

Bar Stool

Model	Material	Unit (H*W*D) Size(mm)	USD Unit Price FOB Ningbo	Packing Volume (CBM)
LE.BY.001	PU, Plating rust steel	H:380-550	\$17.42	0.05
LE.BY.002		H:380-550	\$19.00	0.05
LE.BY.003		H:600-800	\$23.75	0.06
LE.BY.004		H:600-800	\$25.33	0.06



LE.BY.001

LE.BY.002



LE.BY.003

LE.BY.004

Flooring- EVA Flooring Mats

Model	Material	Unit Size(cm) (L*W*H)	Unit Price FOB Ningbo	Packing Volume (CBM)
LE.DD.004	EVA	100x100x2.0	\$9.6	0.0075
LE.DD.005	EVA	100x100x2.0	\$9.6	0.0075
LE.DD.002	EVA	100x100x2.0	\$7.2	0.0075



LE.DD.004



LE.DD.005



LE.DD.002

Safety Belt / Helmet

Model	Material	Unit (H*W*D) Size(mm)	USD Unit Price FOB Ningbo	Packing Volume (CBM)
LE.QY.002	High-strength polyester, material alloy fasteners	570*210*240	\$41.0	10 pieces/1CBM
LE.QM.001	ABS Engineering Plastics	610*440*530	\$18.53	20 pieces/1CBM



Safety Rope / Safety buckle

Model	Material	Unit (H*W*D) Size(mm)	USD Unit Price FOB Ningbo	Packing Volume (CBM)
LE.AR.001	Polyester	6/8	\$7.82	30 pieces/0.001CBM
LE.AR.002	Nylon	16	\$1.65	30 pieces/0.001CBM
LE.AK.001	Hot dip aluminum- magnesium alloy	310*240*130	\$3.71	100pieces/1CBM
LE.AK.002	Hot dip aluminum- magnesium alloy	240*240*210	\$10.29	100pieces/1CBM



LE.AR.001



LE.AR.002



LE.AK.001



LE.AK.002

Trampoline Park Quick-wear Parts

Spring

Model	Material	Unit Size(mm) (L*W*D)	USD Unit Price FOB Ningbo	Packing Volume (CBM)
LC.PP036	carbon steel wire	180*3.20*27	\$0.61	1.6/100000 pcs



Trampoline Mat

Model	Material	Unit Size(mm) (L*W)	USD Unit Price FOB Ningbo	Packing Volume (CBM)
LP.XYM001.171	PP	1760*1760	\$81.00	1/100pieces



Olympic Trampoline Mat

Model	Material	UnitSize(mm) (L*W)	USD Unit Price FOB Ningbo	Packing Volume (CBM)
LP.BMX032.03	Poly-amide yarns	4260*2130	\$907.00	1/111pieces



Soft Padding

Model	Material	Unit Size(mm)	USD Unit Price FOB Ningbo	Packing Volume (CBM)
LC.RB003	PVC leather, Thickness=30 XPE, velcro straps		\$39.2/sqm	0.03/sqm



Foam Block

Model	Material	Unit Size(mm) (L*W*H)	Unit Price FOB Ningbo	Packing Volume (CBM)
LC.RB008	Foam Density: 22kg/m ³	150*150*150	\$ 0.60	0.34/100 pcs



Safety Net

Model	Material	Unit Size(m)	Unit Price FOB Ningbo
LS.YL06.004.00	High-tenacity PET fiber	width=3	\$7/KGS



Accessories for Trampoline Parks

Dodgeball

Model	Material	Unit Size(inch)	Unit Price FOB Ningbo	Packing Volume (CBM)
LC.RB002	PVC leather, PU Foam	diameter=6	\$15.00	0.14/100 pcs



Flooring

Model	Material	Unit Size(mm)	USD Unit Price FOB Ningbo	Remark
LS.YL05.022	EPDM	Thickness=6	\$22.4/sqm	without ghue



Trampoline Park Available Accessories

Trampoline Sock

Model	Material	Unit Size	USD Unit Price FOB Ningbo	Packing Volume (CBM)
LE.OT.620	Polyester Fibre	S	\$0.63	0.13/500 pairs
		M	\$0.68	
		L	\$0.84	



Remark:
MOQ: 2400pcs
Customized design and quantity need to recheck price.

Wristband

Model	Material	Unit Size(mm) (L*W)	USD Unit price FOB Ningbo	Packing Volume (CBM)
LE.OT.640	Tyvek	25*250	\$0.30	0.28/100000 pcs



Remarks:
MOQ: 1000pcs
Customized design and quantity need to recheck price.

T Shirt

Model	Material	Unit Size	USD Unit price FOB Ningbo	Remark
LE.OT.621	Purified Cotton	S-XXXL	\$7.5	15 colors available



Inflatable Ball

Model	Material	Unit Size(m)	USD Unit price FOB Ningbo	Packing Volume (CBM)
LE.OT.628	TPU	diameter=1.2	\$163.00	0.05
		diameter=1.5	\$201.00	0.06
		diameter=1.7	\$252.00	0.09



Remark:
With blower

Part 10 A Collection of Trampoline Parks



1 Irregular Customized Series



2 Scene Effect Series



3 Large Trampoline Series

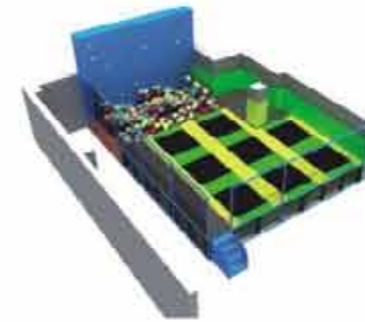

7 Children Trampoline Series

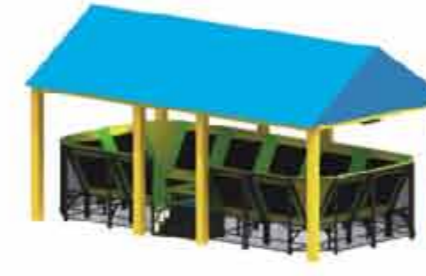

8 Outdoor Trampoline Series



9 Small Trampoline Series



4 Large Combination Park Series



5 Single Color Series



6 Multi-color Series



10 Medium Sized Trampoline Series



11 Indoor Playground Series



12 Indoor Ropes Course

1 Irregular Customized Series



■ 5.LE.B8.603.171.01

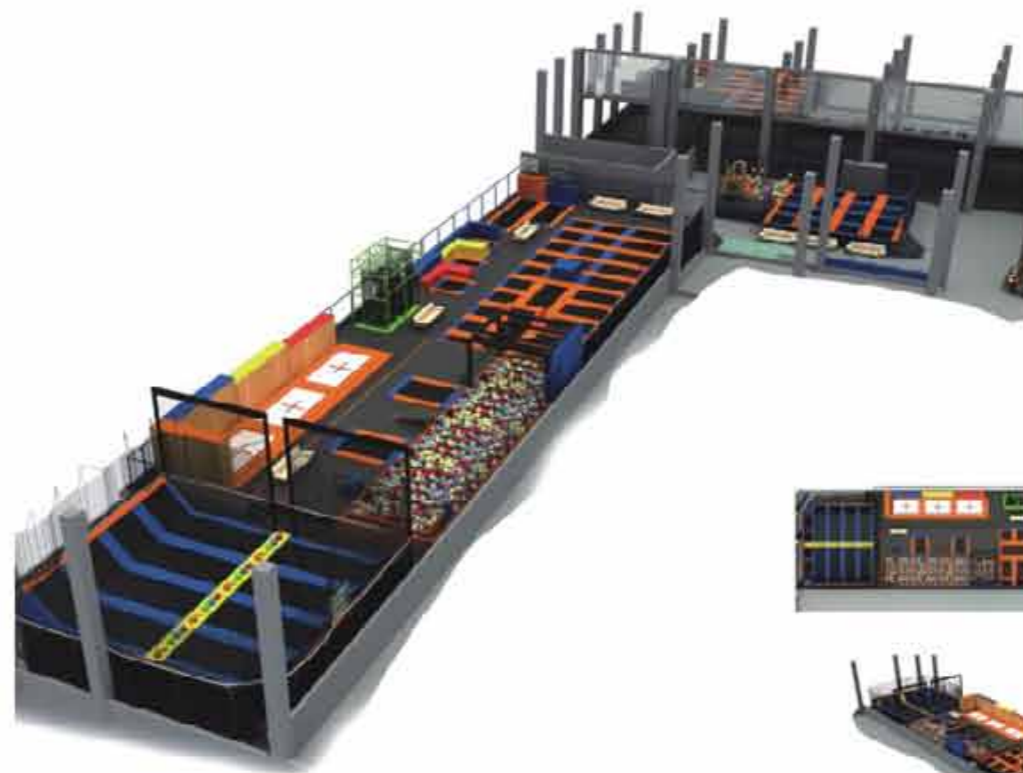

■ 5.LE.B9.512.121.01

■ 59*15*4.5m



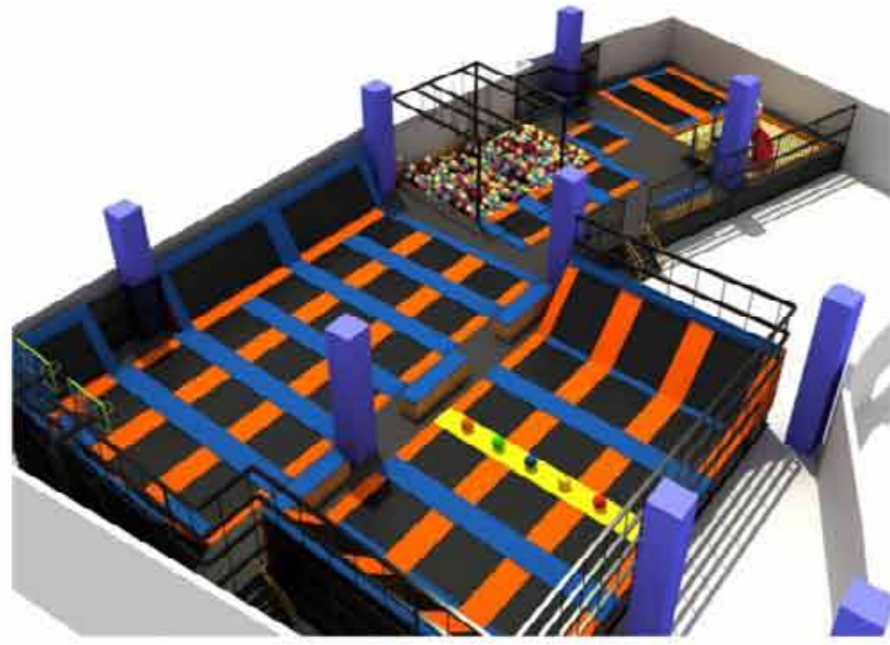

■ 5.LE.B9.601.251.02

■ 17.8*35*6m

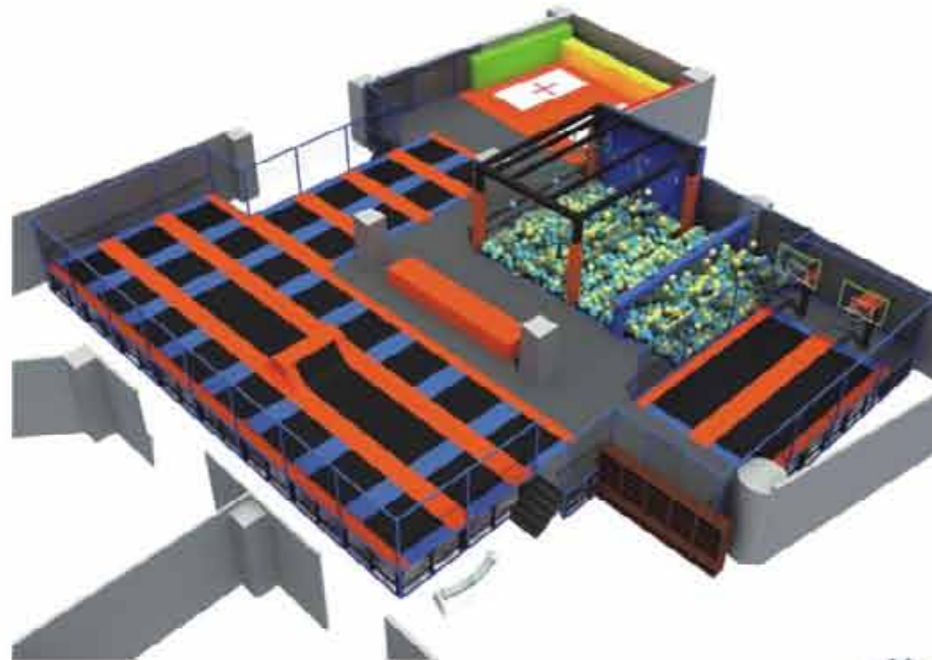
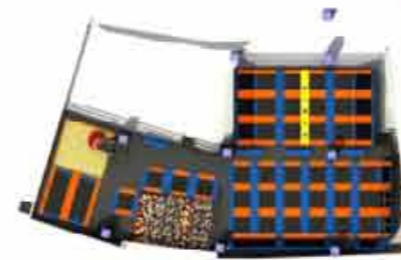

■ 5.LE.B8.512.152.01

■ 23.6*23.5*4.8m

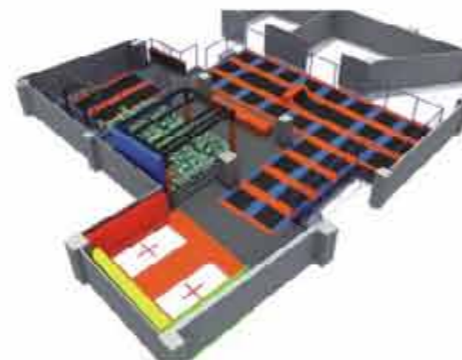

Irregular
Customized
Series



■ 5.LE.B8.603.051.01

■ 100*87*6m

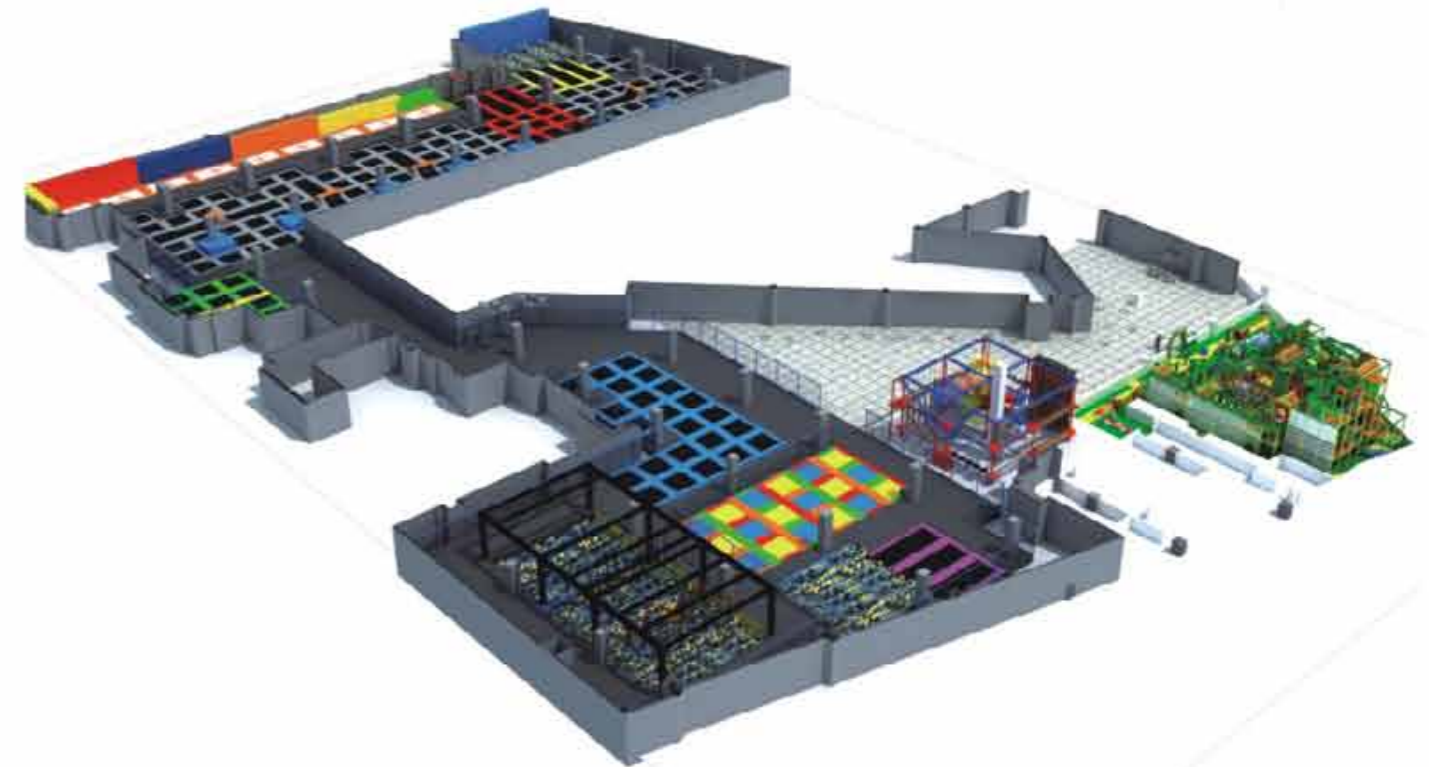

Irregular
Customized
Series

89-90

2

Scene Effect Series

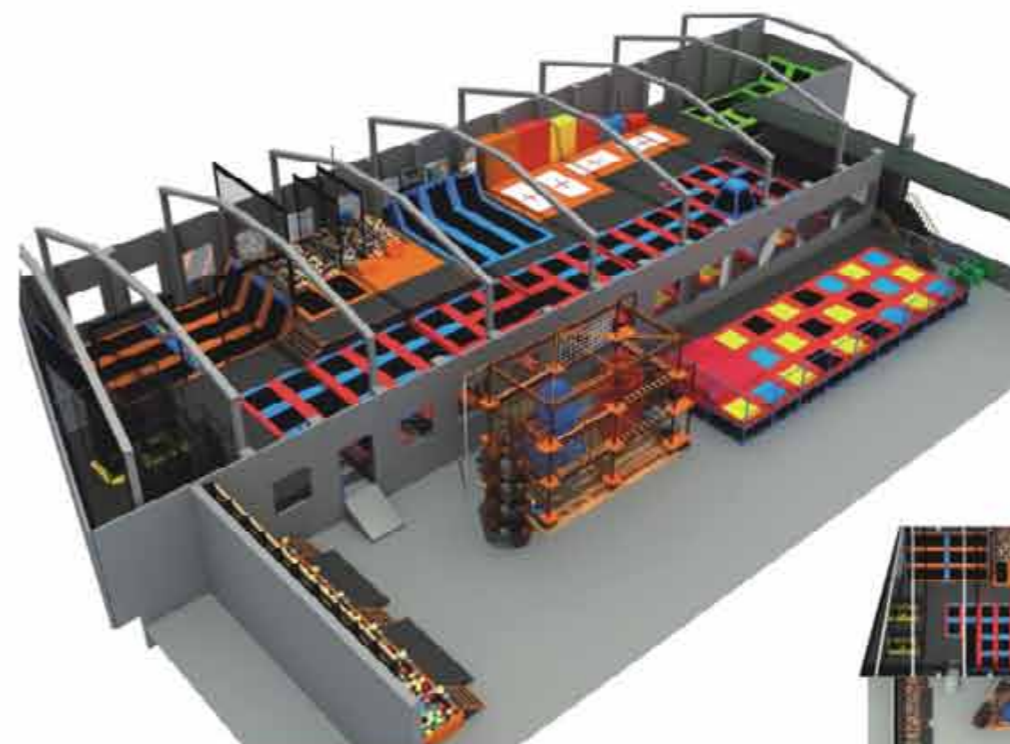

■ 5.LE.B9.510.071.01

■ 63*21*8.5m

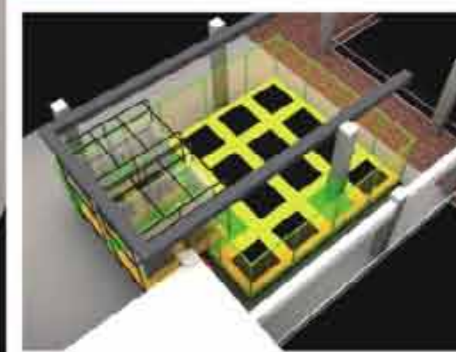
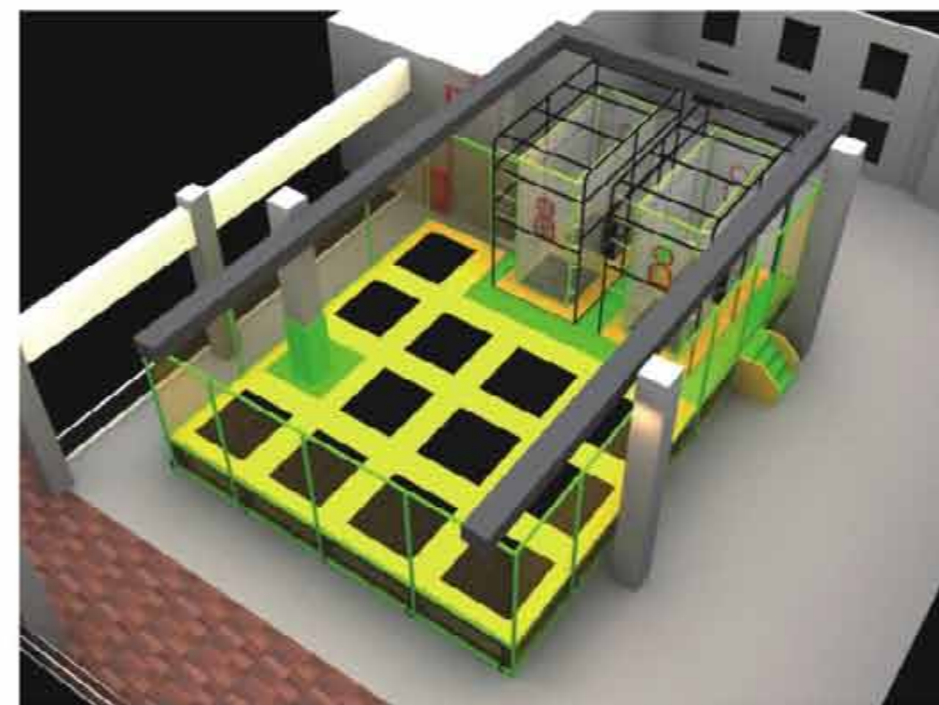

■ 5.LE.T3.501.131.00

■ 12.5*9.4*4.5m



2

2nd Floor
Activity Room

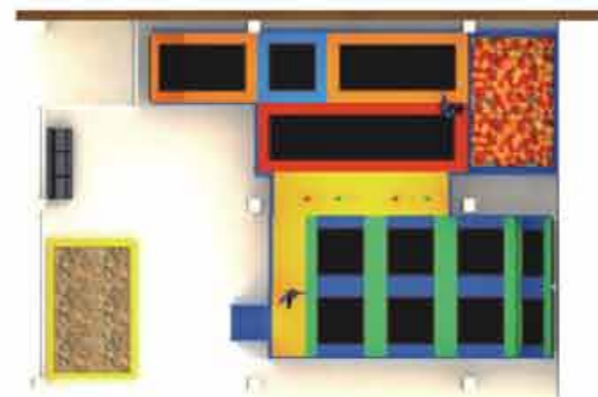

■ 5.LE.B9.504.241.02

■ 14.15*11.2*3m



2

2nd Floor
Activity Room

93-94

■ 5.LE.B1.504.221.00

■ 14.7*25*6.4m 11.6*35.5*5m

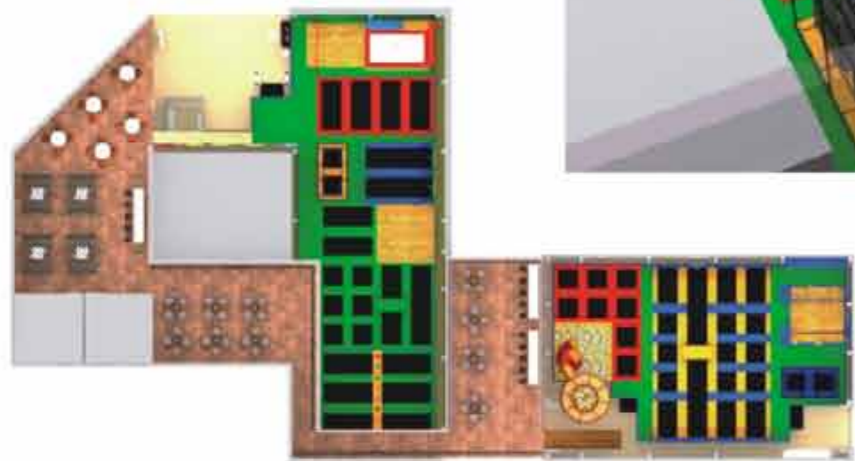
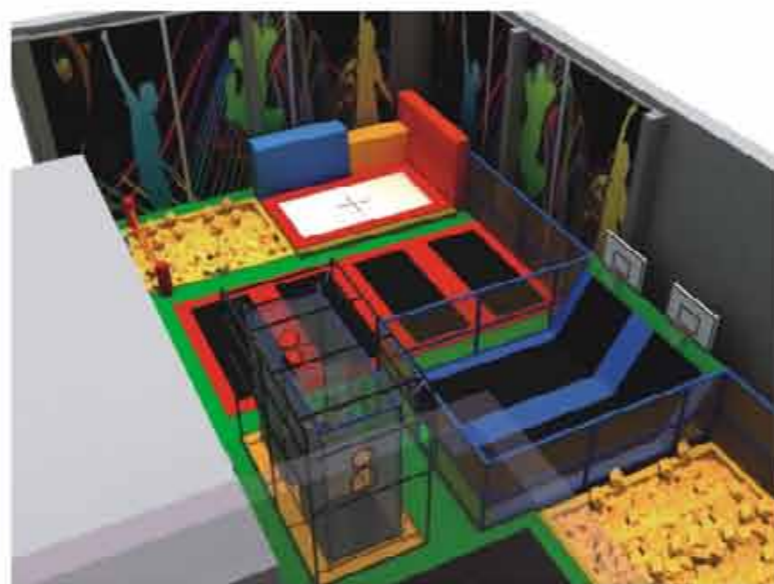

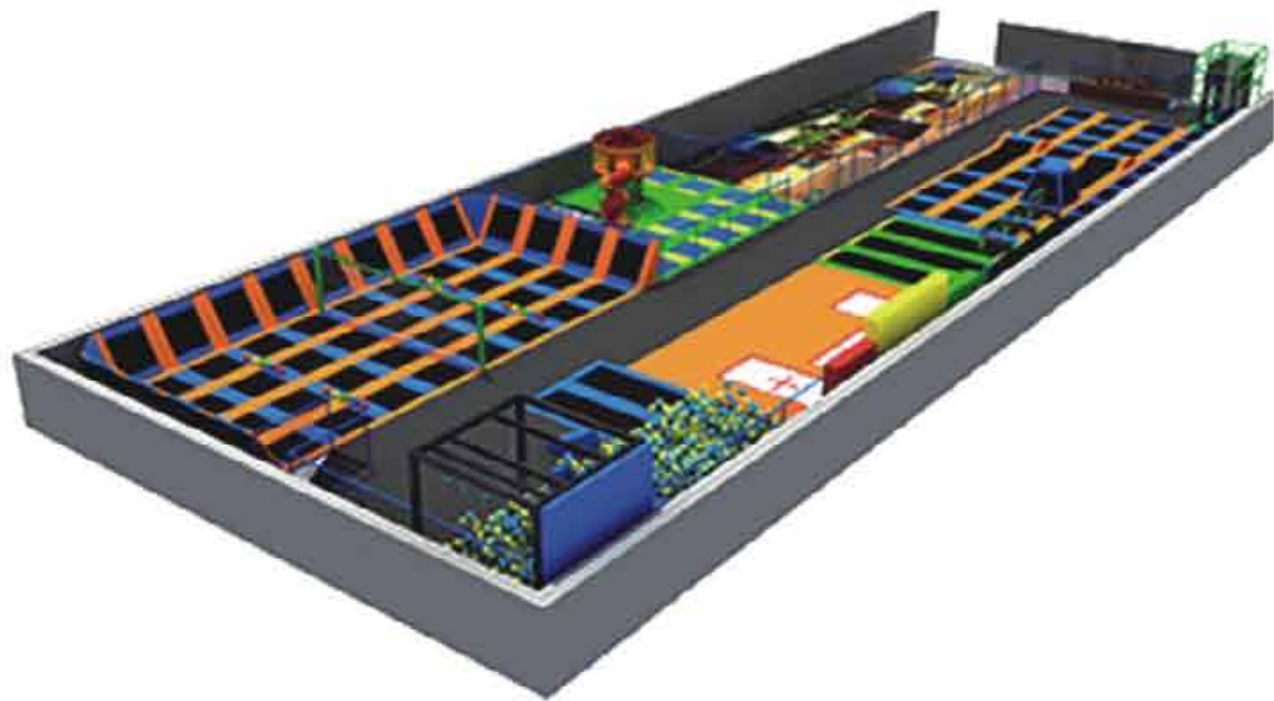

■ 5.LE.B8.511.255.01

■ 61.2*22.9*5m



2

2020
Event
Space

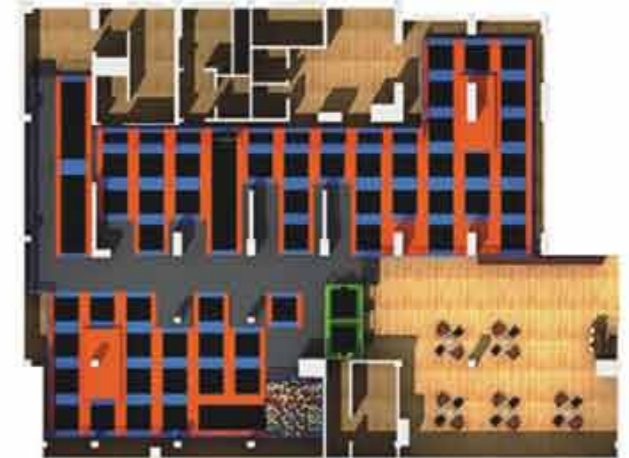
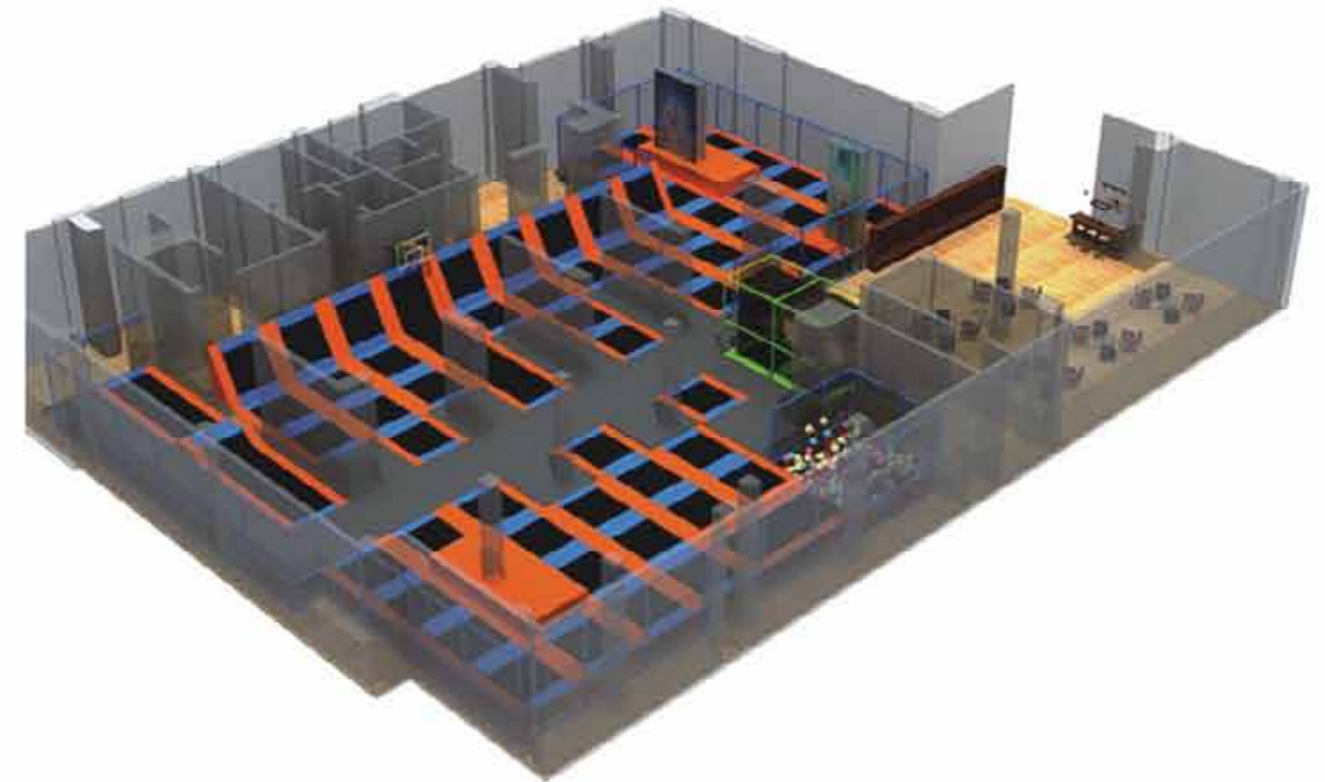

2

2020
Event
Space

95-96



■ 5.LE.B8.511.302.01

■ 26*32*4.5m

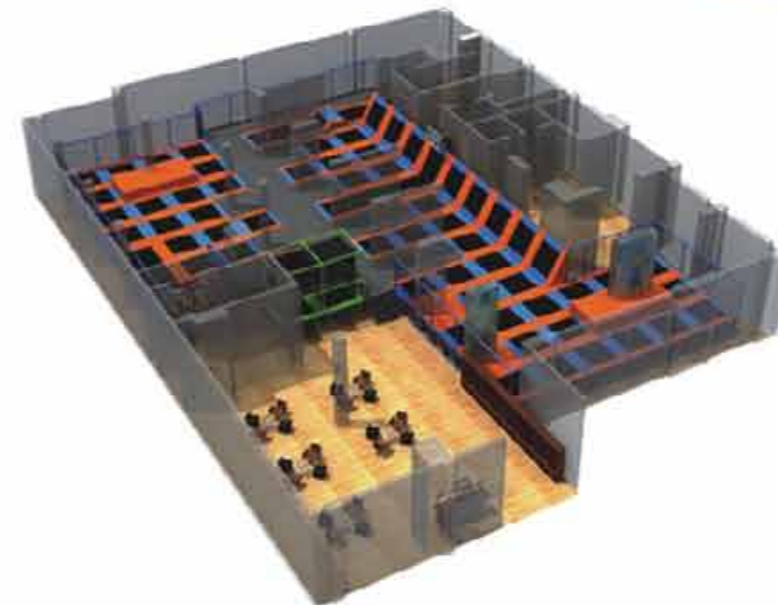

3

Large Trampoline Series

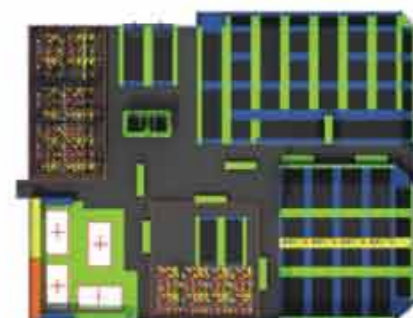

■ 5.LE.B9.512.241.01

■ 28*36*7m

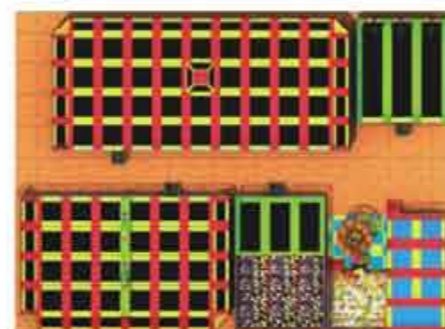

■ 5.LE.B8.511.021.01

■ 35*25.9*6m

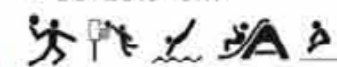

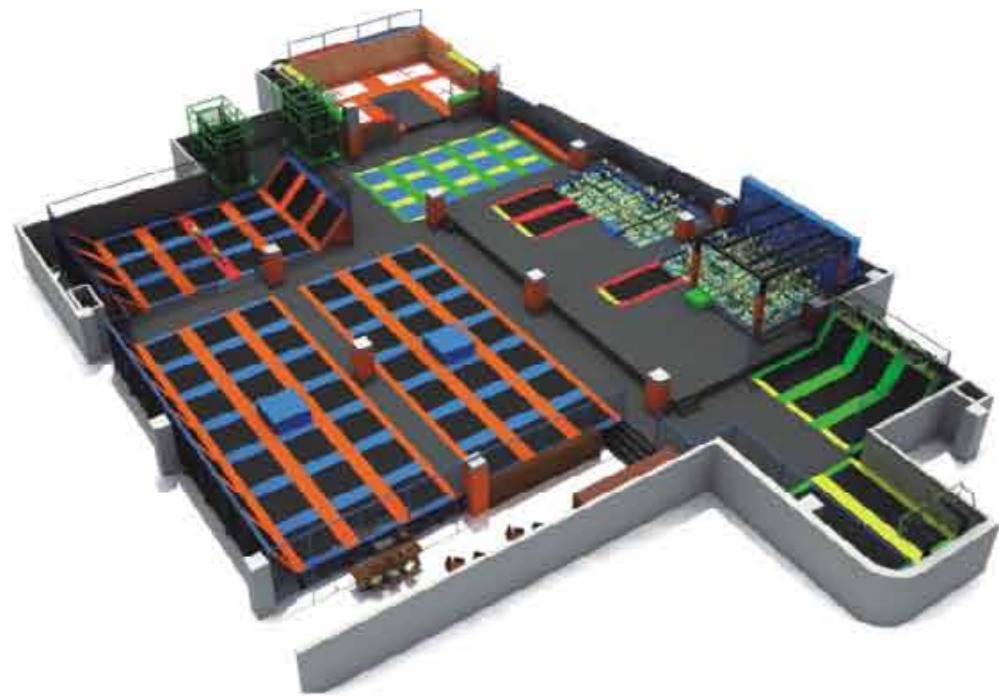

■ 5.LE.B8.601.112.01

■ 55*35*5.5m

大型蹦床乐园

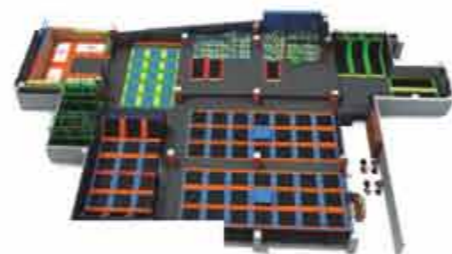

3

Large
Trampoline
Series



■ 5.LE.B9.512.151.01

■ 34*49.1*5.5m

大型蹦床乐园

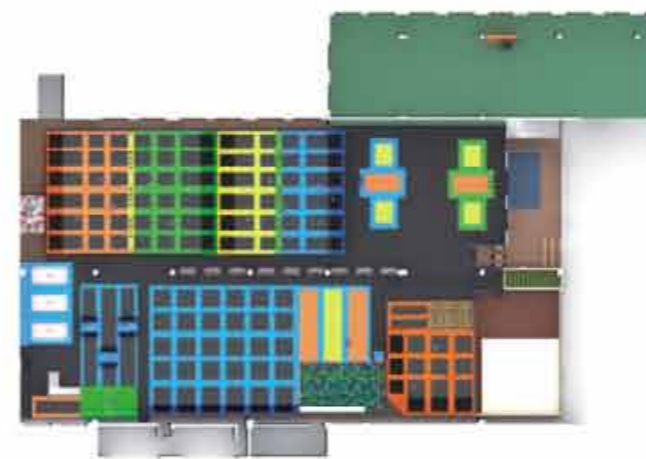
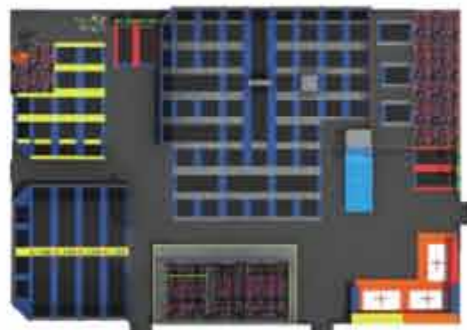

■ 5.LE.B9.504.252.00

■ 60*31.6*7m

大型蹦床乐园

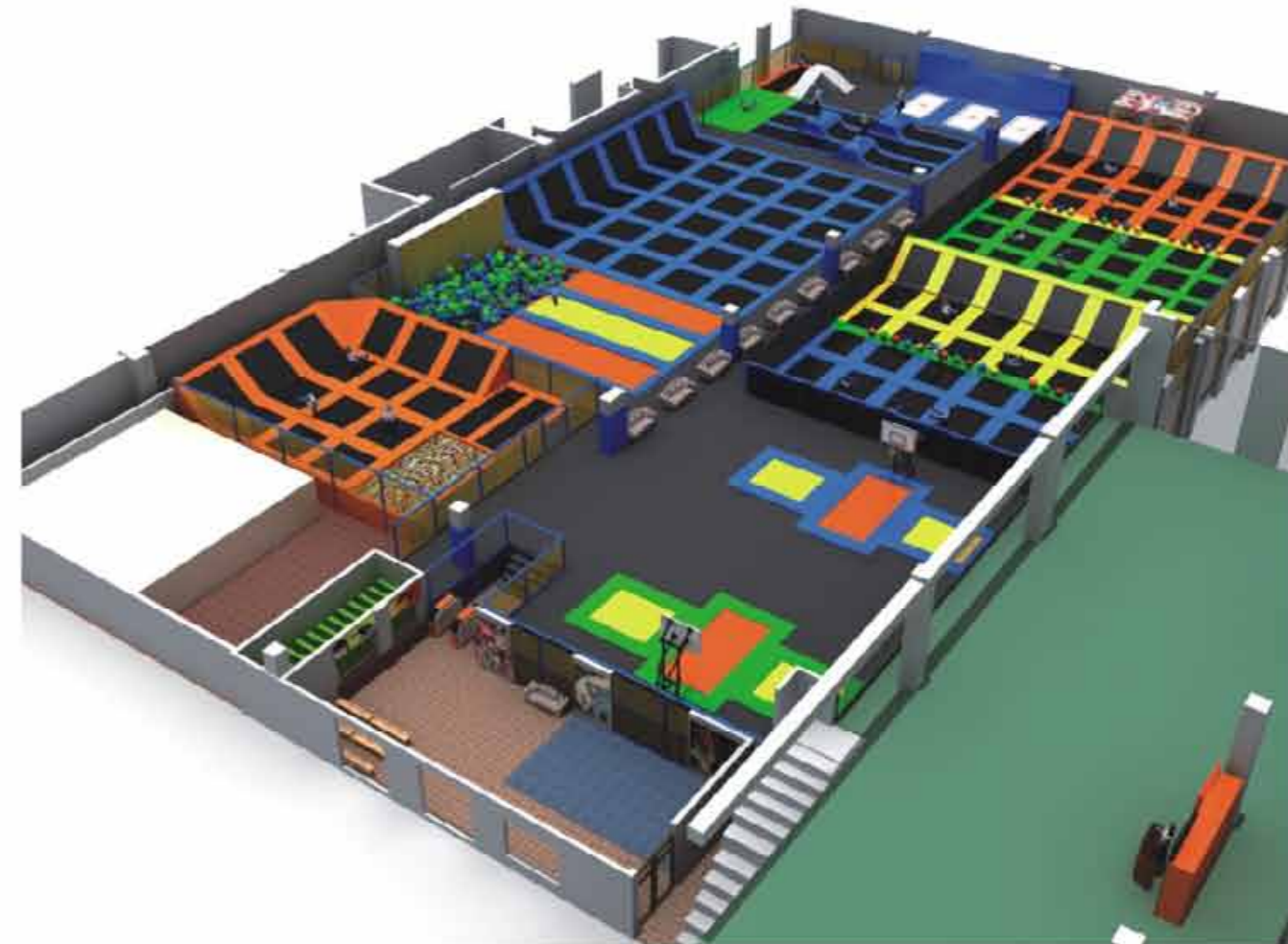
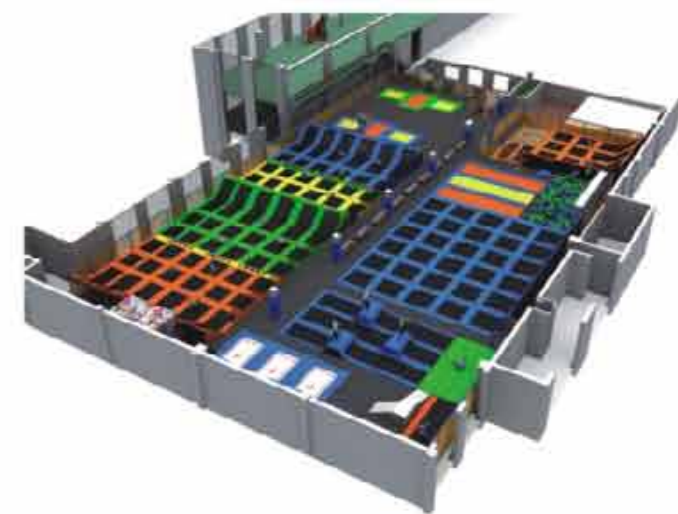

3

Large
Trampoline
Series

99-100

4

Large Combination Park Series



■ 5.LE.B9.511.301.01

■ 76.3*33.6*7.5m

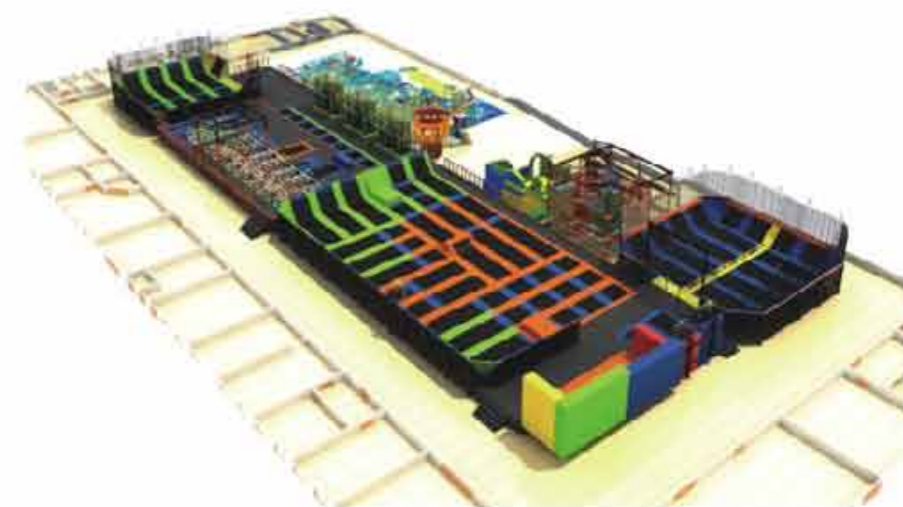

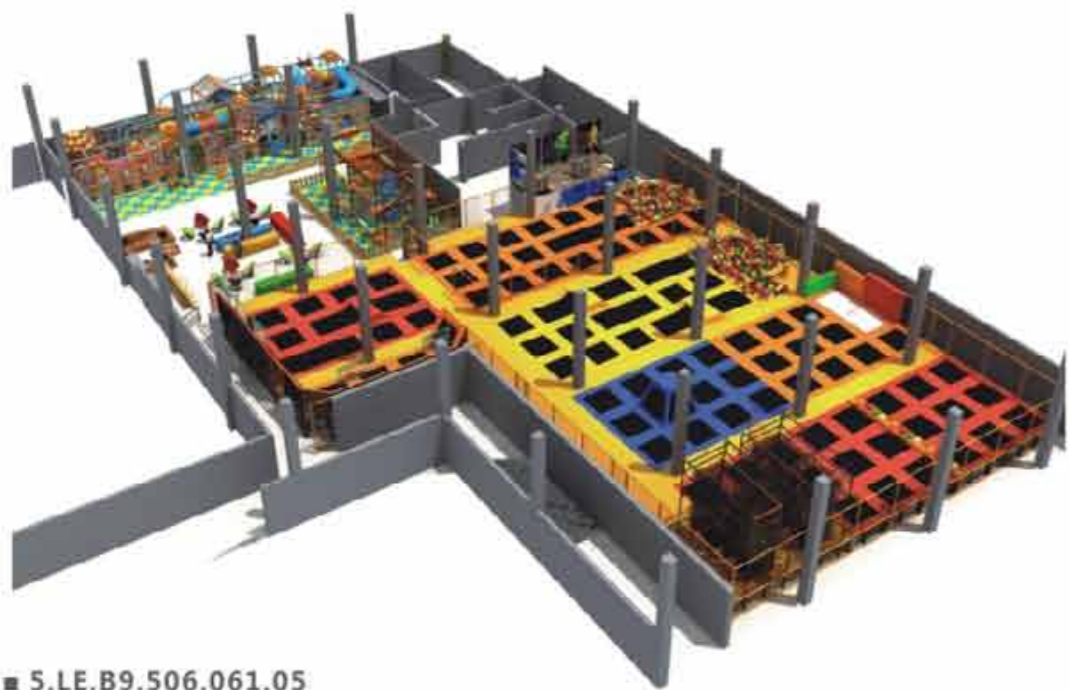

■ 5.LE.B9.506.061.05

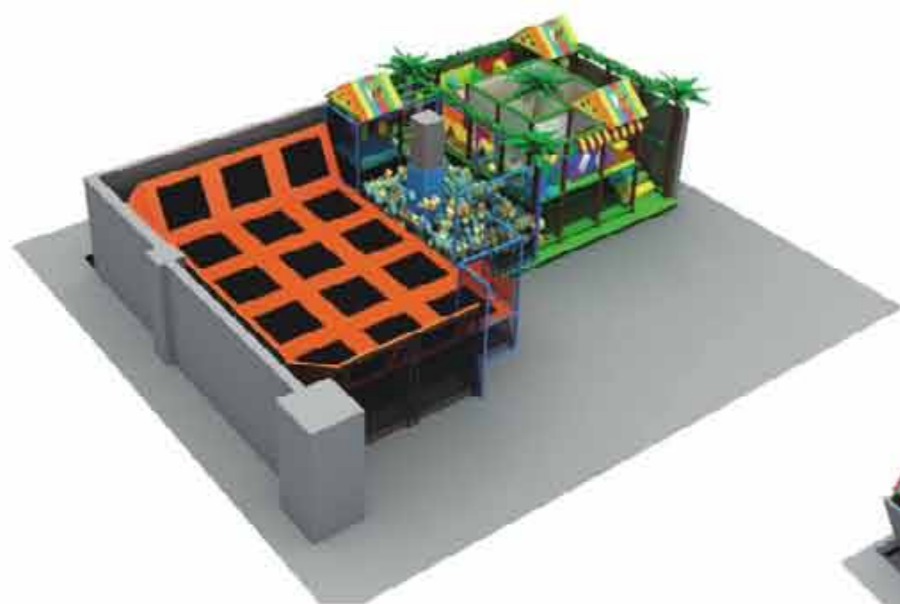

■ 5.LE.B8.512.032.01

■ 13.65*9.22*3.6m



4

Large
Combination Park
Series



■ 5.LE.B8.510.121.01

■ 30*40*5.5m



■ 5.LE.B8.603.033.01

■ 18*17.5*5.4m



4

Large
Combination Park
Series

103-104

5

Single
Color
Series

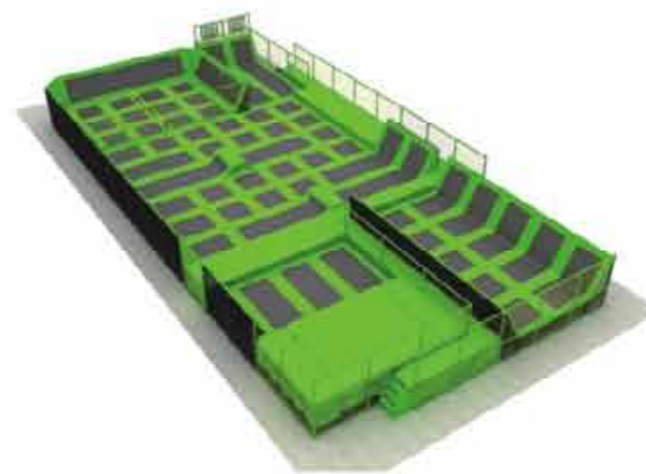
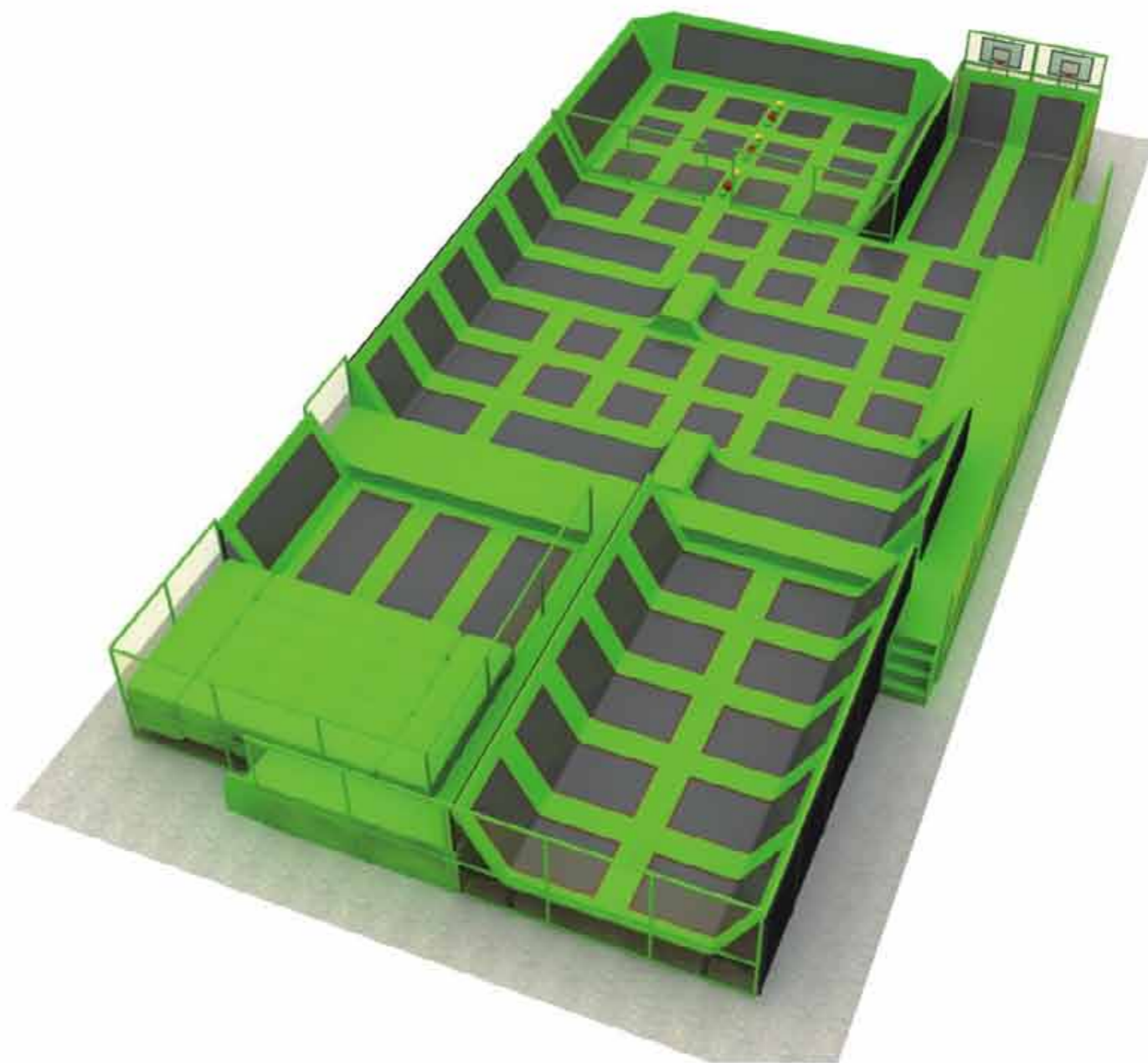

■ 5.LE.T2.503.214.00

■ 35.1*17.5*4.5m

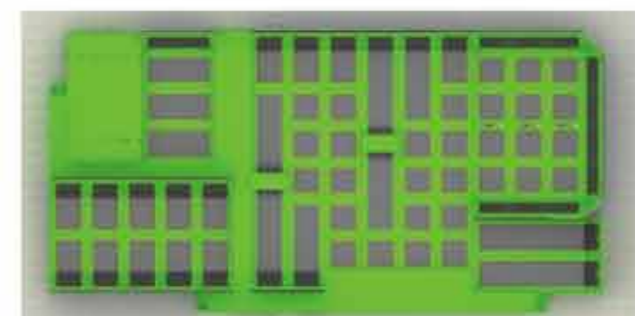

5
Single
Color
Series

105-106



■ 5.LE.B8.512.172.01
 ■ 20.82*8.3*5m

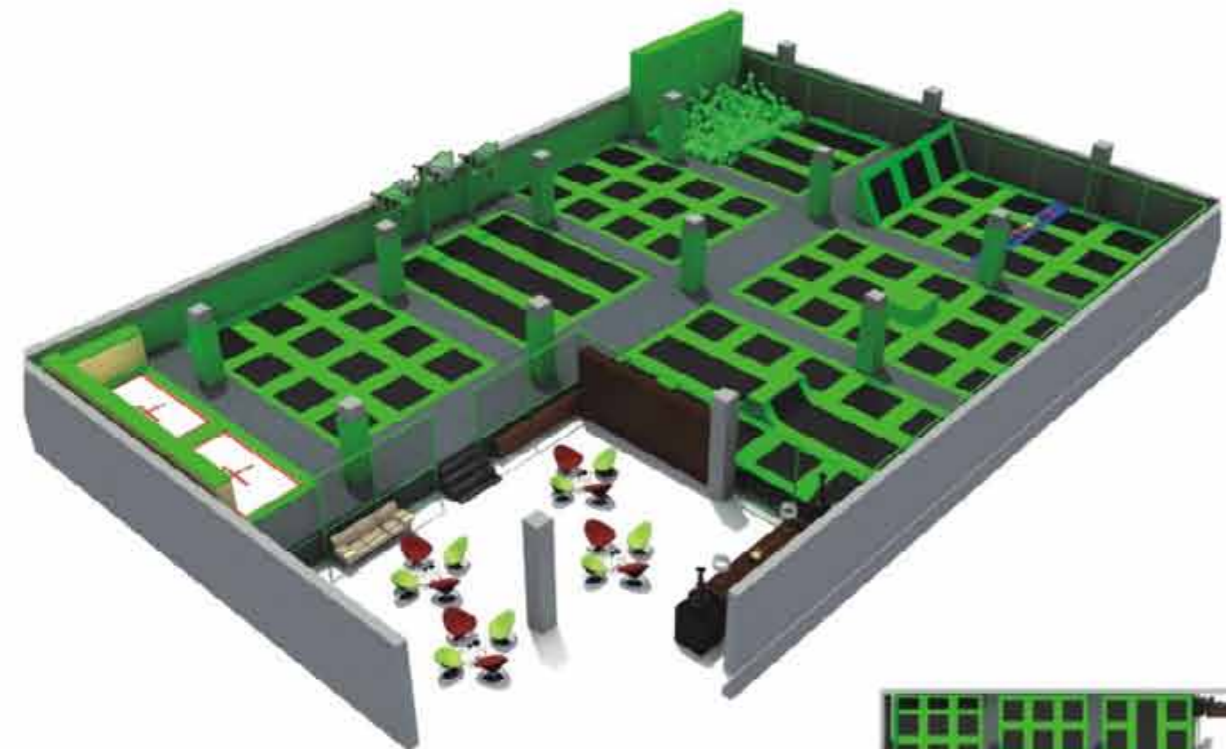

■ 5.LE.B8.603.236.02
 ■ 36*24*5m

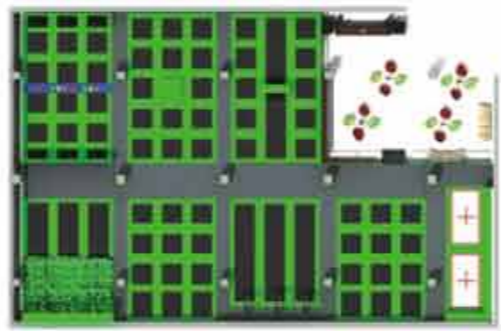

5
 Single
 Color
 Series

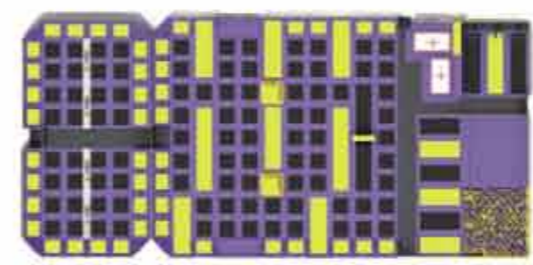
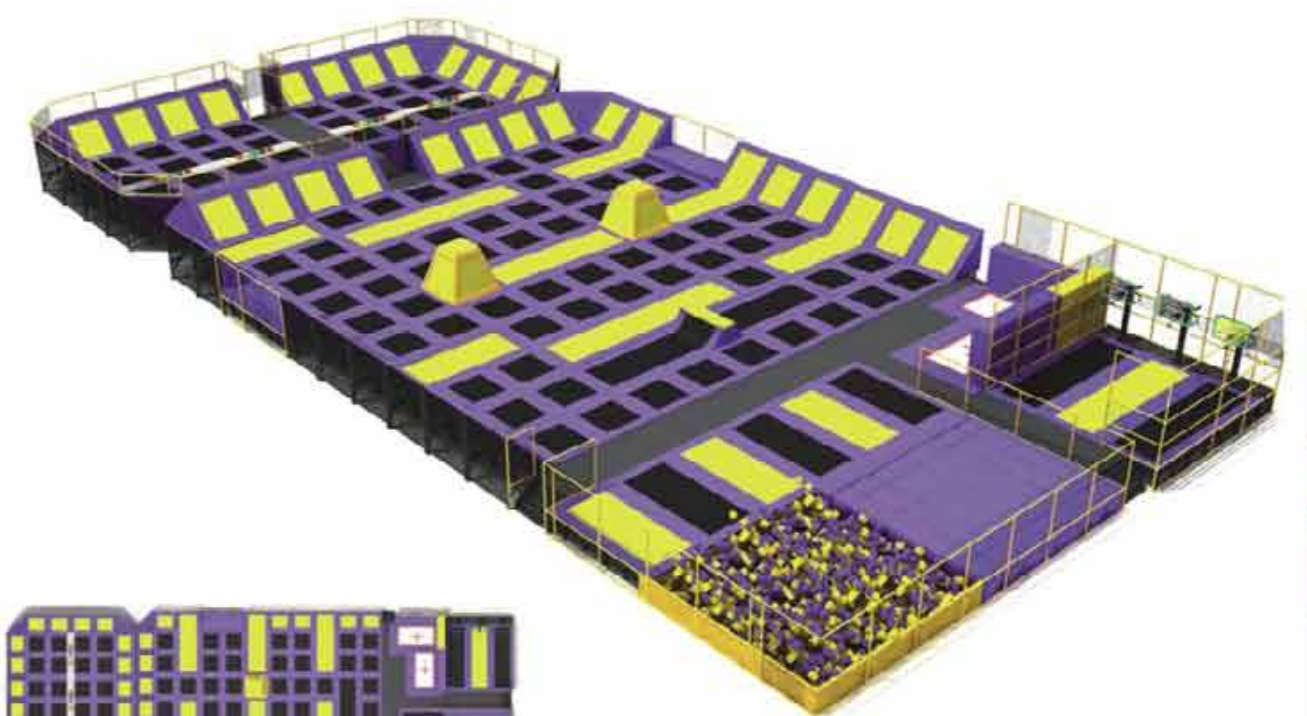

■ 5.LE.B8.512.211.03
 ■ 60*28*5.2m

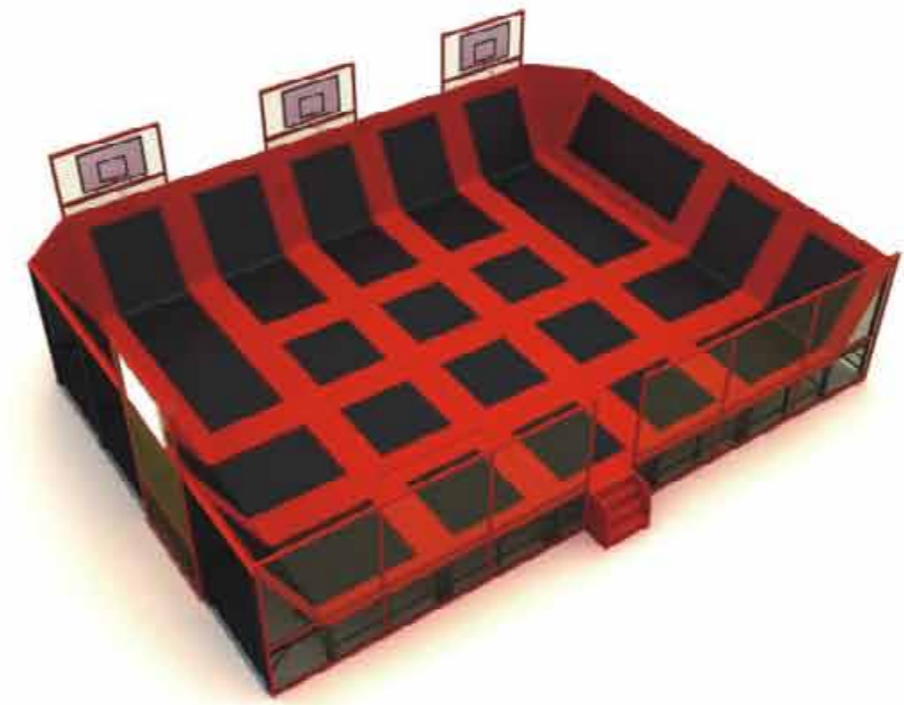
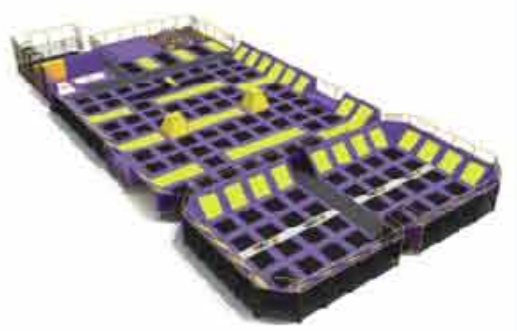

■ 5.LE.B2.504.011.01
 ■ 10.6*14.15*4.5m

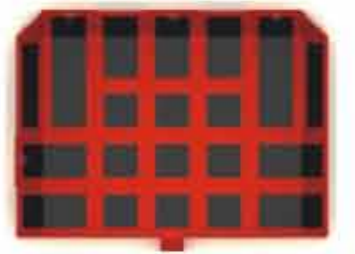

5
 Single
 Color
 Series



■ 5.LE.B8.601.232.04
 ■ 23.8*14.2*3m 19*16.45*5.4m

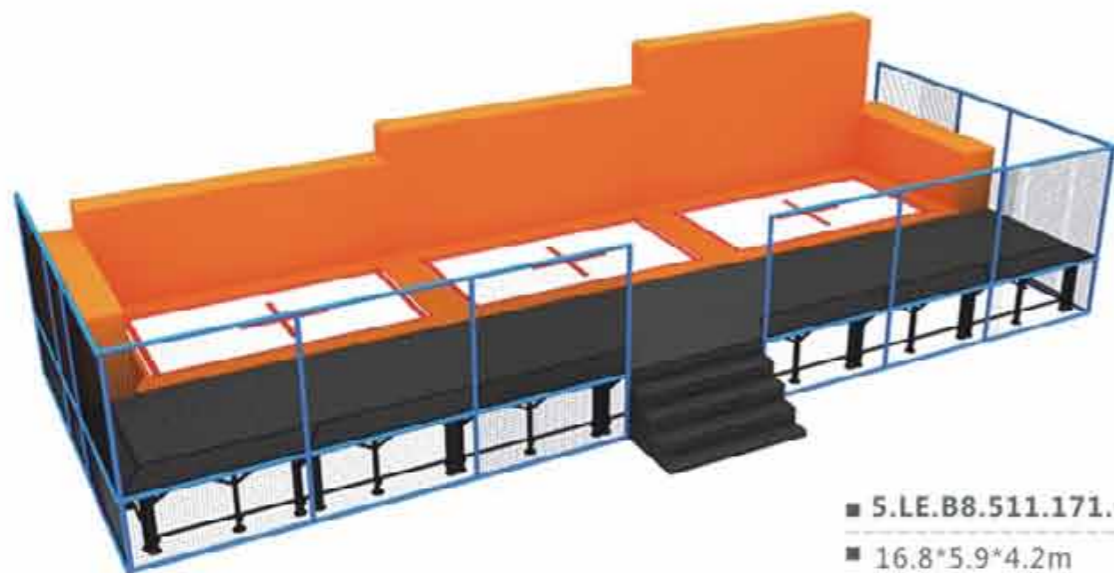

■ 5.LE.B8.511.171.01
 ■ 16.8*5.9*4.2m



5

Single
Color
Series



■ 5.LE.B8.601.062.01
 ■ 14.1*5.92*3m



■ 5.LE.B8.511.246.01
 ■ 22.35*8.25*4m



5

Single
Color
Series

109-110

6

Multi-color Series

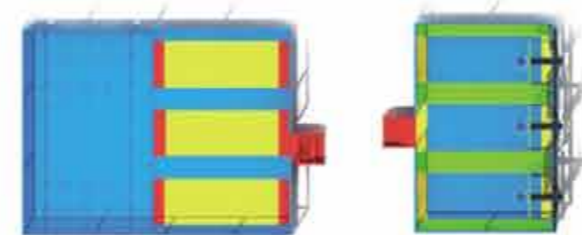

■ 5.LE.B8.510.063.01

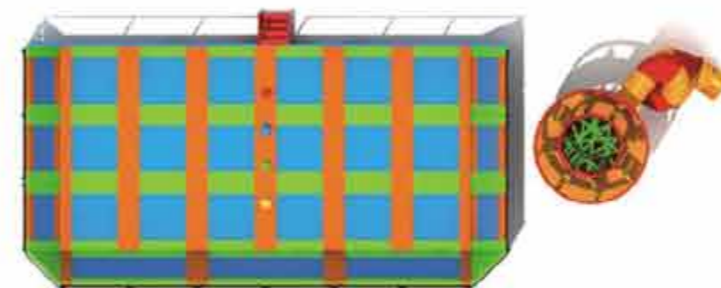

6
Series

Multi-color
111-112

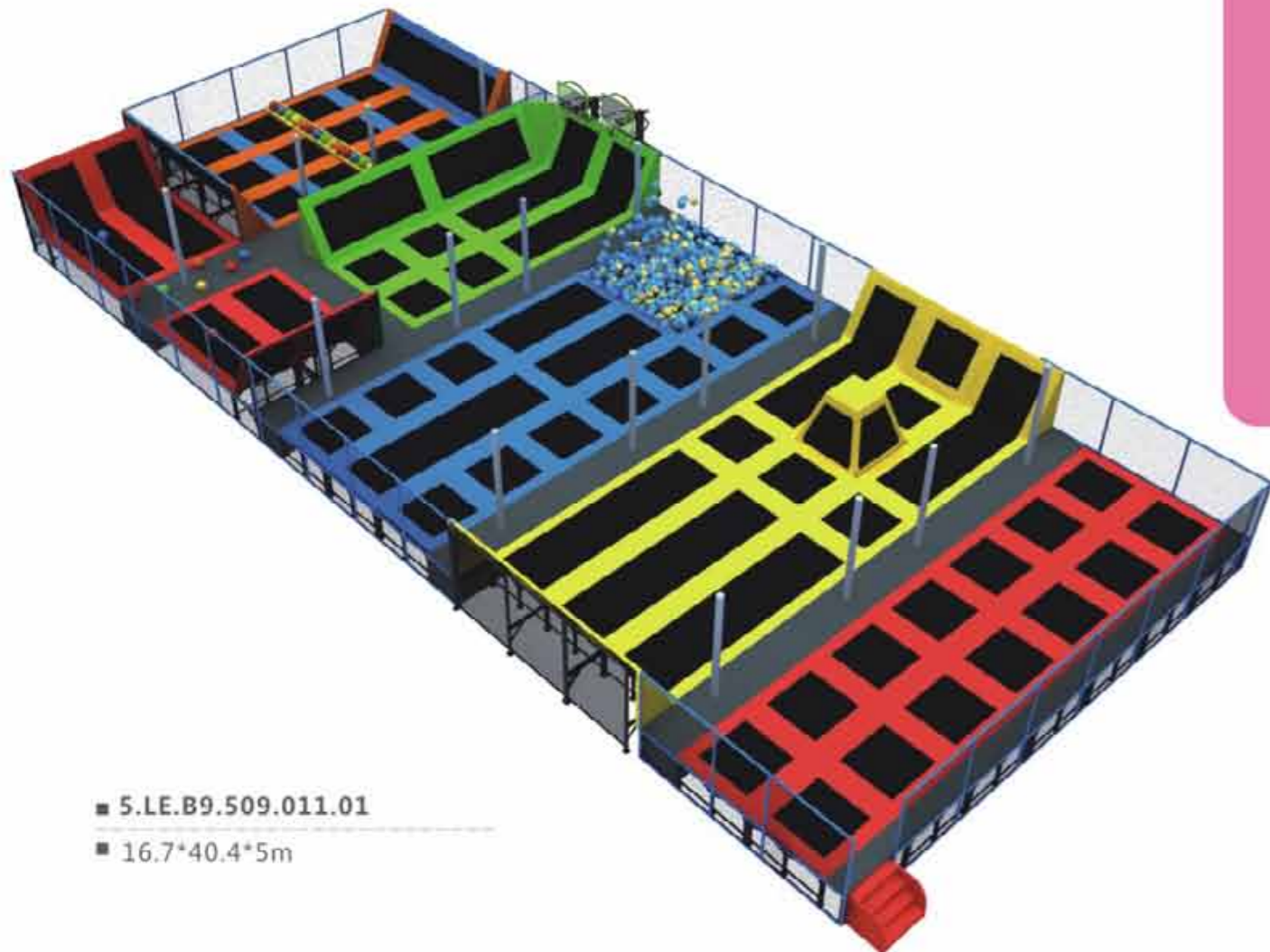

■ 5.LE.B9.509.011.01
 ■ 16.7*40.4*5m

6
 Multi-color
 Series

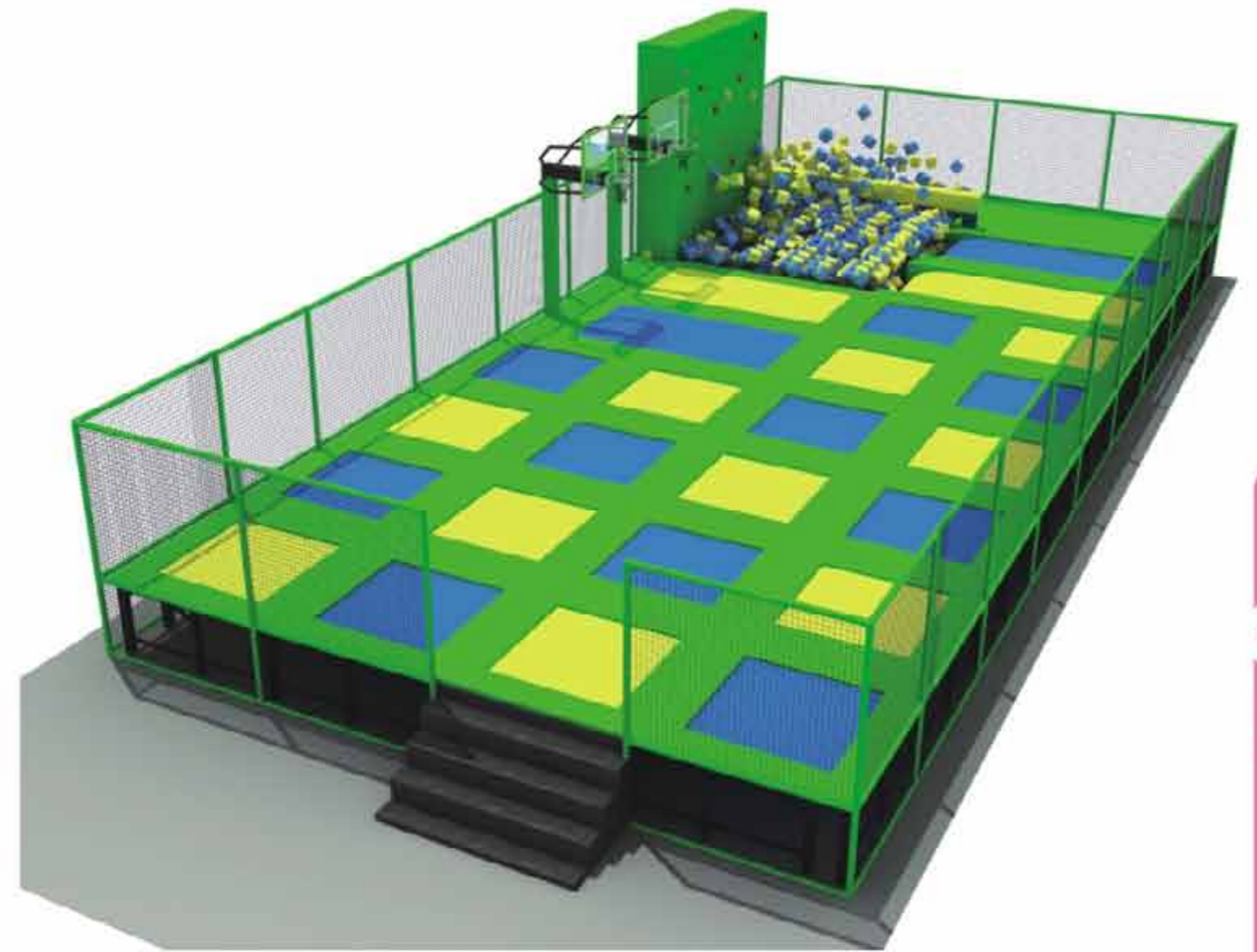

■ 5.LE.B8.603.242.01
 ■ 21.15*9.4*4m

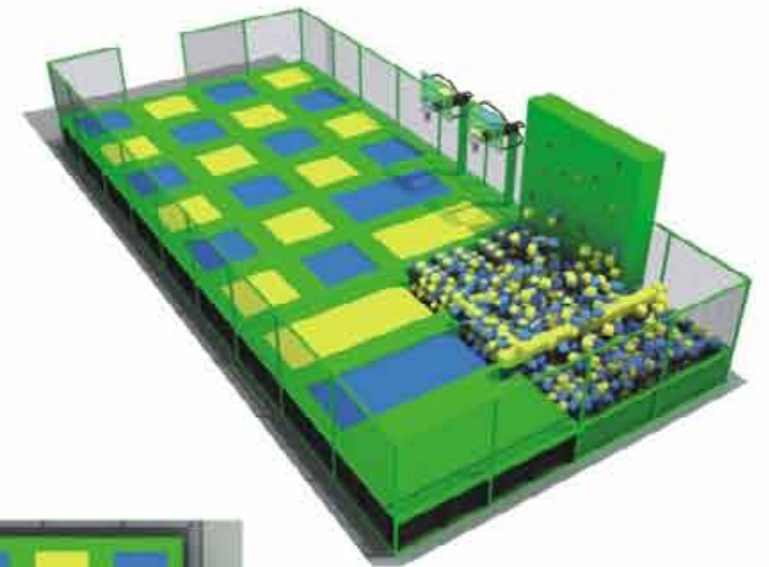

6
 Multi-color
 Series

113-114



■ 5.LE.T2.503.171.23
 ■ 24.7*18.15*5m

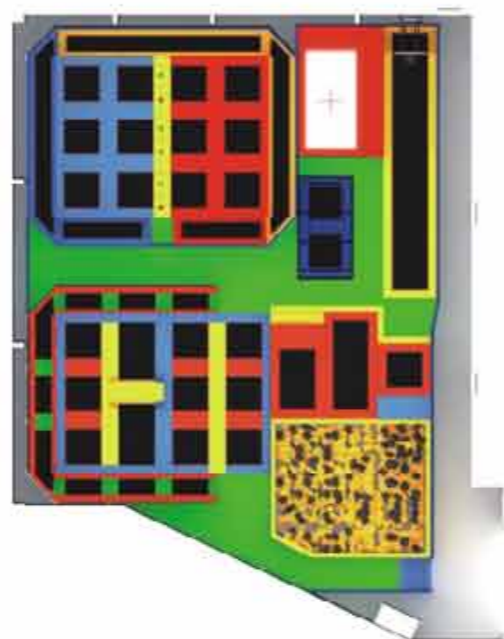

6
 Multi-color
 Series



■ 5.LE.B2.504.241.01
 ■ 16.5*8.25*4.5m



■ 5.LE.B8.511.303.01
 ■ 16.5*14.35*4.2m

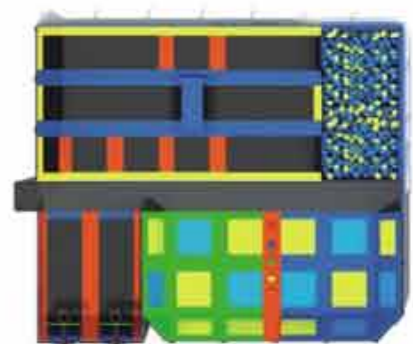

6
 Multi-color
 Series

115-116

7

Children Trampoline Series

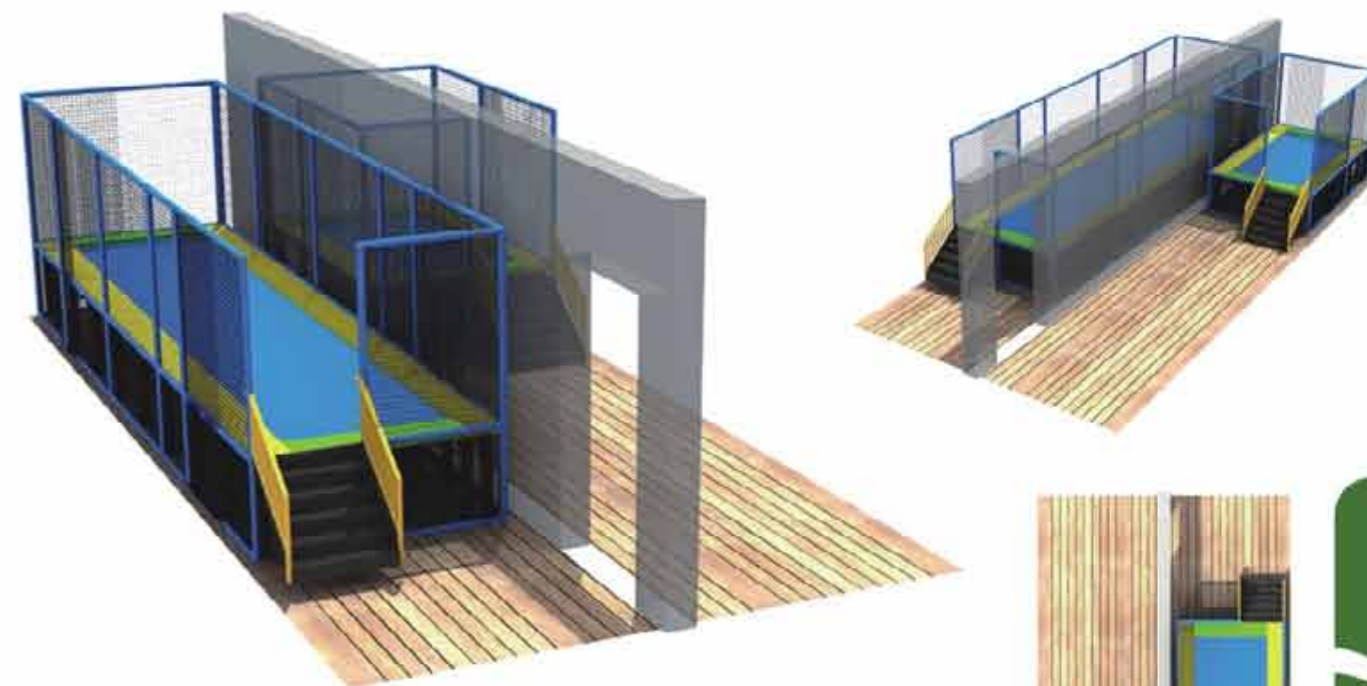

■ 5.LE.B8.510.072.01

■ 2.6*4*3m 2.6*10*3

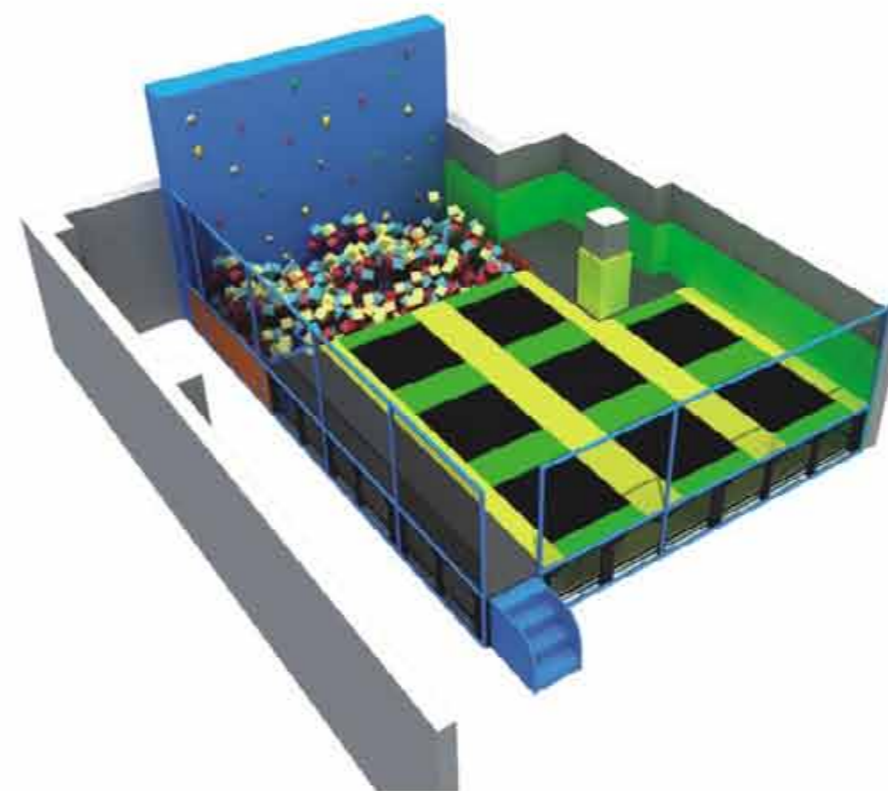

■ 5.LE.B8.512.011.01

■ 11*8.2*4.5m

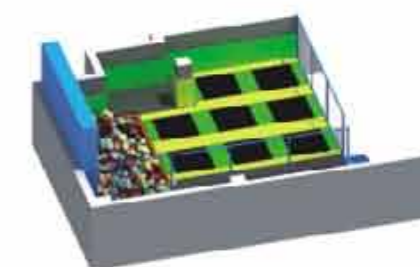
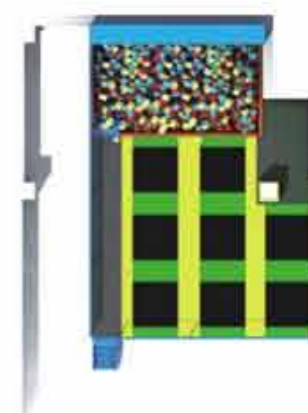



■ 5.LE.B9.505.062.04
 ■ 8.6*20.5*4.5m

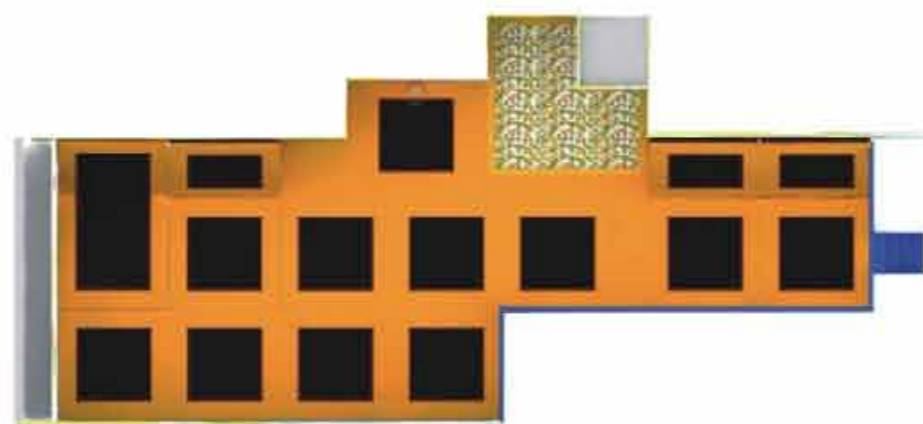

■ 5.LE.B9.512.242.08
 ■ 6.39*13.4*4.5m

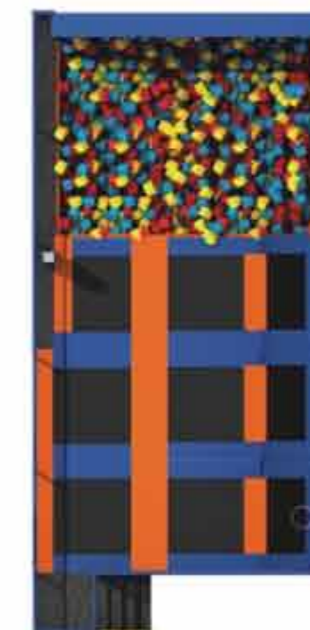

■ 5.LE.B8.509.21.01
 ■ 4.7*5.2*3m



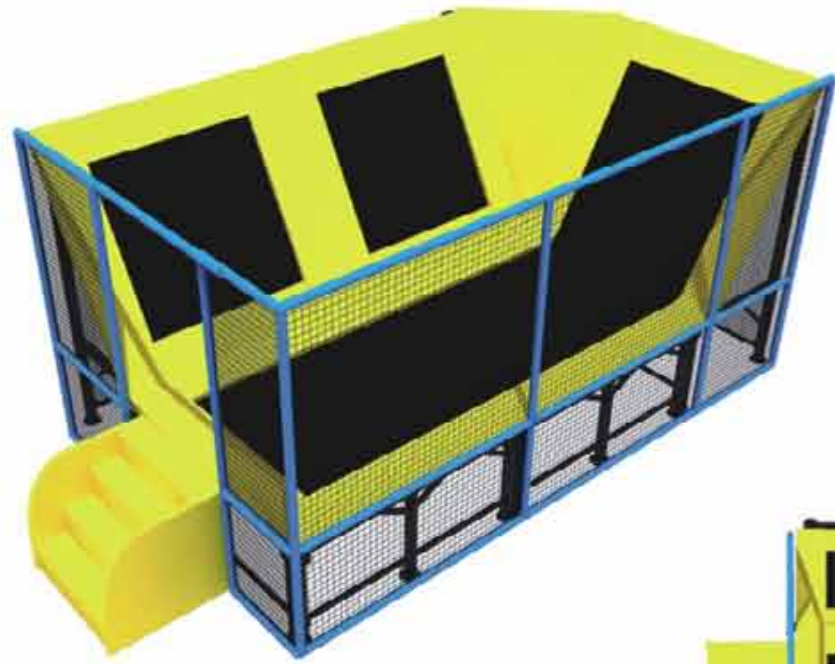

■ 5.LE.B9.509.231.01
 ■ 5.9*3.5*3m

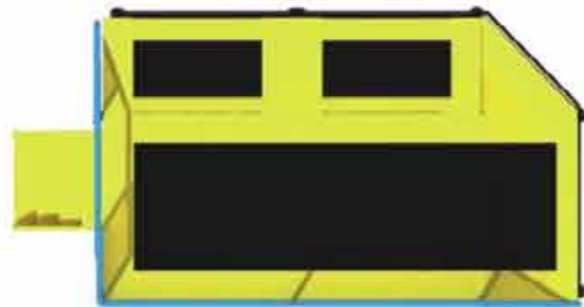

■ 5.LE.B9.504.283.01
 ■ 5.9*9.45*3m

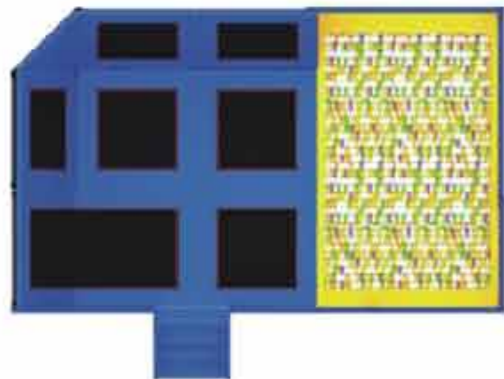

8

Outdoor Trampoline Series





■ 5.LE.B9.509.012.01

■ 32*27.5m

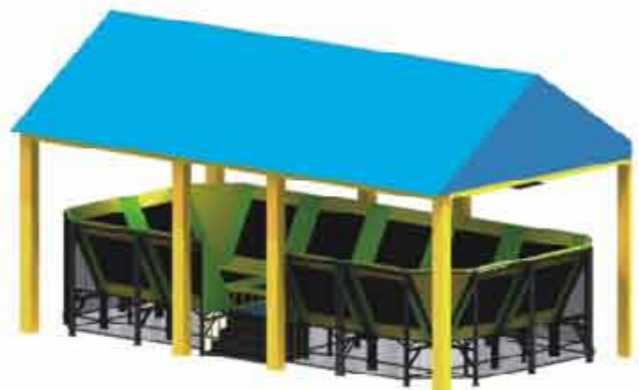
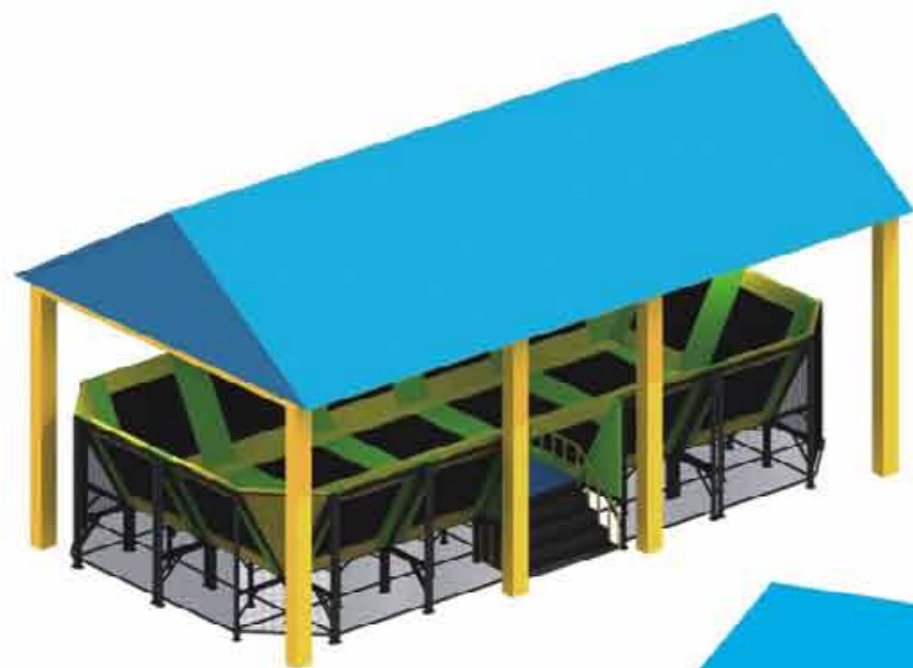

■ 5.LE.B8.510.102.01

■ 14.15*7.1*3m

8

Outdoor
Trampoline
Series

9

Small
Trampoline
Series



9

Small
Trampoline
Series

123-124



■ 5.LE.B9.509.183.01

■ 6.25*3.58*4.47m

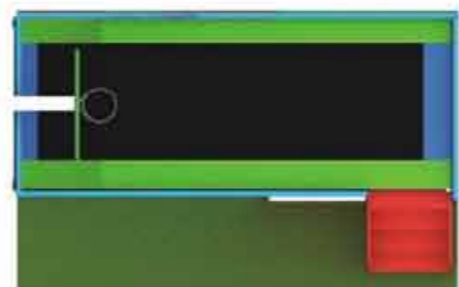

■ 5.LE.B9.510.302.02

■ 23.3*7.1m



9

Small
Trampoline
Series



■ 5.LE.B8.601.041.01

■ 16*12.5*5m

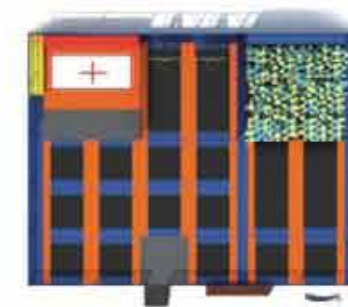

■ 5.LE.B8.509.095.01

■ 14.8*12.4*3m

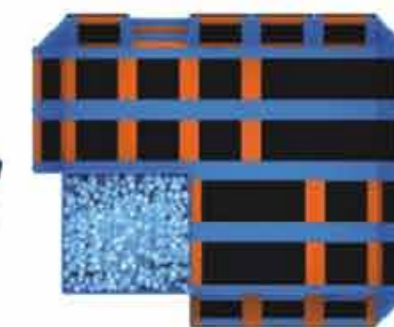

9

Small
Trampoline
Series

125-126

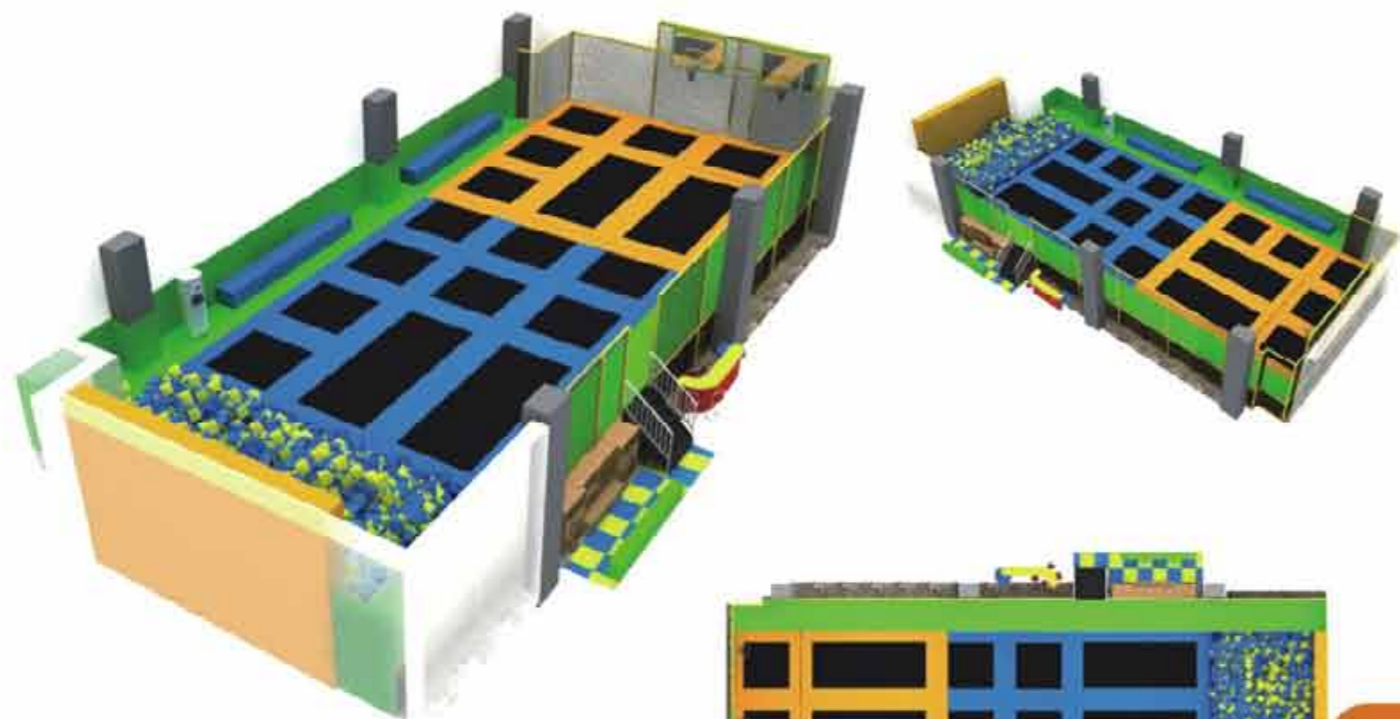

■ 5.LE.B8.509.174.03

■ 20.5*9.25*3.7m

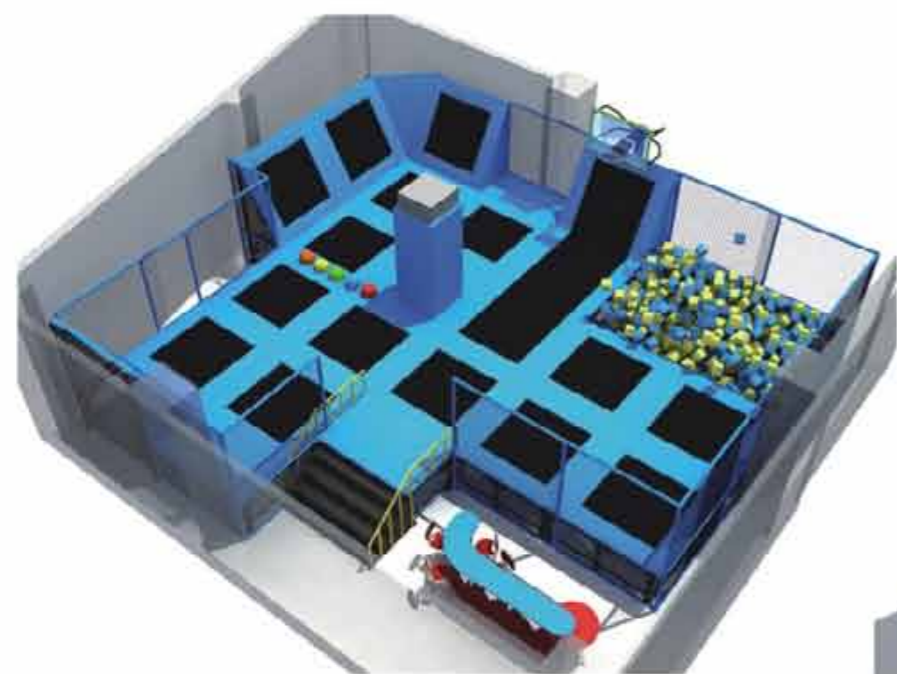

■ 5.LE.B8.510.311.02

■ 12.95*10.6*4.2m

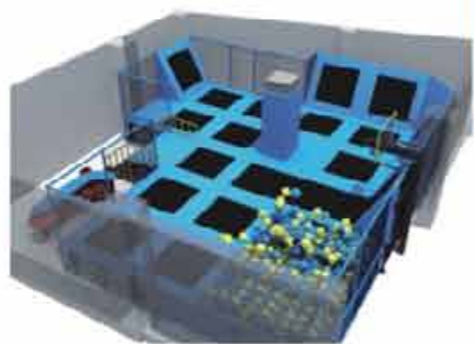

9

Small
Trampoline
Series

10

Medium Sized
Trampoline
Series



10

Medium Sized
Trampoline
Series 127-128



■ 5.LE.B9.601.051.01



■ 5.LE.B8.601.214.01
 ■ 12.5*11*4.8m 12.5*8*4.8m



■ 5.LE.B8.508.262.02
 ■ 19.1*17.7*4.4m



10

Medium Sized
 Trampoline
 Series

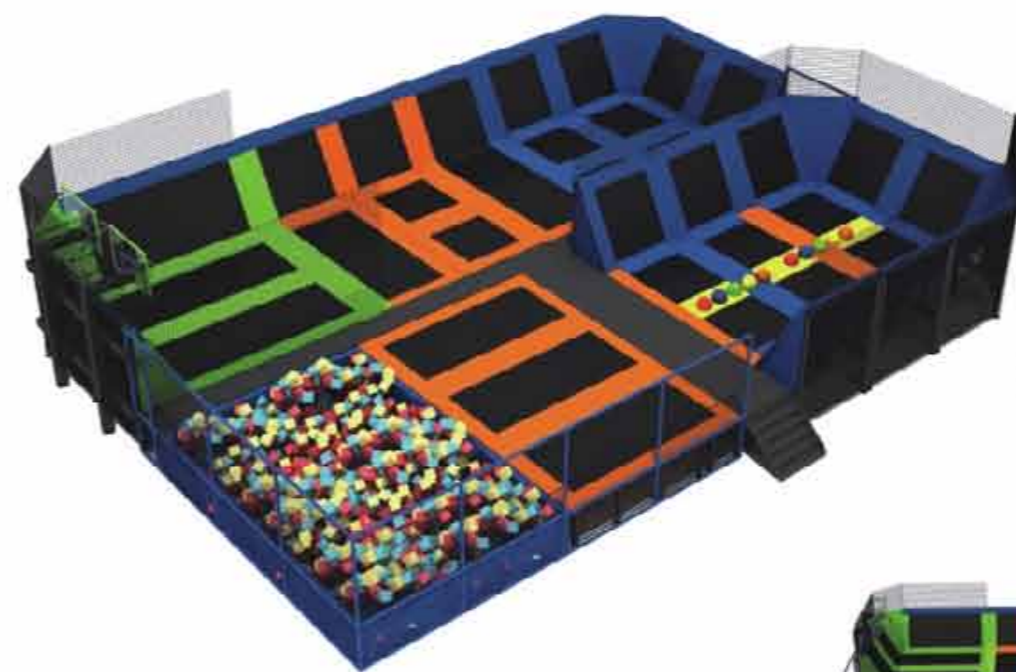

■ 5.LE.B8.601.234.01
 ■ 19*13.8*4.8m

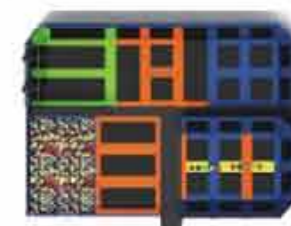

10

Medium Sized
 Trampoline
 Series

129-130

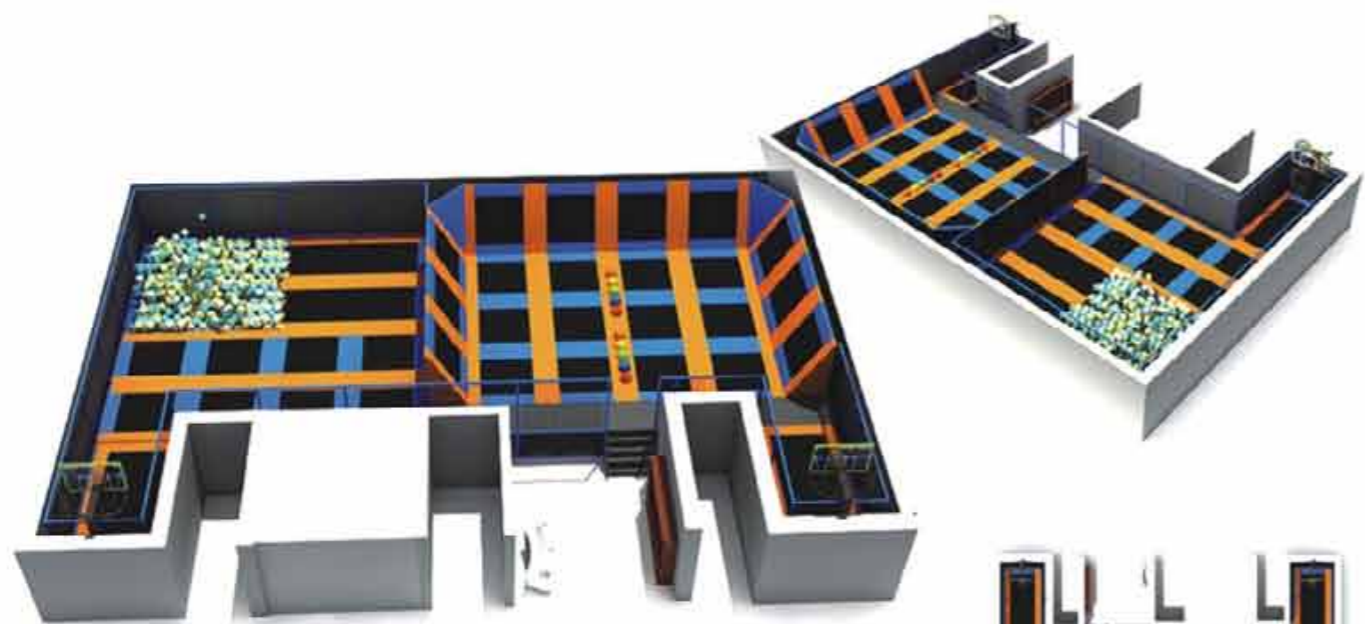

■ 5.LE.B8.512.021.01

■ 21.4*14*4m

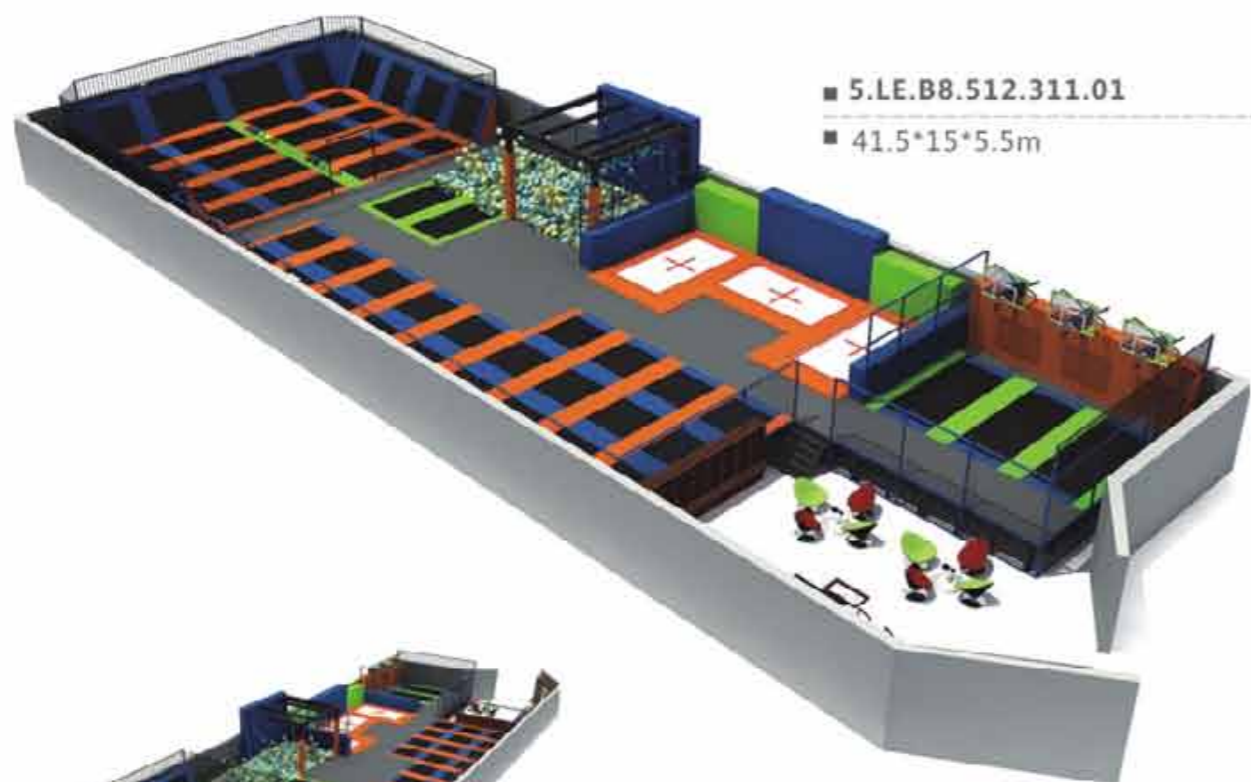

■ 5.LE.B8.512.311.01

■ 41.5*15*5.5m

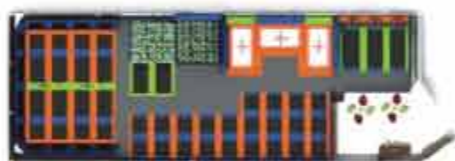
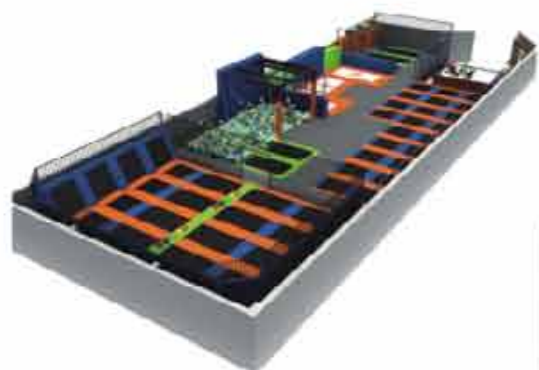

10

Medium Sized
Trampoline
Series

11

Indoor
Playground
Series



11

Indoor
Playground
Series

131-132

Candy Theme



■ 5.LE.T6.505.150.00
 ■ 5.0*4.0*2.8m



■ 5.LE.T1.411.170.00
 ■ 5.0*3.2*3.6m



Indoor
 Playground
 Series

Castle Theme



■ 5.LE.T9.506.061.05
 ■ 22.1*7.4*5m



■ 5.LE.T6.509.081.01
 ■ 14*12.5*4.8m

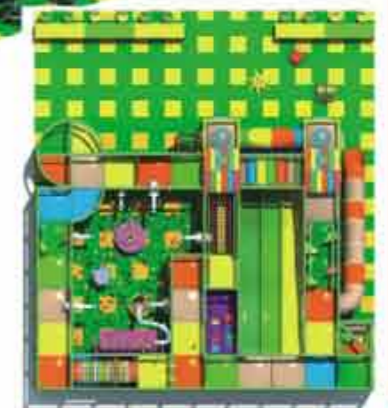

Indoor
 Playground
 Series

133-134

Customized Theme



■ 5.LE.T6.503.201.01
■ 30.0*16.0*5.2m



■ 5.LE.T6.509.220.00
■ 15*12.3*5.6



Indoor
Playground
Series

Forest Theme



■ 5.LE.T5.309.140.00
■ 13*10*4.5m



■ 5.LE.T6.501.200.05
■ 8.4*4.96*3.8m



Indoor
Playground
Series

135-136

Ocean Theme



- 5.LE.BY.080.00
- 15*11*2.8m



- 5.LE.BY.081.00
- 15*6*4.8m

11

Indoor
Playground
Series

12

Indoor Ropes
Course
Series



12

Indoor Ropes
Course
Series

137-138

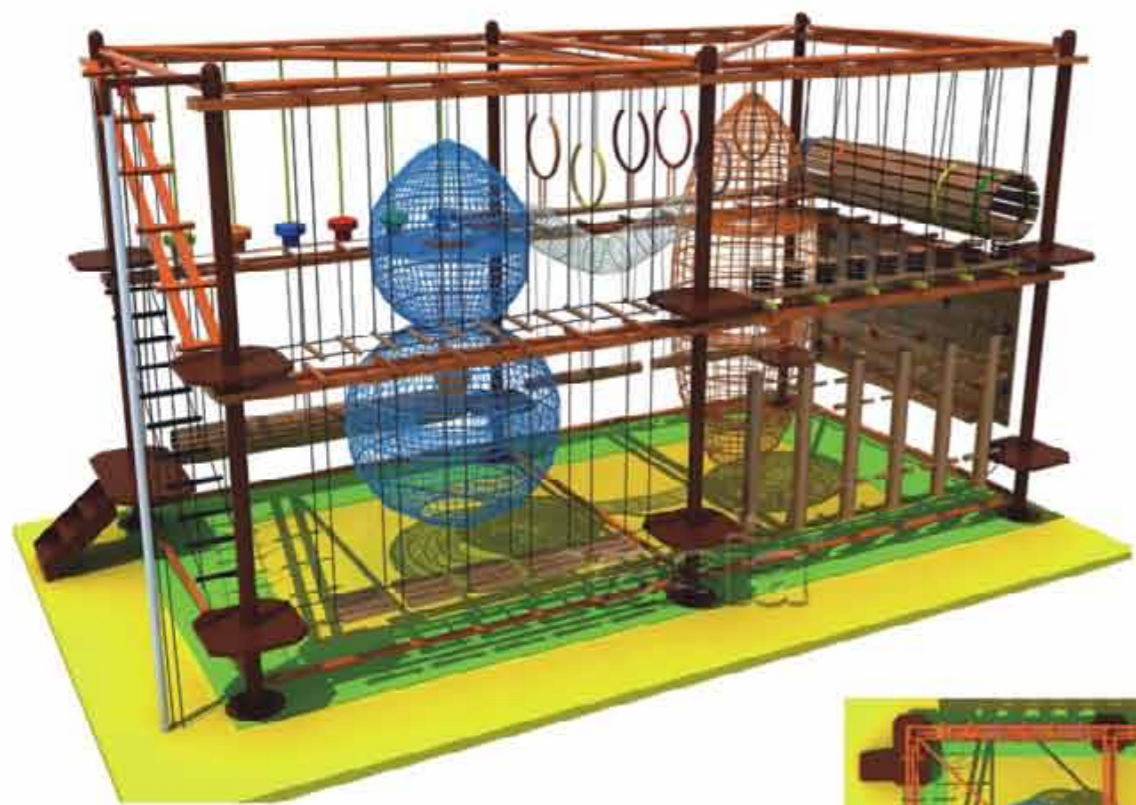

■ 5.LE.X1.506.121.00
 ■ 8.7*4.4*5.3m

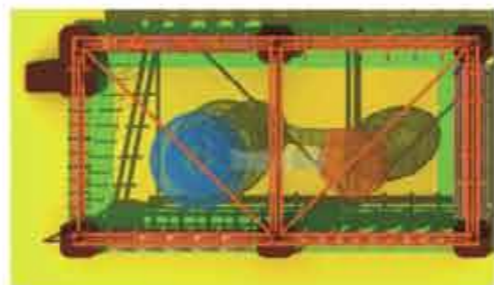

■ 5.LE.X5.603.323.01A
 ■ 10.73*57.58*7.3m

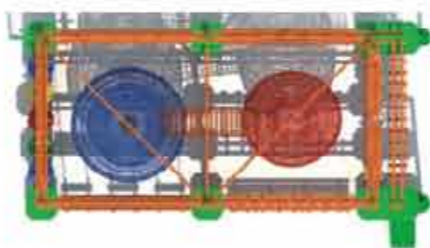

12

Indoor Ropes
 Course
 Series

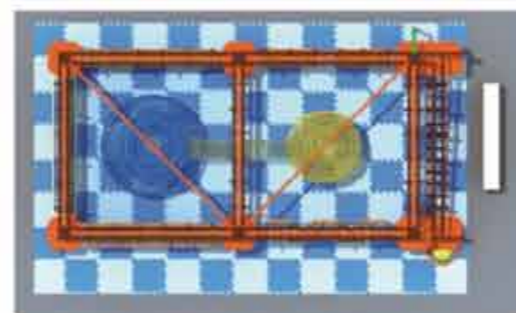

■ LE.TZ.013
 ■ 9.3*5.8*4.5m



12

Indoor Ropes
 Course
 Series

139-140